

trees to be removed shown dotted
(refer to Arboncultural Impact assessment and
Method Statement dated November 2014)

existing 1.9m high close boarded fence to be
removed & replaced with 1.2m high post & rail
fence and native species hedgerow

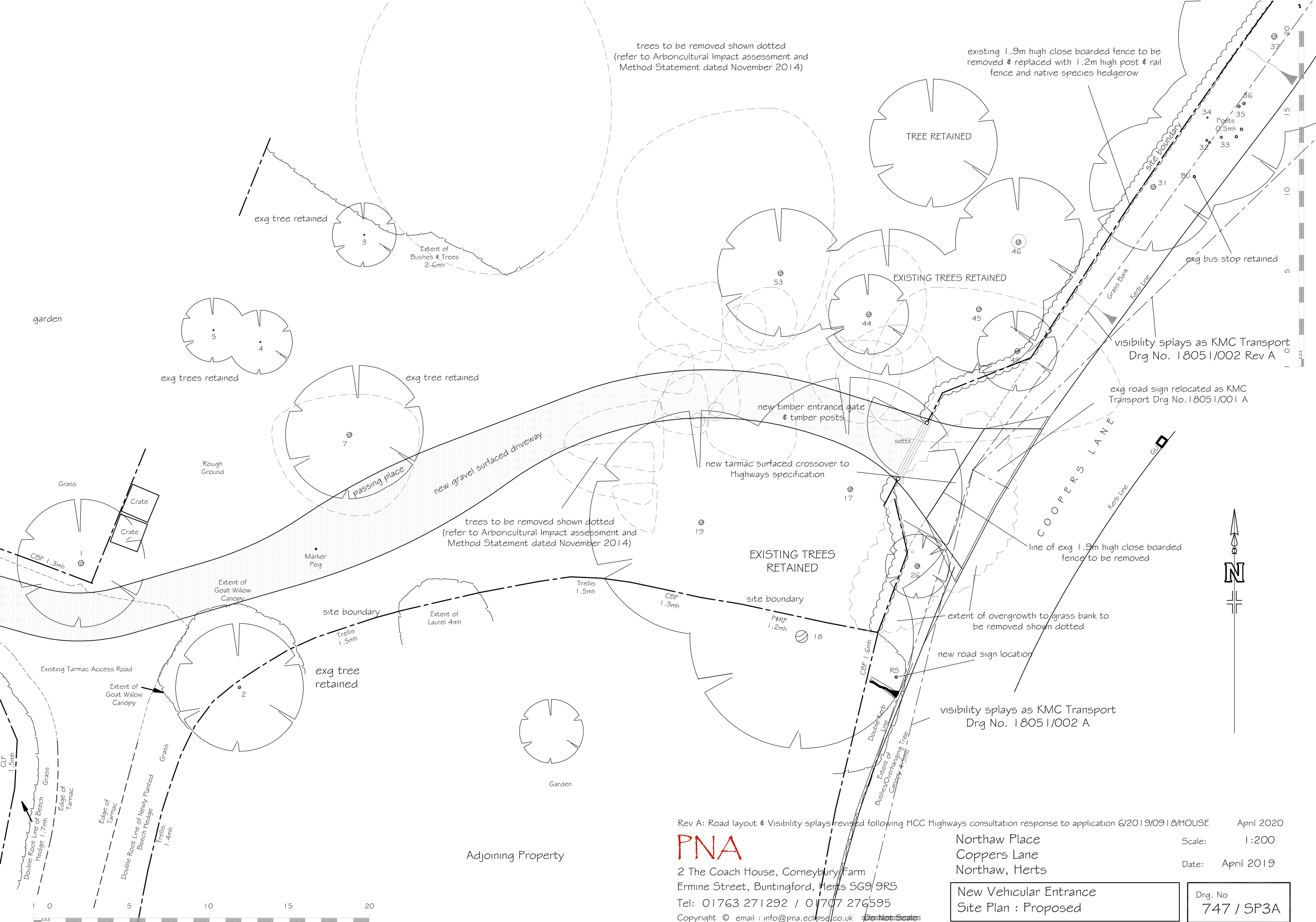

garden

exg tree retained

exg trees retained

Extent of
Bushes & Trees
2-6mh

Rough
Ground

exg tree retained

new gravel surfaced driveway

new timber entrance gate
& timber posts

new tarmac surfaced crossover to
Highways specification

trees to be removed shown dotted
(refer to Arboncultural Impact assessment and
Method Statement dated November 2014)

EXISTING TREES
RETAINED

visibility splays as KMC Transport
Drg No. 18051/002 Rev A

exg road sign relocated as KMC
Transport Drg No. 18051/001 A

COOPERS LANE

line of exg 1.9m high close boarded
fence to be removed

extent of overgrowth to grass bank to
be removed shown dotted

new road sign location

visibility splays as KMC Transport
Drg No. 18051/002 A

Existing Tarmac Access Road

exg tree
retained

Extent of
Laurel 4mh

Garden

Adjoining Property

Rev A: Road layout & Visibility splays revised following HCC Highways consultation response to application G/2019/0918/HOUSE April 2020

PNA
2 The Coach House, Corneybury Farm
Ermine Street, Buntingford, Herts SG9 9RS
Tel: 01763 271292 / 01707 276595
Copyright © email: info@pna.edpsa.co.uk Do Not Scale

Northaw Place
Coppers Lane
Northaw, Herts

Scale: 1:200

Date: April 2019

New Vehicular Entrance
Site Plan : Proposed

Drg. No
747 / SP3A

