

Standard Instructions

A: All dimensions to be verified on site & any discrepancies on the drawings or divergence between drawings to be immediately reported to the Project Manager before putting the work concerned in hand, fabricating the work or preparing shop drawings.
 B: Work to figured dimensions only (except where full size details are provided).
 C: Do not vary any work shown on the drawings without obtaining prior approval from the project Manager or Designer.
 D: Any additional information required should be requested from the Project Manager or Designer before commencement of work on site.

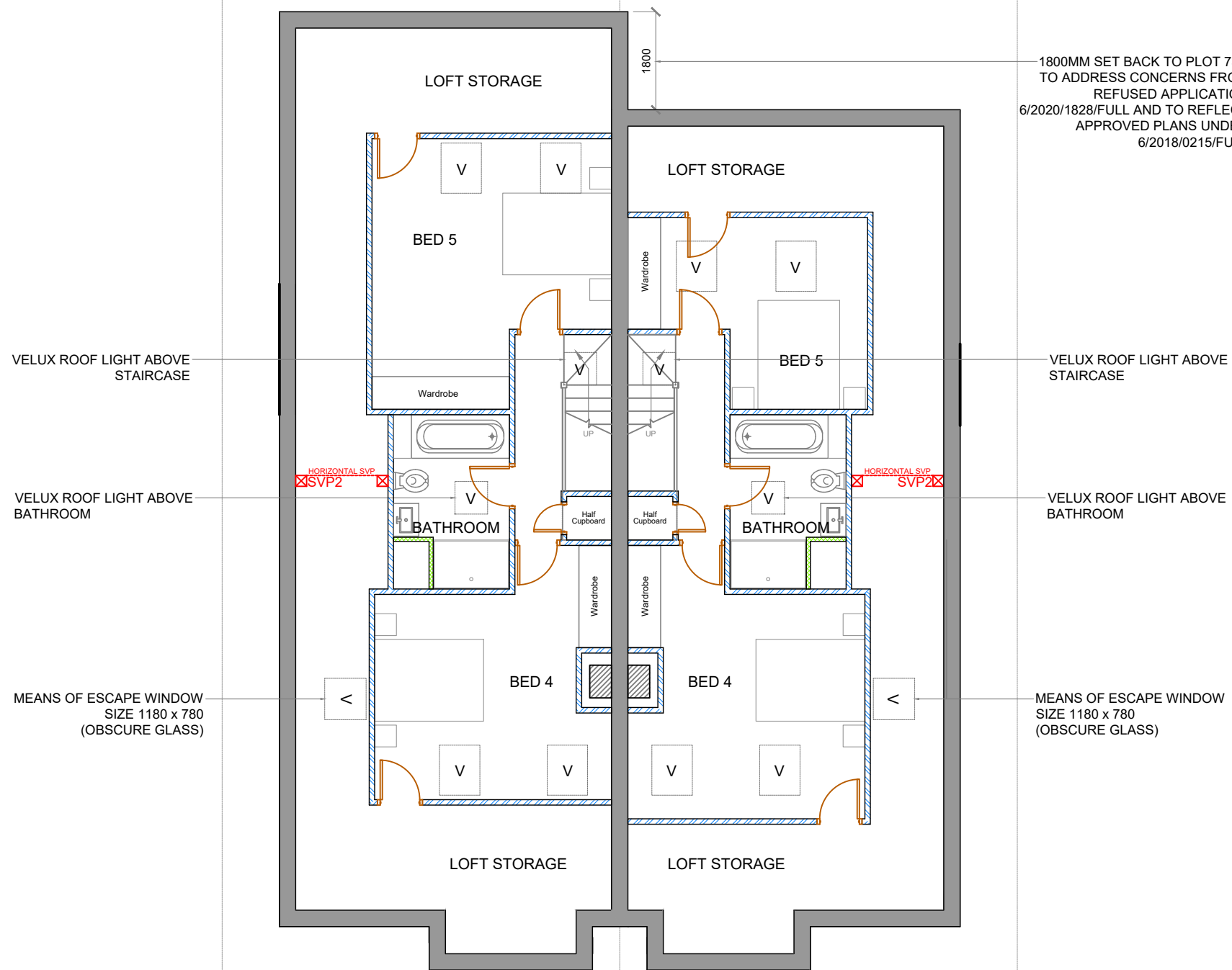

1800MM SET BACK TO PLOT 73a
 TO ADDRESS CONCERNS FROM
 REFUSED APPLICATION
 6/2020/1828/FULL AND TO REFLECT
 APPROVED PLANS UNDER
 6/2018/0215/FULL

SECOND FLOOR - PLOT 73
 INTERNAL FLOOR AREA OF EACH PLOT
 = 52m² (559 sq ft)

SECOND FLOOR - PLOT 73a
 INTERNAL FLOOR AREA OF EACH PLOT
 = 47m² (505 sq ft)

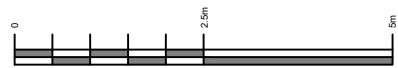

Revision	Description	Date	By
F	Update Notes	20.10.20	SD
E	Plot 73a, Updated Layout Remove 1.8m	09.10.20	SD
D	SVP Positioning Updated	26.11.19	SD
C	Update Velux Locations	18.01.19	SD
B	Add Roof Lights	21.01.18	SD
A	Update Floor Area and Layout to Accommodate New Roof Design	16.12.17	SD



Project Address:
73_PINE_GROVE
BROOKMANS_PARK
AL97BL

Drawing Title:
PROPOSED_2ND_FLOOR_PLANS

Drawing Scale: 1:100@A3	Drawn By: JD/SD	Date Created: 25.02.17
-----------------------------------	---------------------------	----------------------------------

Drawing Number 73PG-06	Revision F
----------------------------------	----------------------