

**SITE PLAN**  
Not to scale

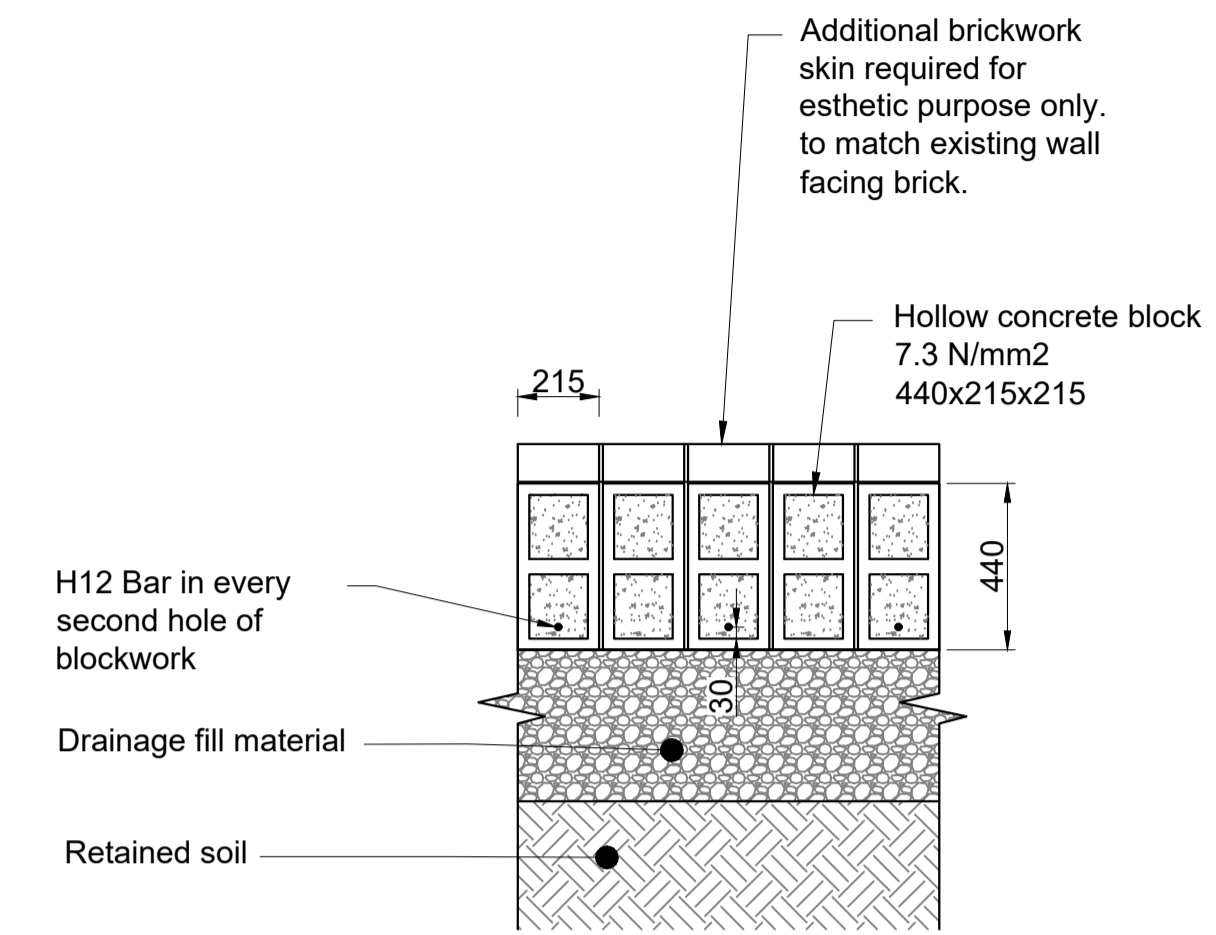

**TYPICAL RETAINING WALL PLAN VIEW**  
Scale 1:20

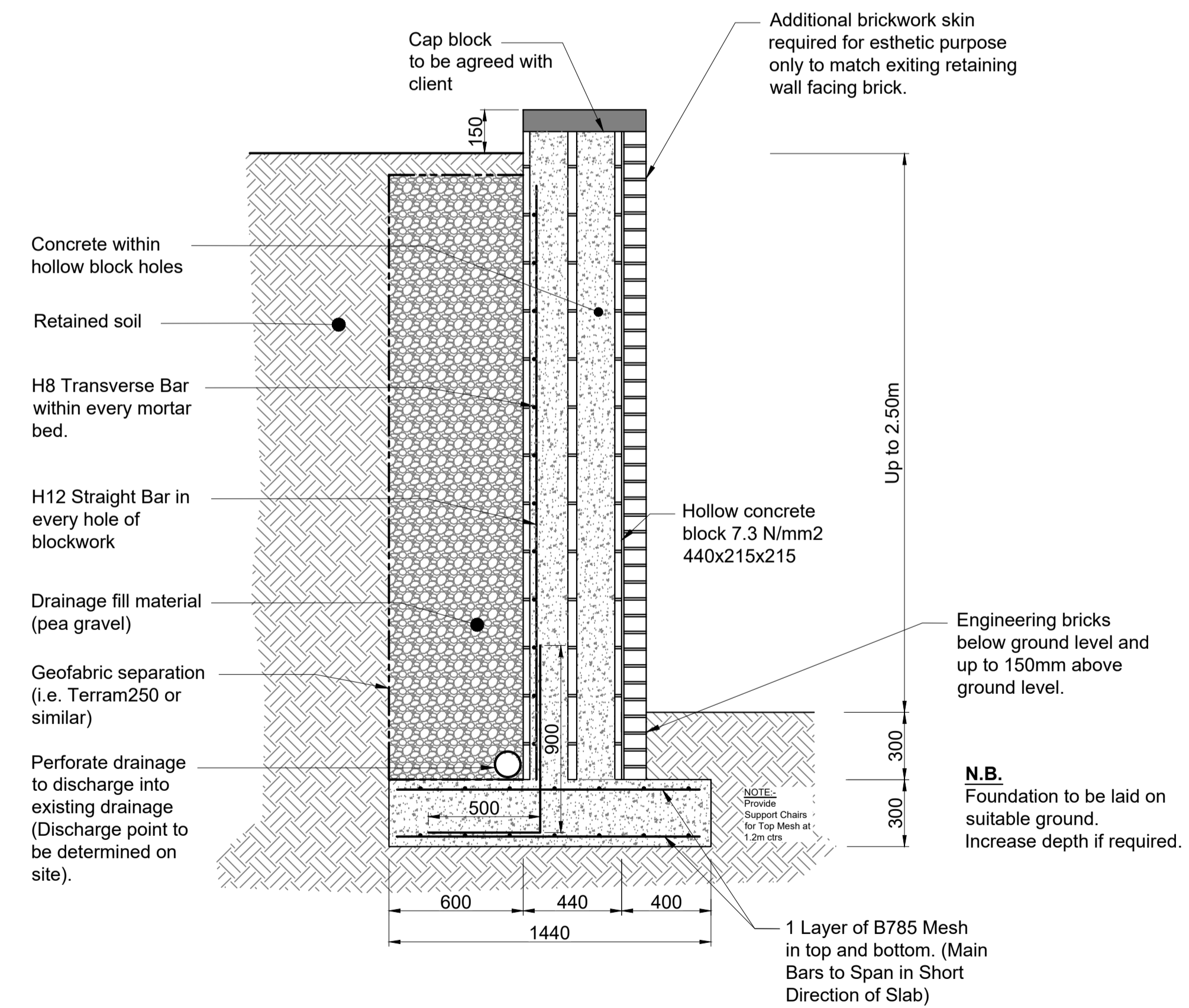

**SECTION THROUGH RETAINING WALL**  
Scale 1:20

CDM Regulations:  
The reader is notified that CDM regulations may apply to the contract, and that appropriate Health & Safety Risk Assessments and Method Statements will be needed to comply with the Regulations where applicable.

It is the Client's responsibility to make suitable arrangements for managing their project, enabling those carrying it out to manage health and safety risks in a proportionate way.

It is the Client's responsibility in appointing (IN WRITING) as soon as possible, appropriately experienced Contractors and Designers to the project (including the Principal Designer and Principal Contractor) to carry out tasks as required under the Contract. Further guidance on CDM Regulations can be obtained from the Health & Safety Executives website: [www.hse.gov.uk/cis41.pdf](http://www.hse.gov.uk/cis41.pdf).

**GENERAL NOTES**

1. Do not scale dimensions off this drawing.
2. All dimensions to be in millimetres unless otherwise stated.
3. Any Discrepancy between dimensions on this drawing are to be referred to the Engineer immediately.
4. Contractor to check dimensions on site, prior to commencement.
5. Concrete to be Grade C40
6. Minimum cover to reinforcement to be 50mm.
7. Minimum lap to reinforcement to be 40 x dia. of bar.
8. Minimum lap to mesh to be 400mm.

A	20/07/22	Minor amendments. Notes added. Client name changed	By:
Rev:	Date:	Comments:	By:



ASP Consulting (Melbourne) Ltd  
Point One, Tournament Way  
Ashby-de-la-Zouch, LE65 2UU  
+44 (0) 1530 561230  
[info@aspconsulting.co.uk](mailto:info@aspconsulting.co.uk) [aspconsulting.co.uk](http://aspconsulting.co.uk)

Client:  
**AMBIENT SUPPORT**

Project:  
**ST. AUDREYS, HATFIELD RETAINING WALL**

Title:  
**RETAINING WALL LAYOUT & DETAILS**

Drawn By: GB	Sheet Size: A1	Status: As Built For Construction	Date: 12.07.22
Checked By: SJP	Scale: AS SHOWN	Revision: A	Drawing No: 6787-01

This drawing contains confidential information of ASP Consulting (Melbourne) Ltd. ("the Company") and the copyright, design right and/or other intellectual property rights in the drawing belong to the Company. All rights conferred by the law and by virtue of international copyright and other conventions are reserved to the company. This drawing and the information contained therein or any part thereof must not be reproduced, disclosed or used for purposes other than those for which prior written consent of the Company has been given.