

PLANNING FILES

COMET WAY, HATFIELD.

S6/161/89

6/7

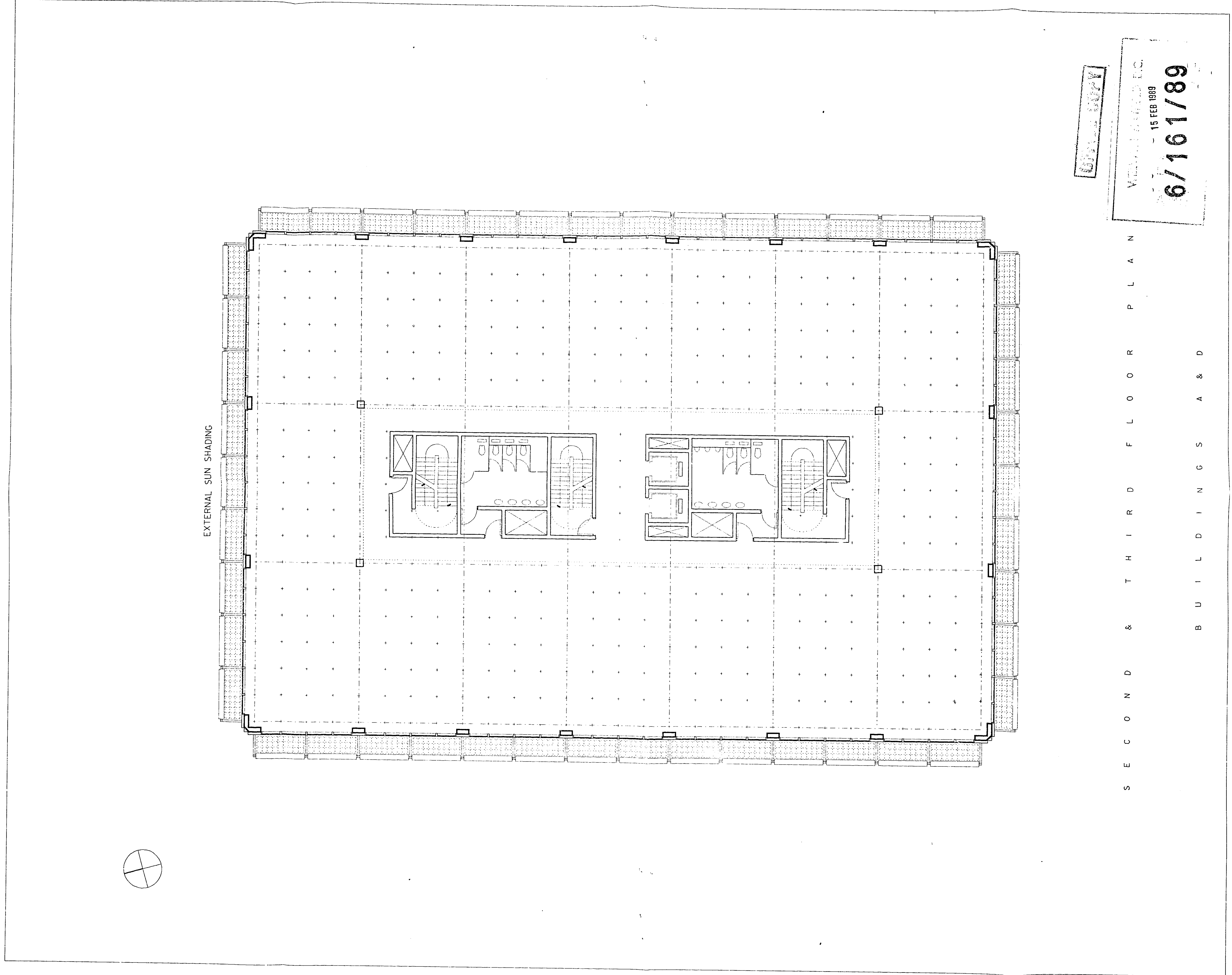

COPY 10/27

MELVIN HATFIELD, INC.
 15 FEB 1989
 6/161/89

S E C O N D & T H I R D F L O O R P L A N
 B U I L D I N G S A & D

MELVIN HATFIELD, INC.
 15 FEB 1989
 6/161/89

C O M M E T D E V E L O P M E N T
 B Y R M
 A R C H I T E C T S I N D P L A N N E R S
 F E B R U A R Y I 9 8 9

1:100

P006
06/02/89

23 22 ▲A1 20 19. 18 17 16 ▲A2 14 13 12 11 ▲A3 9 8 ▲A4 ▲ 0 1 2 3 4 5 6 7 8 9 10 11 ▲A3 12 13 14 A2▲ 16 17 18 19 20 A1▲ 22 23

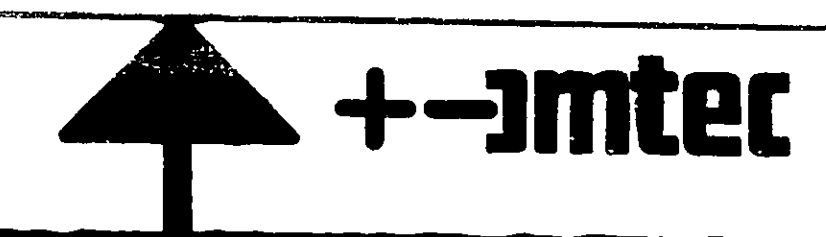

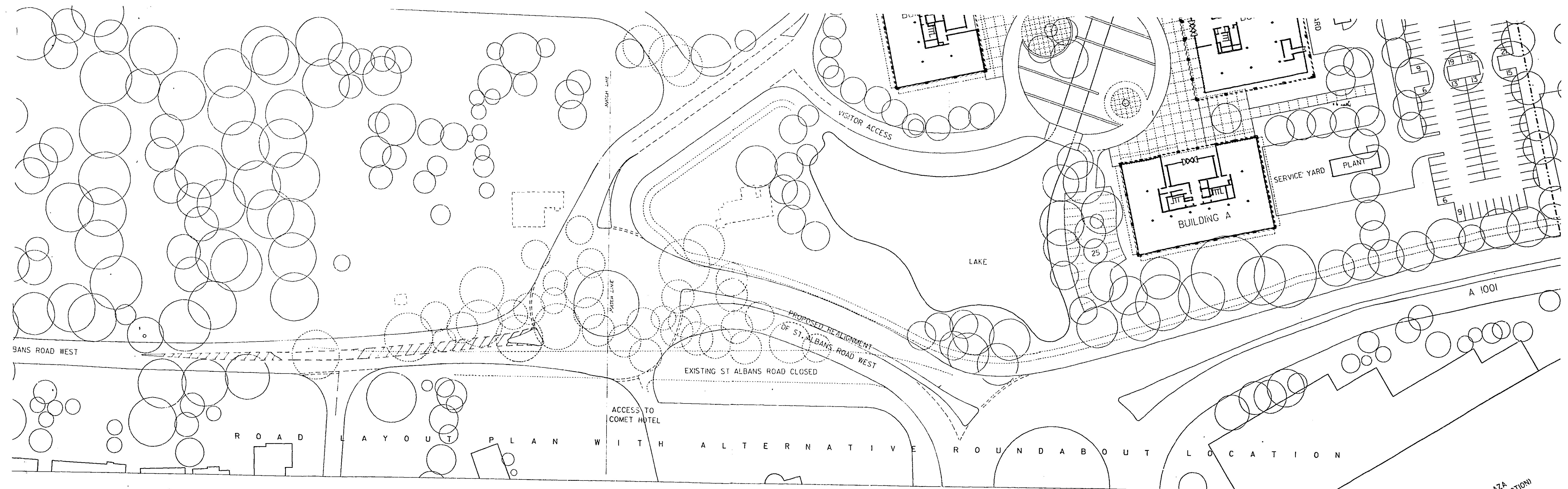

ROAD LAYOUT PLAN WITH ALTERNATIVE ROUNDABOUT LOCATION

COMET DEVELOPMENT

B
A
E
Y
R
M

1:500 ARCHITECTS AND PLANNERS P 105
25.04.89

APRIL 1989
PART PLAN
P103 REVISION A.

25.04.89

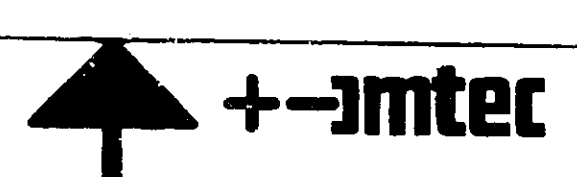



LOCATION PLAN

AMENDMENT

WELWYN HARTFIELD, D.C.
 RECEIVED 21 APR 1988
 56/161/09

COMET DEVELOPMENT
 B A E
 Y R M
 ARCHITECTS AND PLANNERS
 APRIL 1989

N250

WELWYN HARTFIELD, D.C.
 RECEIVED 26 MAR 1989

PG# 28.0481

▲A0 29 28 27 26 25 24 23 22 ▲A1 20 19 18 17 16 ▲A2 14 13 12 11 ▲A3 9 8 ▲A4 A4 ▲ 8 9 A3 ▲ 11 12 13 14 A2 ▲ 16 17 18 19 20 A1 ▲ 22 23 24 25 26 27 28 29 A0 ▲



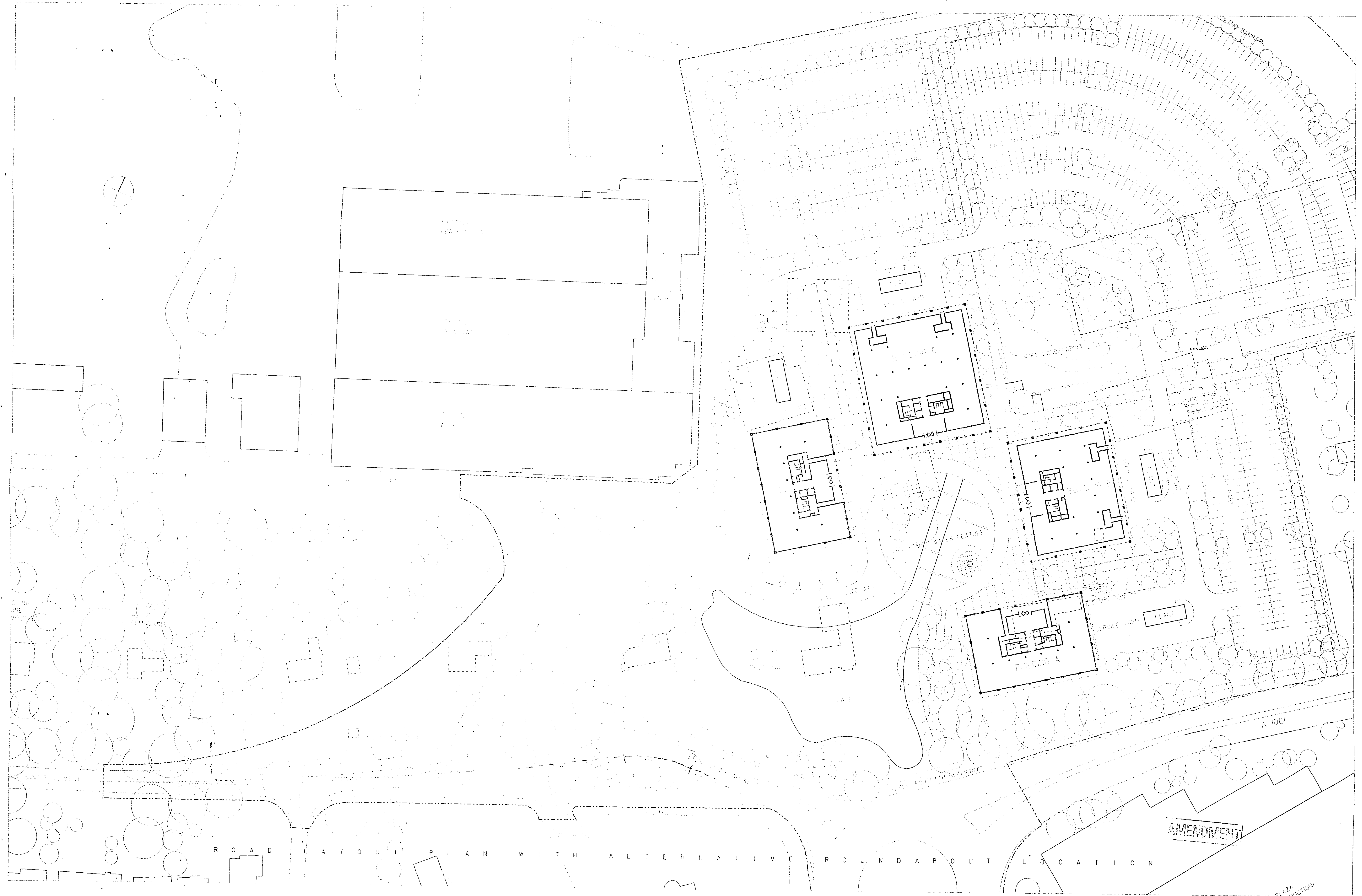

COMET DEVELOPMENT
 D A E
 Y R M
 ARCHITECTS AND PLANNERS
 APRIL 1989

WELWYN HATFIELD D.C.
 RECEIVED
 6/161/89

P 1528
 26.0489

WELWYN HATFIELD D.C.
 RECEIVED



COMET DEVELOPMENT

B A M
Y R E

WELSHMAN LTD DC
15 FEB 1989
6/161/89
26 MAY 1989

15 FEB 1989
6/161/89
PLAZA SECTION