

PLANNING FILES

SHEPHERDS WAY, BROOKMANS

DADY

S6/921/88

2/2

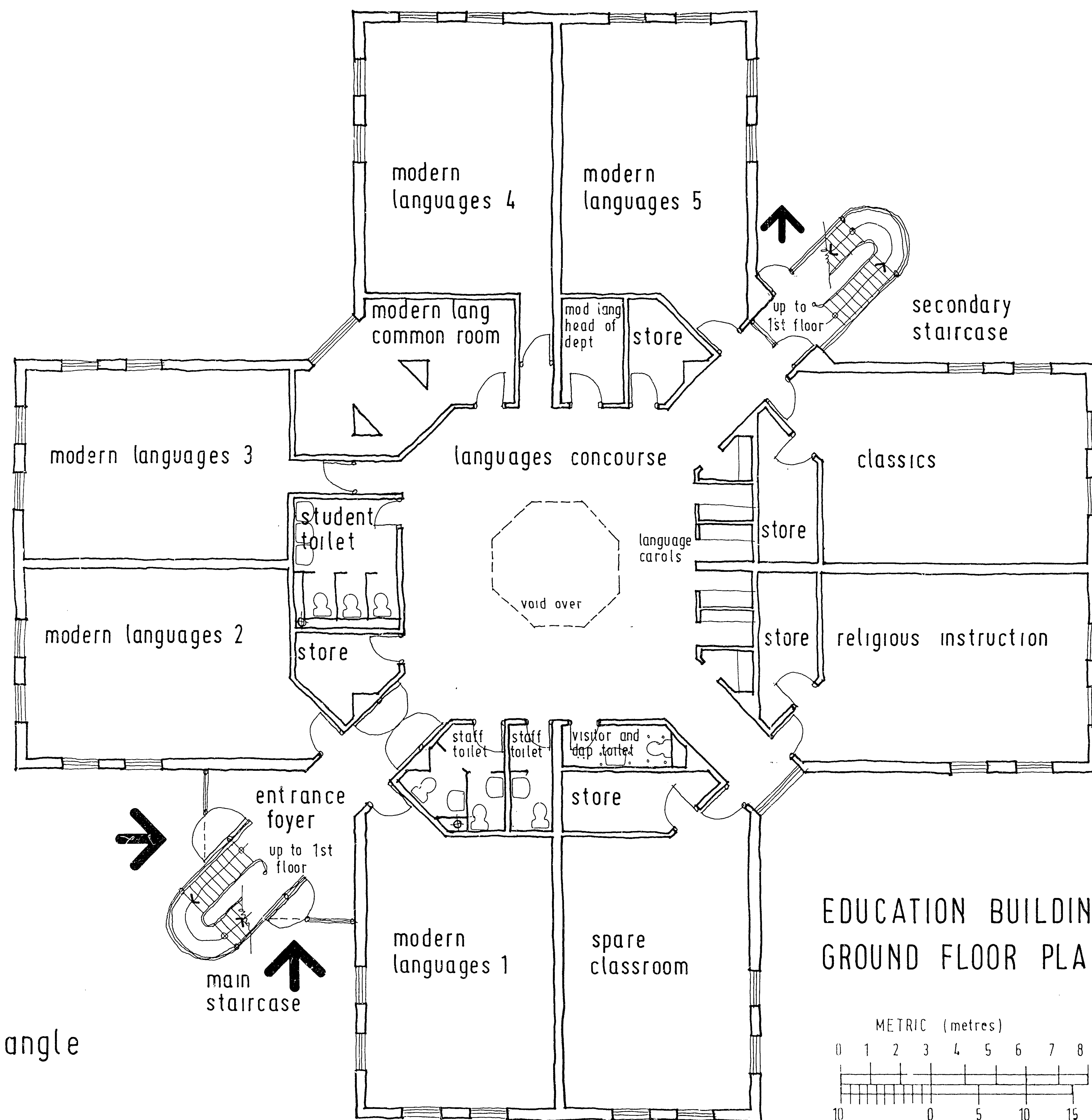

quadrangle

EDUCATION BUILDING
GROUND FLOOR PLAN

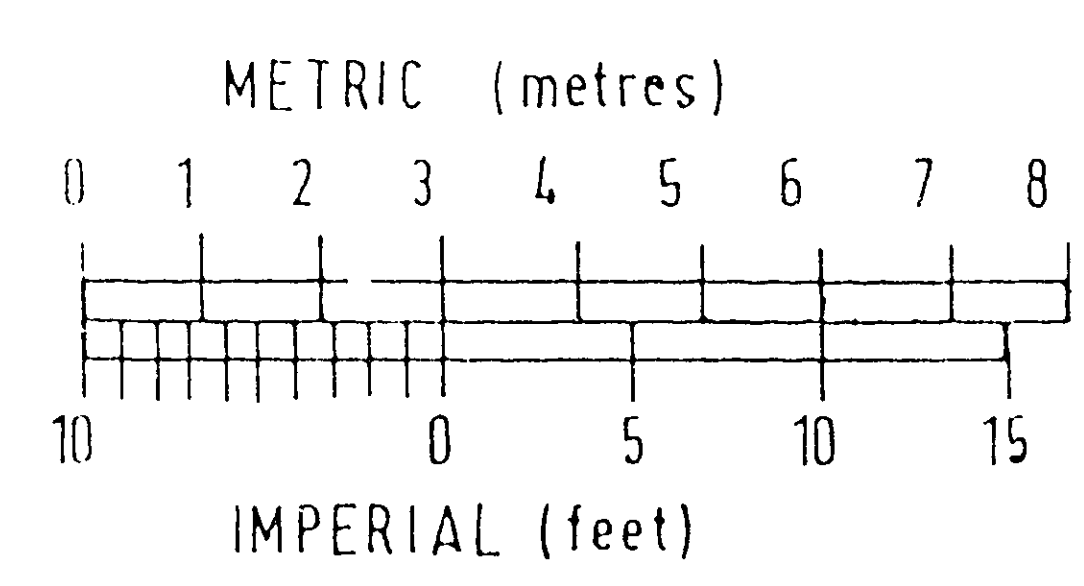

HERTFORDSHIRE DEVELOPMENTS LTD.
5 SEP 1988
56/921/88

HERTFORDSHIRE DEVELOPMENTS LTD.
5, PORT HILL
HERTFORD, HERTFORDSHIRE
22 NOV 1988

 HERTFORDSHIRE DEVELOPMENTS LTD. 5, Port Hill Hertford Hertfordshire	
Queenswood DESIGN TEAM:	
Architect	Roger Carter Architects
Consultant	Robert Fawcett RIBA
Structural Engineer	Dr. Gareth Johnson PhD CEng MStructE
EDUCATION BUILDING Ground Floor Plan	
Date: AUGUST 1988	Drawing No:
Scale: 1:100	670/20

A2 A3 A4 A4 0 1 2 3 4 5 6 7 8 9 10 11 12 13 14 15 16 A4 A4 A3 A2