

PLANNING FILES

LAND OFF. LEMS福德 RD.

S6/616/88

OVER A1 (M) HATFIELD

3/4

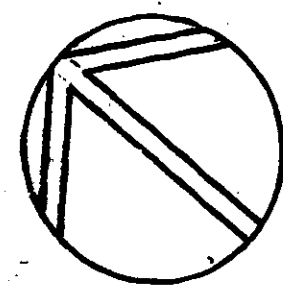

KEY

- 450 MM BRICK RETAINING WALL
- TIMBER EDGING
- GRAVEL
- RED BITUMEN
- BLACK BITUMEN
- CONCRETE BLOCK PAVING
- BRICK TRIM
- 200 MM BRICK RETAINING WALL
- 400 MM BRICK RETAINING WALL
- 200 MM GRASS PAVING
- PEDESTRIAN DETERENT PAVING BLOCKS
- 850 MM STEEL POST FENCE
- 1.8M TRELLIS FENCE
- 1.8M TIMBER PALE FENCE
- CONCRETE PLANTER BOXES
- KEY KERB
- POLYCHANNEL

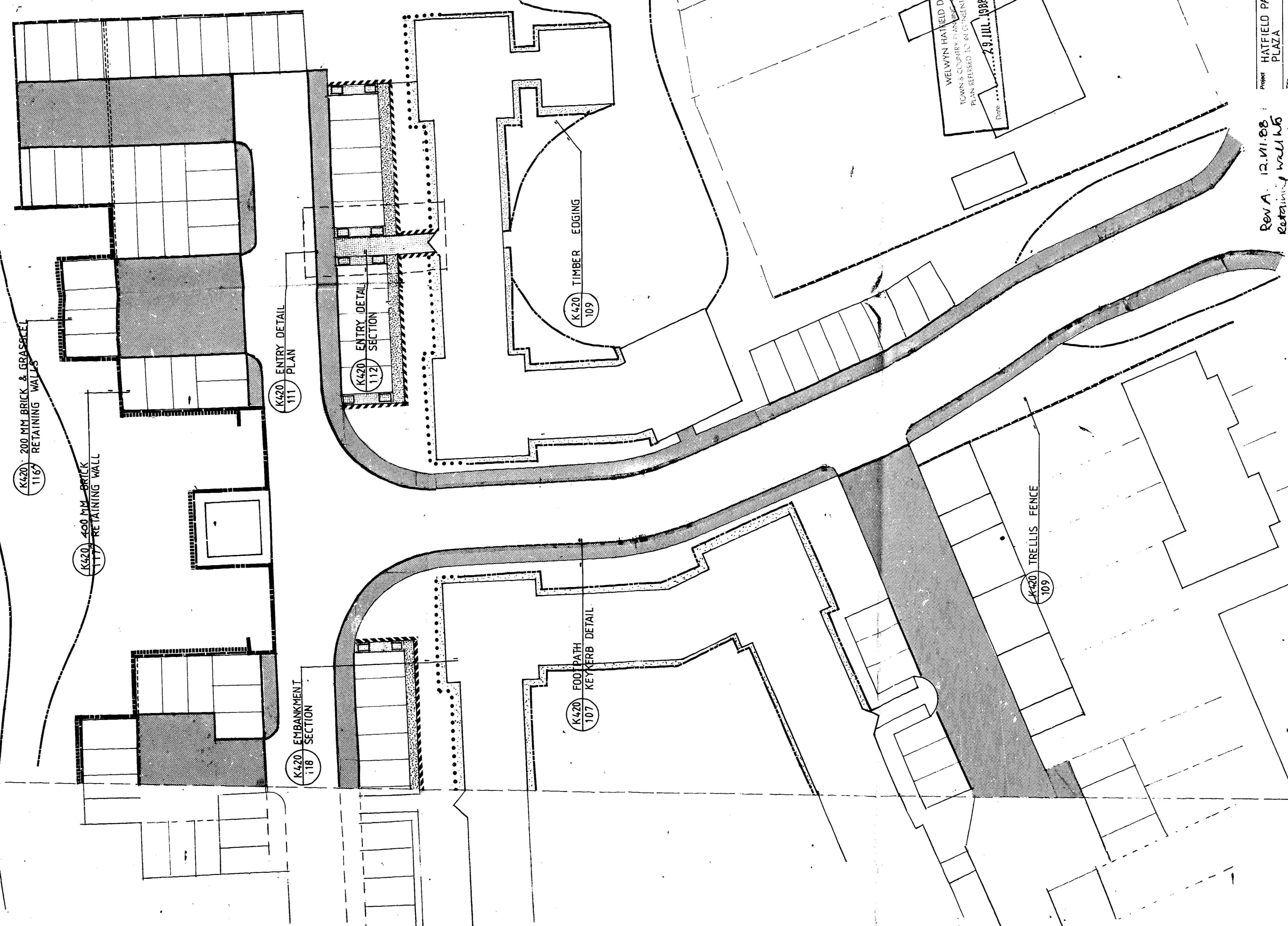
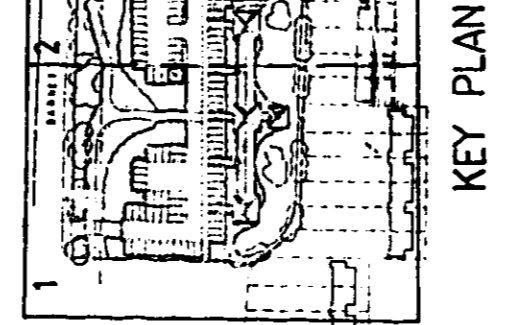
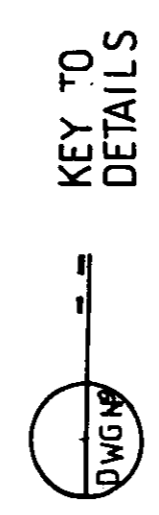

**AMENDMENT**

**OFFICE COPY**

WELWYN HATFIELD D.C.  
 RECEIVED 18 JUL 1988  
**\$61616/88**

WELWYN HATFIELD D.C.  
 TOWN & COUNTRY PLANNING  
 PLAN REFERRED TO AS AMENDMENT  
 Date: 18 JUL 1988

NOTE: The development over 600mm is allowed on turned 421.

**Clouston**  
 Brian Clouston  
 Landscape Architect  
 Planning Consultant  
 No. 1 Barnard Street  
 Welwyn Hatfield  
 Herts SG13 7JF  
 Telephone: 01438 0400  
 Facsimile: 01438 0400  
 Telex: 33077

Project: HATFIELD PARK PLAZA  
 Scale: 1:200  
 Date: 2.6.88  
 Drawn by: M.S.  
 Checked: A.A.  
 Title: HARDWORKS  
 Drawing No: K671 / 103

Rev A. 12.11.88  
 Retaining wall h6 altered.

Do not scale from this drawing © Brian Clouston and Partners Ltd.

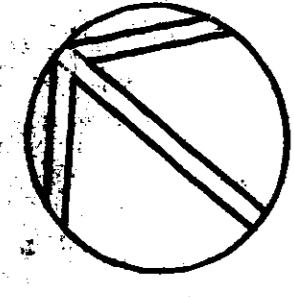

KEY

- 450 MM BRICK RETAINING WALL
- TIMBER EDGING
- GRAVEL
- RED BITUMEN
- BLACK BITUMEN
- CONCRETE BLOCK PAVING
- BRICK TRIM
- 200 MM BRICK RETAINING WALL
- 600 MM BRICK RETAINING WALL
- 400 MM GRASSCELL RETAINING WALL
- PEDESTRIAN DETERENT PAVING BLOCKS
- 850 MM STEEL POST FENCE
- 1.8 M TRELIS FENCE
- 1.8 M TIMBER PALE FENCE
- CONCRETE PLANTER BOXES
- KEY KERB
- POLYCHANNEL

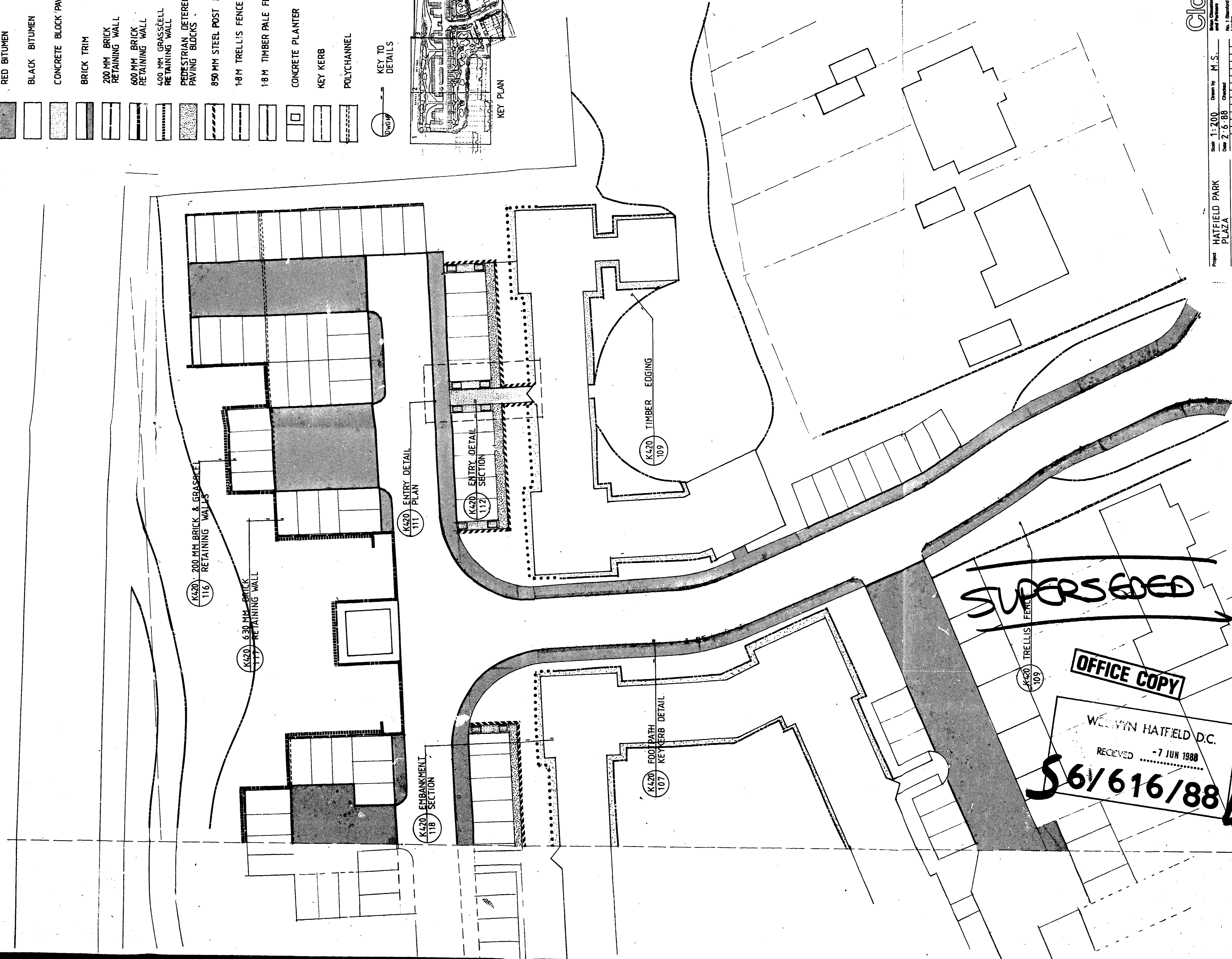
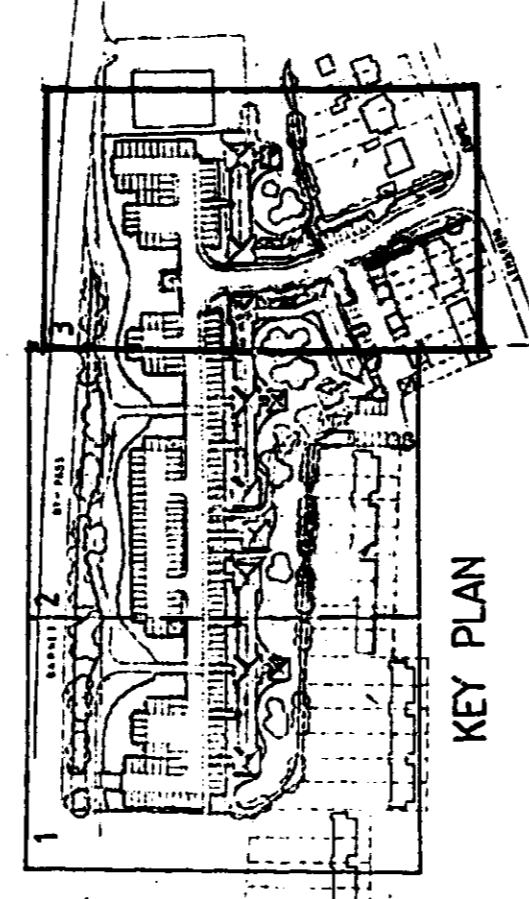

**SUPERSEDED**

**OFFICE COPY**

WELYN HATFIELD D.C.  
 RECEIVED - 7 JUN 1988  
**56/616/88 DE**

**Clouston**  
 Bill Clouston  
 Landscape Architect  
 Planning Consultant  
 Telephone: 01-600 0000  
 Telex: 34001  
 Fax: 01-600 0000

Scale 1:200 Drawn by M.S.  
 Date 2.6.88 Checked  
 Revision  
 Drawing No. K 420 / 103

Project HATFIELD PARK PLAZA  
 The HARDWORKS  
 Do not scale from this drawing © Bill Clouston and Partners Ltd.

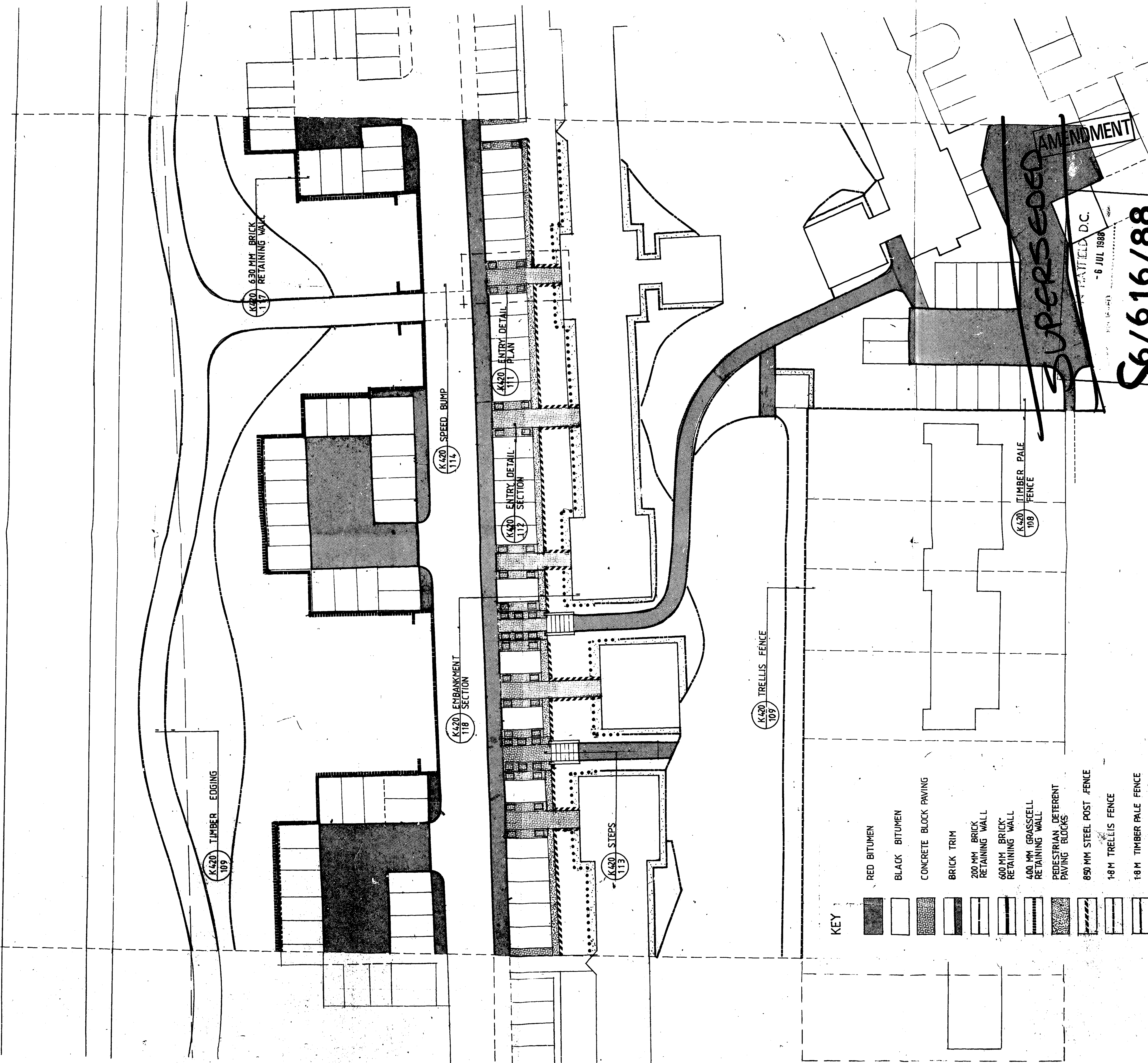
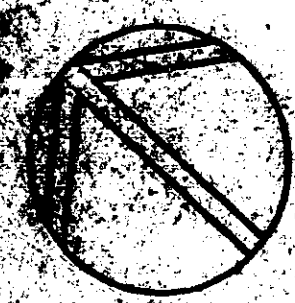

- KEY**
- RED BITUMEN
  - BLACK BITUMEN
  - CONCRETE BLOCK PAVING
  - BRICK TRIM
  - 200 MM BRICK RETAINING WALL
  - 600 MM BRICK RETAINING WALL
  - 400 MM GRASSCELL RETAINING WALL
  - PEDESTRIAN DETERENT PAVING BLOCKS
  - 850 MM STEEL POST FENCE
  - 18M TRELLIS FENCE
  - 18M TIMBER PALE FENCE
  - CONCRETE PLANTER BOXES
  - KEY KERB
  - POLYCHANNEL
  - KEY TO DETAILS

- 450 MM BRICK RETAINING WALL
- TIMBER EDGING
- GRAVEL

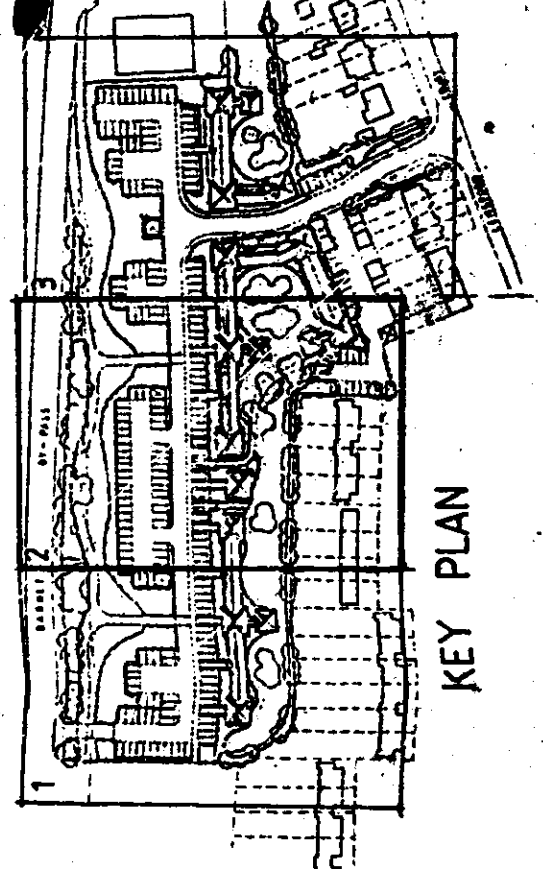

REVISION 'A' 20.9.88  
 CHANGE GARAGE LAYOUT,  
 AND MANEUVERING FOR STATIONS.

**S6/616/88**

6 JUL 1988

**SUPERSEDED**  
 AMENDMENT

**Clouston**  
 Civil, Structural, Mechanical, Electrical, and Plumbing  
 No. 1 Darnley Street  
 Leith, Edinburgh, Scotland  
 Telephone 01460 0400  
 Facsimile 01460 0400  
 Telex 220000 CLU  
 L1400

Project: HATFIELD PARK PLAZA  
 Scale: 1:200  
 Date: 2/6/88  
 Design by: M.S.  
 Checked: [ ]  
 Title: HARDWORKS  
 Drawing No.: K 671 / 102

Do not scale from this drawing © Brian Clouston and Partners Ltd.

WELWYN HATFIELD D.C.

- 7 JUN 1988

RECEIVED .....

561616/8802

OFFICE COPY

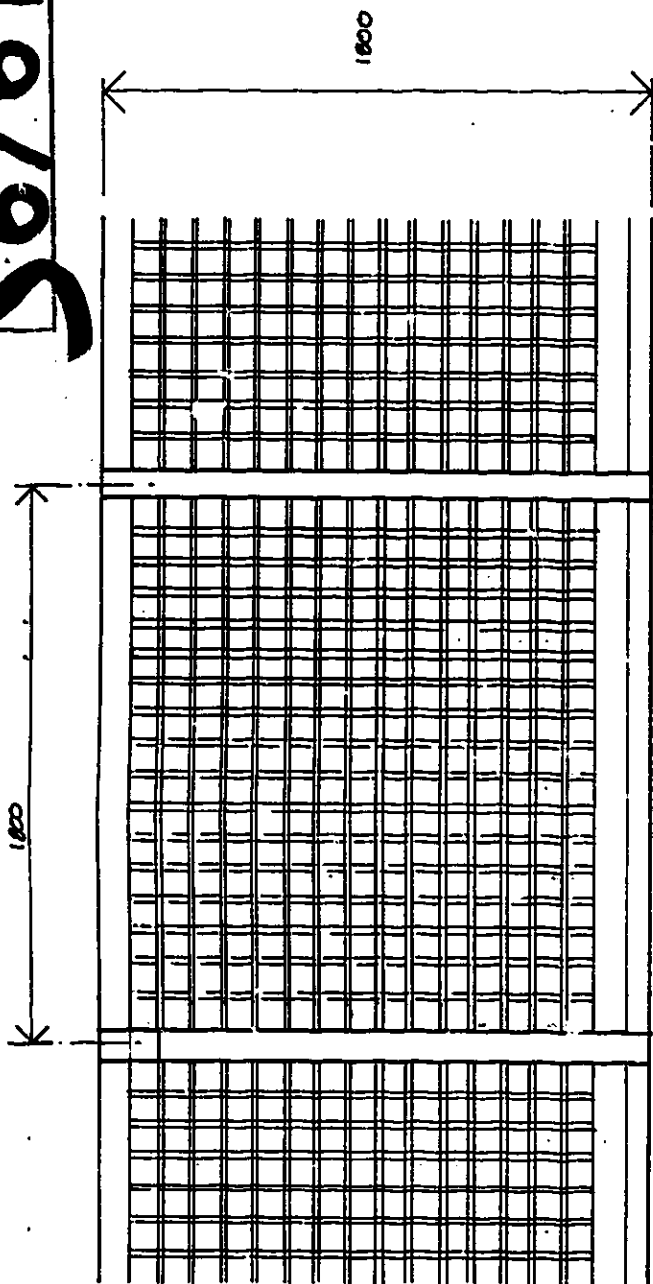

FRONT ELEVATION 1:20  
TRELLIS FENCE

WELWYN HATFIELD D.C.  
TOWN PLANNING  
PLAN FILE NO. 291011 1988  
Date .....

Clouston

Landscape architects  
Planning consultants

Telephone: 01-488 0480  
Facsimile: 01-251 0809  
Telex: 854877  
LAWCH G

Project HATFIELD PARK PLAZA

Title TRELLIS FENCE ELEVATION

Scale 1:20

Date 2.6.88

Revision

Checked

Drawing No. K 420/110

Brian Clouston  
and Partners

No. 1 Stamford Street  
London  
SE1 8HT

Do not scale from this drawing © Brian Clouston and Partners Ltd.

WELWYN HATFIELD D.C.  
TOWN & COUNTRY PLANNING  
PLANNING CONSULTANTS

29 JUL 1988

NOTE:  
ALL TIMBER TO BE ROUGH  
SAWN. APPROXIMATE WIDTH  
SHOWN IN BLACK

OFFICE COPY

WELWYN HATFIELD D.C.

7 JUN 1988

RECEIVED .....

56/616/88 Dz



100 X 125 SAWN 2 1/4" POST  
POSTS AT 1.0M C

25 X 125 ROUGH SAWN  
TIMBER BOARDS

100 X 25 MM SAWN 2 1/4"  
RAILS COUNTERSUNK  
COACH BOLTED TO POST

450 MM SQUARE  
CONCRETE SURROUND  
TO POST

20MM COURSE  
AGGREGATE

SECTION 1:10

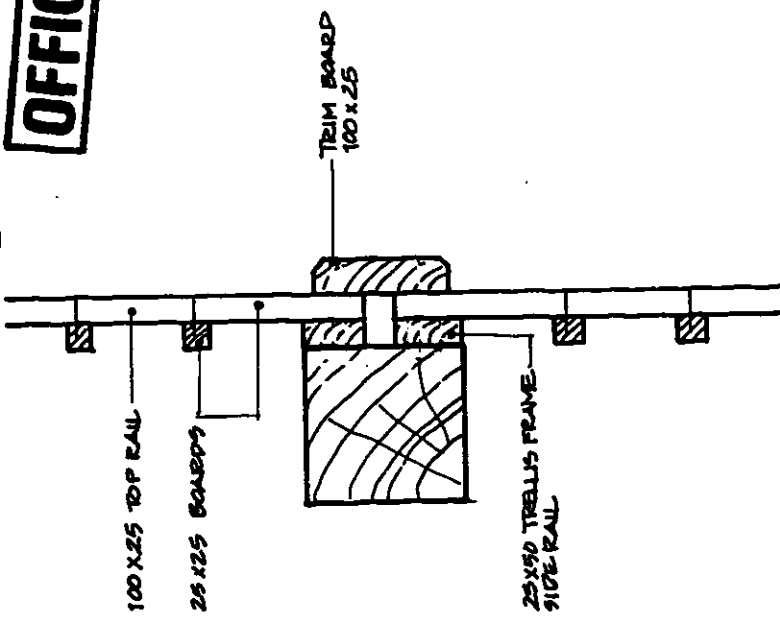

25 X 125 SOFTWOOD BOARD  
NAILED TO 600 X 90 X 50  
SOFTWOOD POST TANGEN INTO  
GROUND

*Handwritten note:* The trellis frame is to be made of softwood and is to be fixed to the post with nails.

PLAN 1:5  
POST-TRELLIS DETAIL

**Clouston**  
Landscape Architects  
Planning Consultants  
Brien Clouston  
and Partners  
No. 1 Standard Street  
London  
SE1 8HT  
Telephone: 01-481 0488  
Facsimile: 01-481 0888  
Telex: 88487  
LARCH G

Project	HATFIELD PARK PLAZA	Scale	---	Drawn by	P. C.
The	TRELLIS FENCE	Date	2.6.88	Checked	
DETAIL		Revision			
		Drawing No.	K 420/109		

Do not scale from this drawing © Brien Clouston and Partners Ltd.

**OFFICE COPY**

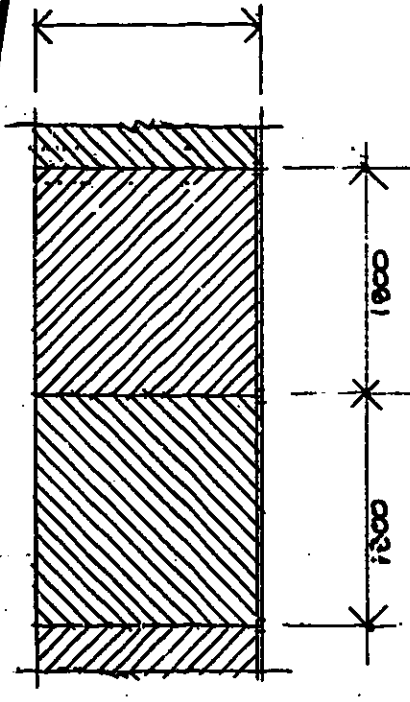

**FRONT ELEVATION**  
1:50

WELWYN HATFIELD D.C.  
TOWN & COUNTRY PLANNING  
PLANS RECEIVED 29 JUL 1988  
Date .....

WELWYN HATFIELD D.C.  
RECEIVED - 7 JUN 1988  
\$6/616/8805

**Clouston**

Landscape Architects  
Planning Consultants  
Telephone: 01-488 0488  
Facsimile: 01-481 0808  
Telex: 86487  
LAWCH G

British Clouston  
and Partners  
No. 1 Stamford Street  
London  
SE1 0HT

Scale --- Drawn by P.C.  
Date 2.6.88 Checked  
Revision  
Drawing No. K 420/108

Project **HATFIELD PARK  
PLAZA**

Title **TIMBER PALE  
FENCE**

Do not scale from this drawing © Brian Clouston and Partners Ltd.

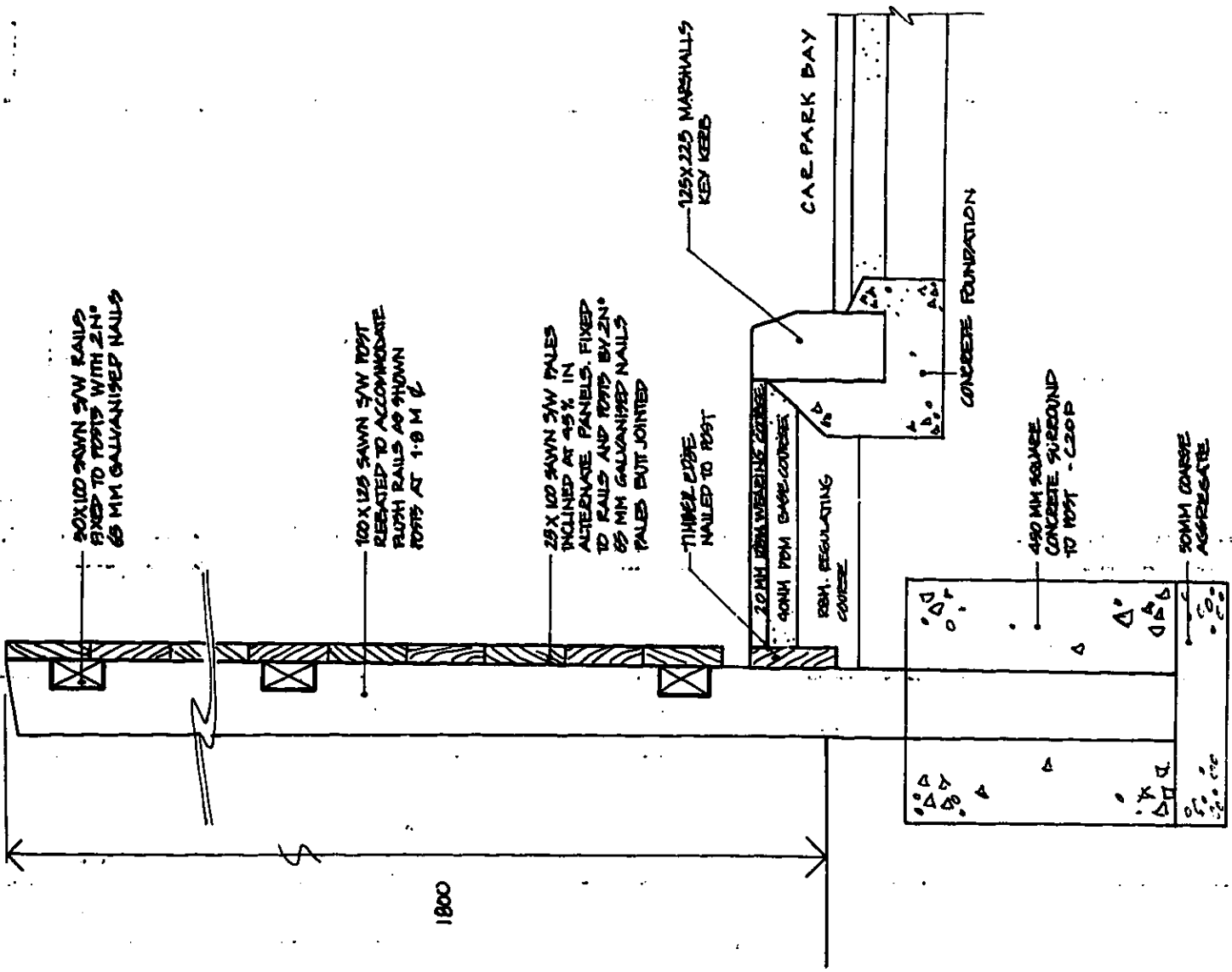

**SECTION 1:10**

WELWYN HATFIELD D.C.  
 TOWN & COUNTRY PLANNING  
 PLANNING DEPARTMENT  
 29 JUL 1988

**OFFICE COPY**

WELWYN HATFIELD D.C.  
 - 7 JUN 1988  
 RECEIVED .....

**S6/616/88D2**

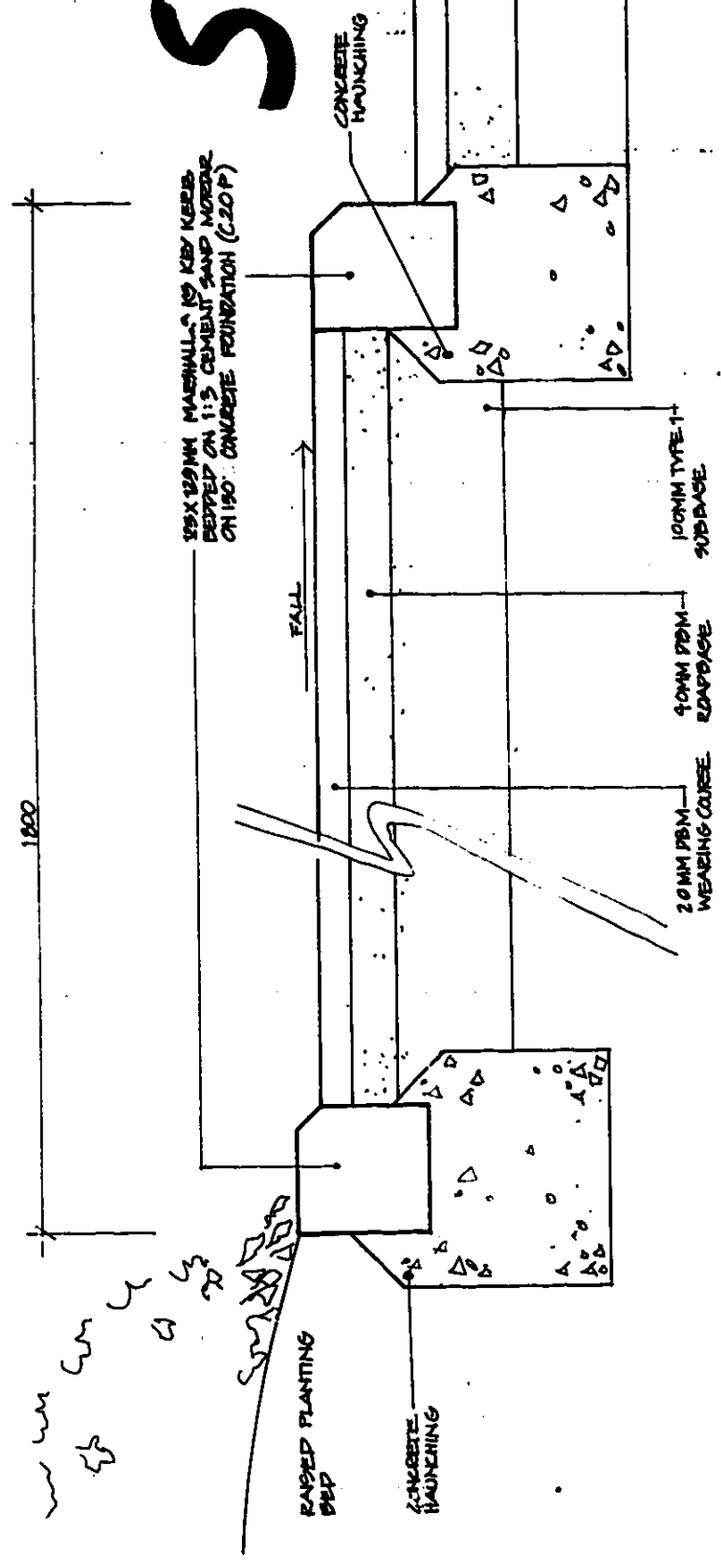

SECTION 1:5

**Clouston**

Project: HATFIELD PARK PLAZA  
 Title: FOOTPATH / KEY KERB DETAIL  
 Scale: 1:5  
 Date: 2-6-88  
 Checked: [ ]  
 Drawing No: K 420/107  
 Brian Clouston and Partners  
 No. 1 Standard Street  
 London  
 SE1 8HT  
 Telephone: 01-880 0430  
 Facsimile: 01-881 0879  
 Telex: 804887  
 LARCH 0

Do not scale from this drawing © Brian Clouston and Partners Ltd.