

1. ALL DIMENSIONS ARE IN METRES UNLESS STATED OTHERWISE.
2. THIS DRAWING TO BE READ IN CONJUNCTION WITH ALL RELATED RICHARD JACKSON LTD. ARCHITECTS & SUB-CONTRACTORS DRAWINGS. IN THE CASE OF DISCREPANCIES BETWEEN DRAWINGS REFER TO RJD10 FOR CLARIFICATION.
3. TOPOGRAPHICAL SURVEY UNDERTAKEN BY SITE VISION SURVEY LIMITED, NAMELY DRAWING NUMBERS 0117-RJC-10117/DWG.
4. THE CONTRACTOR SHALL, BEFORE COMMENCING WORK, VERIFY ALL DIMENSIONS AND SETTING OUT DIMENSIONS. THE CONTRACTOR SHALL BE RESPONSIBLE FOR THE TRUE AND PROPER SETTING OUT OF THE WORKS AND FOR THE CORRECTNESS OF THE POSITION, LEVELS, DIMENSIONS, AND ALIGNMENT OF ALL PARTS OF THE WORKS.
5. THE CONTRACTOR SHALL BE RESPONSIBLE FOR LOCATING AND PROTECTING ALL EXISTING SERVICES AFFECTED BY THE WORKS.
6. DETENTION BASIN TO BE CONSTRUCTED AND MAINTAINED IN ACCORDANCE WITH CR14 DOCUMENT C753.CHAPTER 22.

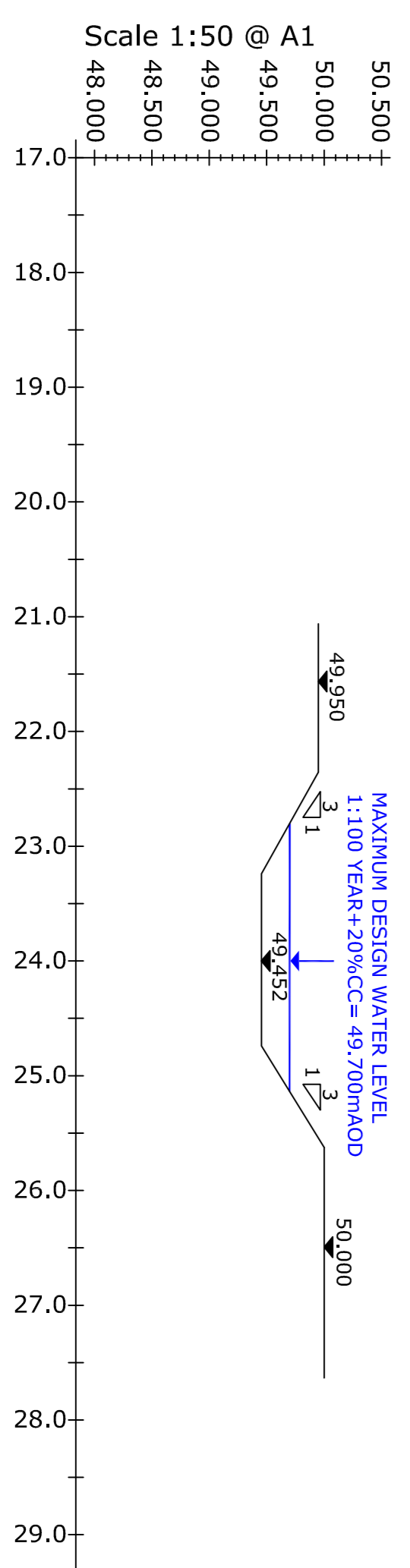
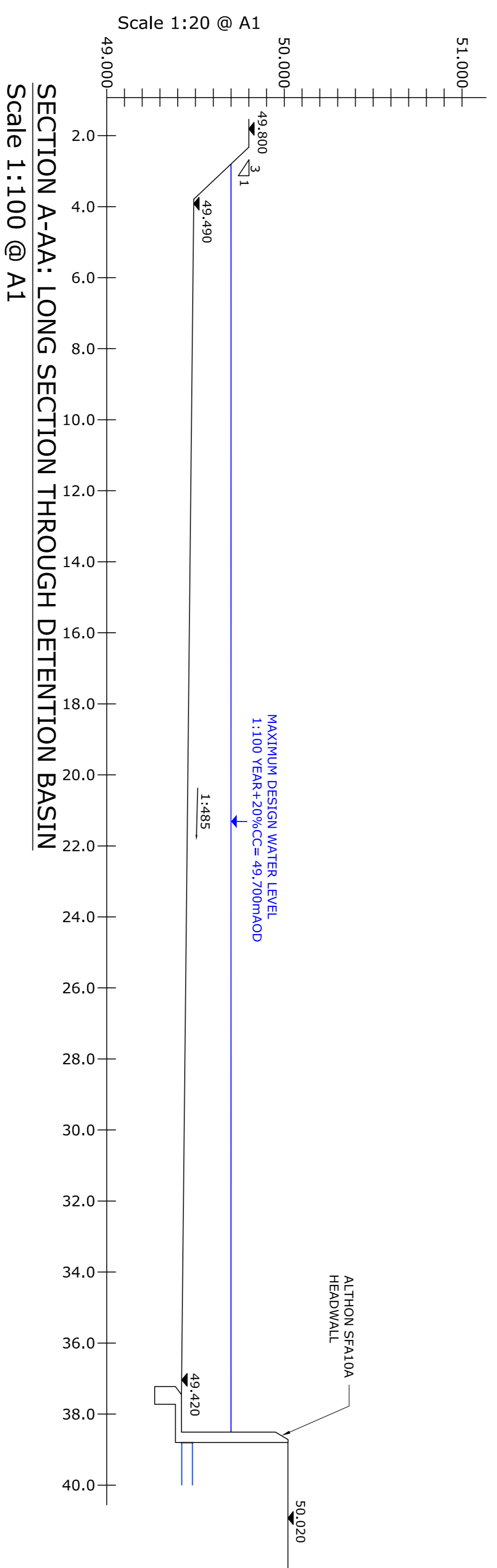
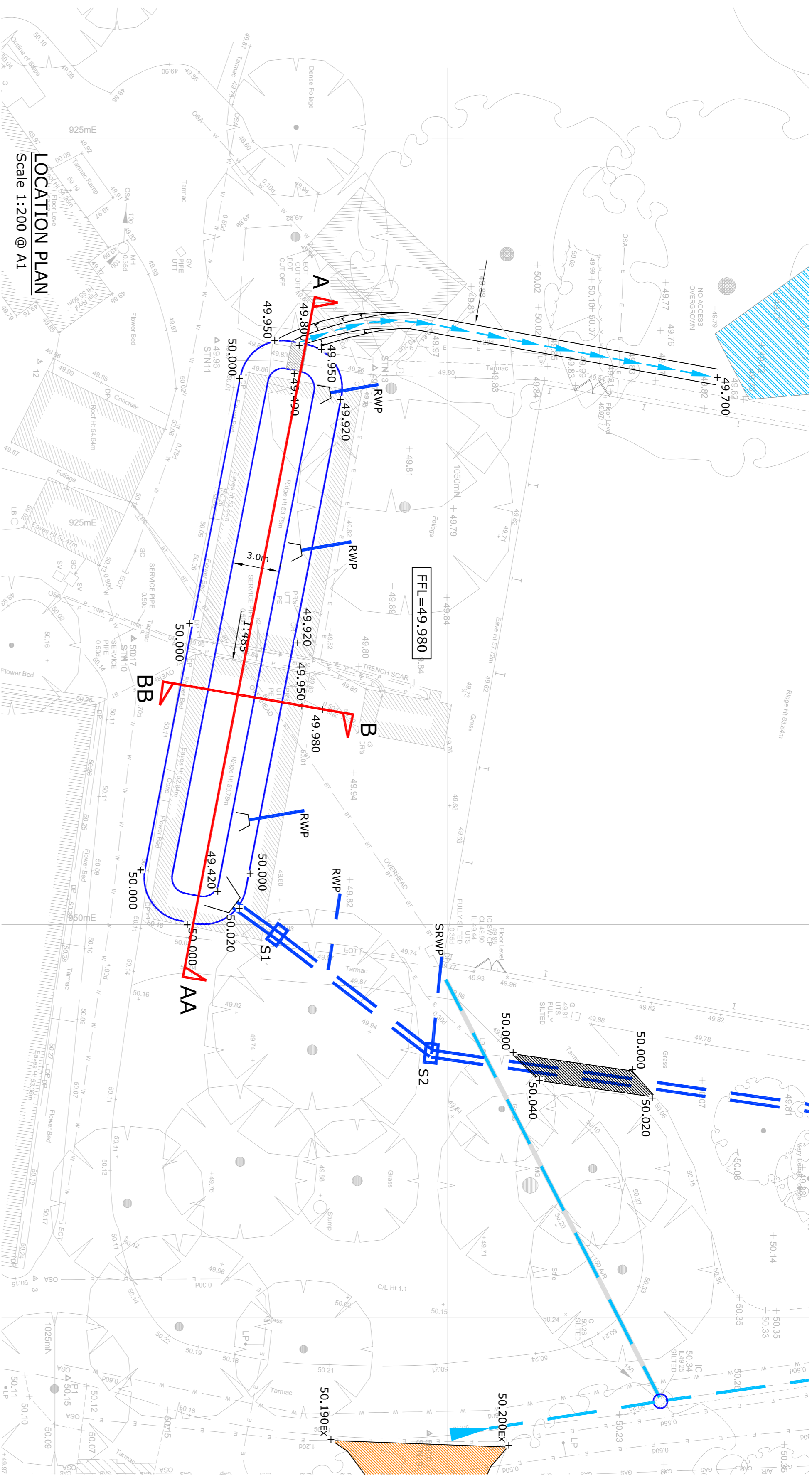

NOTE:
BASIN TOPSOIL DEPTH AND PLANTING PROPOSALS TO LANDSCAPE ARCHITECTS SPECIFICATION.

REV	DATE	DESCRIPTION	DRAWN	CHECKED

The drawing is to be read in conjunction with all other Engineer's drawings and all other project information. Any discrepancy between the Engineer's drawings and other project information is to be reported to the Engineer immediately.

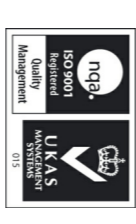

Project
**QUEENSWOOD SCHOOL,
HATFIELD**

Title
**DETENTION BASIN
SECTIONS**

Client
**BALL HALL
(PROJECT MANAGEMENT) LTD.**

Scale	Drawn	Date
1:200 @ A1	CYF	30/10/2017
Job Manager	Checked	Approved
R.M.	Z.C.	Z.C.

847 The Crescent, Colchester, Essex CO3 9YQ
 0206 228800
 0206 228801
 0206 228802
 6 The Old Church, St. Andrews Road, Newark, Nottinghamshire NG24 1SR
 01629 230400
 01629 230401
 01629 230402
 01629 230403
 01629 230404
 01629 230405
 01629 230406
 01629 230407
 01629 230408
 01629 230409
 01629 230410
 01629 230411
 01629 230412
 01629 230413
 01629 230414
 01629 230415
 01629 230416
 01629 230417
 01629 230418
 01629 230419
 01629 230420
 01629 230421
 01629 230422
 01629 230423
 01629 230424
 01629 230425
 01629 230426
 01629 230427
 01629 230428
 01629 230429
 01629 230430
 01629 230431
 01629 230432
 01629 230433
 01629 230434
 01629 230435
 01629 230436
 01629 230437
 01629 230438
 01629 230439
 01629 230440
 01629 230441
 01629 230442
 01629 230443
 01629 230444
 01629 230445
 01629 230446
 01629 230447
 01629 230448
 01629 230449
 01629 230450
 01629 230451
 01629 230452
 01629 230453
 01629 230454
 01629 230455
 01629 230456
 01629 230457
 01629 230458
 01629 230459
 01629 230460
 01629 230461
 01629 230462
 01629 230463
 01629 230464
 01629 230465
 01629 230466
 01629 230467
 01629 230468
 01629 230469
 01629 230470
 01629 230471
 01629 230472
 01629 230473
 01629 230474
 01629 230475
 01629 230476
 01629 230477
 01629 230478
 01629 230479
 01629 230480
 01629 230481
 01629 230482
 01629 230483
 01629 230484
 01629 230485
 01629 230486
 01629 230487
 01629 230488
 01629 230489
 01629 230490
 01629 230491
 01629 230492
 01629 230493
 01629 230494
 01629 230495
 01629 230496
 01629 230497
 01629 230498
 01629 230499
 01629 230500

Drawing No. **47420/C/010**

Drawing Status	Approval	Costing
<input type="checkbox"/> INFORMATION	<input checked="" type="checkbox"/> APPROVAL	<input type="checkbox"/> COSTING
<input type="checkbox"/> TENDER	<input type="checkbox"/> CONSTRUCTION	<input type="checkbox"/> AS CONSTRUCTED