

AYLMER
LAND
ROVER
DEALER

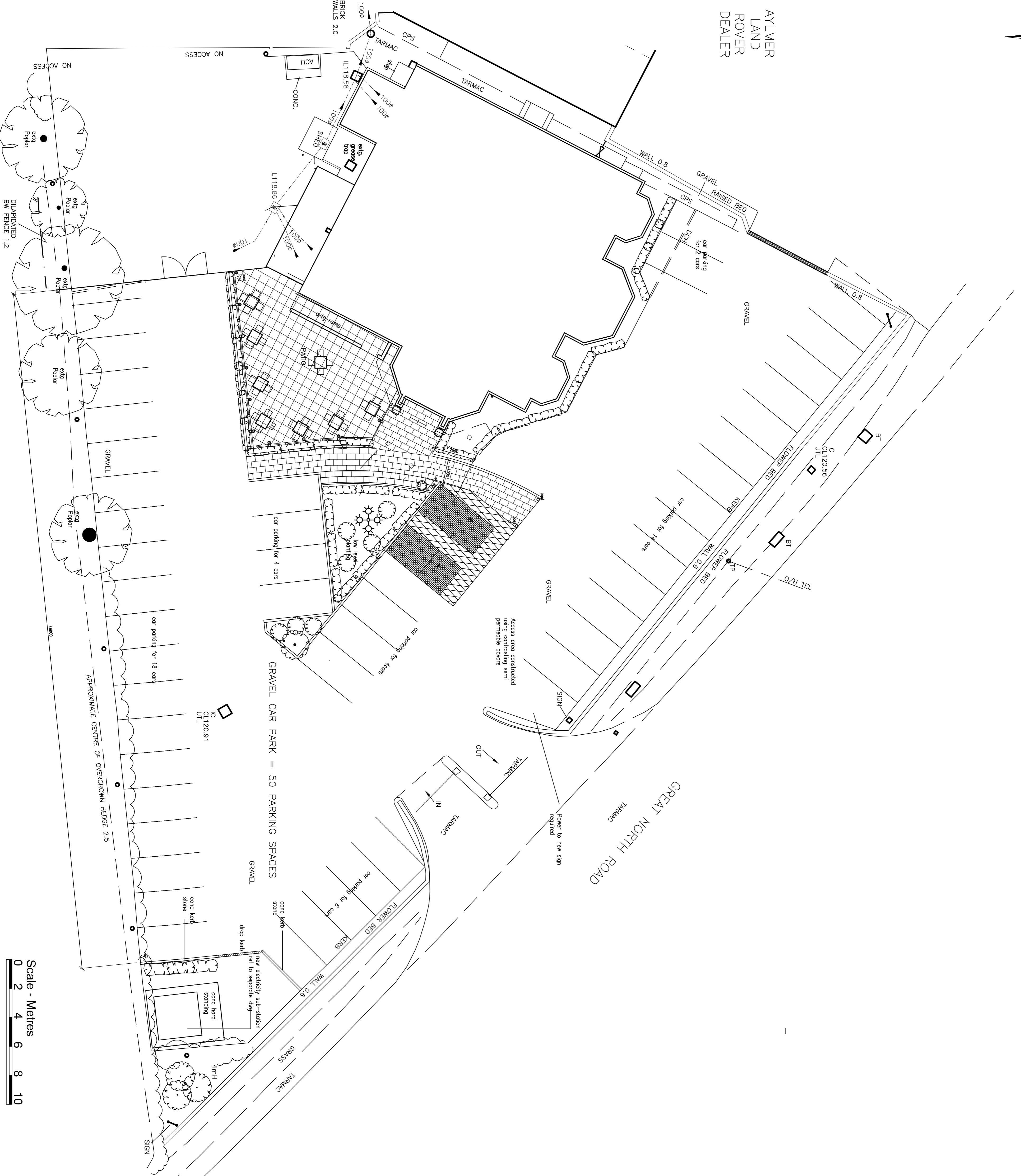

Scale - Metres
0 2 4 6 8 10

Proposed Site Layout Plan @ 1 to 100

NOTES

The Contractor is to check and verify all building and site dimensions, levels and sewer connections at construction points before work starts. They are to be responsible for ensuring that the site is suitable for the proposed development and that all necessary permissions and consents are obtained. The Contractor is to ensure that all ground level is supported and that all foundations are suitably designed and constructed. The Contractor is to ensure that all foundations are suitably designed and constructed. The Contractor is to ensure that all foundations are suitably designed and constructed.

Michells & Butlers Field
Landed
27 Fleet Street
Birmingham
B5 1LP
0870 809 3000

Michells & Butlers

REVISIONS	DATE
DESCRIPTION	27 DATE

DESIGN COALITION
THE OLD WILLCOTE STREET ONGAR ESSX CM9 9Y
ADMIN@DESIGNCOALITION.CO.UK 01273 348800
WWW.DESIGNCOALITION.CO.UK

PROJECT
Brookmans Park
Hatfield

BRAND
MULLER & CARTER
STEAKHOUSE

SUB
Existing Site Plan

NO.	DATE	REVISION
1	11/10	1:200
2	11/10	1:200
3	11/10	1:200
4	11/10	1:200
5	11/10	1:200
6	11/10	1:200
7	11/10	1:200
8	11/10	1:200
9	11/10	1:200
10	11/10	1:200
11	11/10	1:200
12	11/10	1:200
13	11/10	1:200
14	11/10	1:200
15	11/10	1:200
16	11/10	1:200
17	11/10	1:200
18	11/10	1:200
19	11/10	1:200
20	11/10	1:200
21	11/10	1:200
22	11/10	1:200
23	11/10	1:200
24	11/10	1:200
25	11/10	1:200
26	11/10	1:200
27	11/10	1:200
28	11/10	1:200
29	11/10	1:200
30	11/10	1:200
31	11/10	1:200
32	11/10	1:200
33	11/10	1:200
34	11/10	1:200
35	11/10	1:200
36	11/10	1:200
37	11/10	1:200
38	11/10	1:200
39	11/10	1:200
40	11/10	1:200
41	11/10	1:200
42	11/10	1:200
43	11/10	1:200
44	11/10	1:200
45	11/10	1:200
46	11/10	1:200
47	11/10	1:200
48	11/10	1:200
49	11/10	1:200
50	11/10	1:200
51	11/10	1:200
52	11/10	1:200
53	11/10	1:200
54	11/10	1:200
55	11/10	1:200
56	11/10	1:200
57	11/10	1:200
58	11/10	1:200
59	11/10	1:200
60	11/10	1:200
61	11/10	1:200
62	11/10	1:200
63	11/10	1:200
64	11/10	1:200
65	11/10	1:200
66	11/10	1:200
67	11/10	1:200
68	11/10	1:200
69	11/10	1:200
70	11/10	1:200
71	11/10	1:200
72	11/10	1:200
73	11/10	1:200
74	11/10	1:200
75	11/10	1:200
76	11/10	1:200
77	11/10	1:200
78	11/10	1:200
79	11/10	1:200
80	11/10	1:200
81	11/10	1:200
82	11/10	1:200
83	11/10	1:200
84	11/10	1:200
85	11/10	1:200
86	11/10	1:200
87	11/10	1:200
88	11/10	1:200
89	11/10	1:200
90	11/10	1:200
91	11/10	1:200
92	11/10	1:200
93	11/10	1:200
94	11/10	1:200
95	11/10	1:200
96	11/10	1:200
97	11/10	1:200
98	11/10	1:200
99	11/10	1:200
100	11/10	1:200