

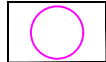





This drawing is the property of Andrew Belson Arbicultural Consultant. Copyright is reserved by him and the drawing is issued on the condition that it is not copied, reproduced, retained nor disclosed to any unauthorized person either wholly or in part without the consent of Andrew Belson.

NOTES: Based on drawing TDC043/PL/001
The original of this drawing was produced in colour – a monochrome copy should not be relied upon

KEY

-  ROOT PROTECTION AREA
-  CANOPY OUTLINE - INDIVIDUAL TREE
-  CANOPY OUTLINE - GROUPS
-  TREES IMPLICATED FOR REMOVAL
-  BARRIER TO FIG 2. BS5837
-  BARRIER TO FIG 3. BS5837
-  AREAS FOR PRUNING
-  DRIVEWAY WITH PERMEABLE SURFACE CONSTRUCTED WITH MINIMAL EXCAVATION

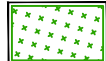
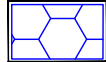
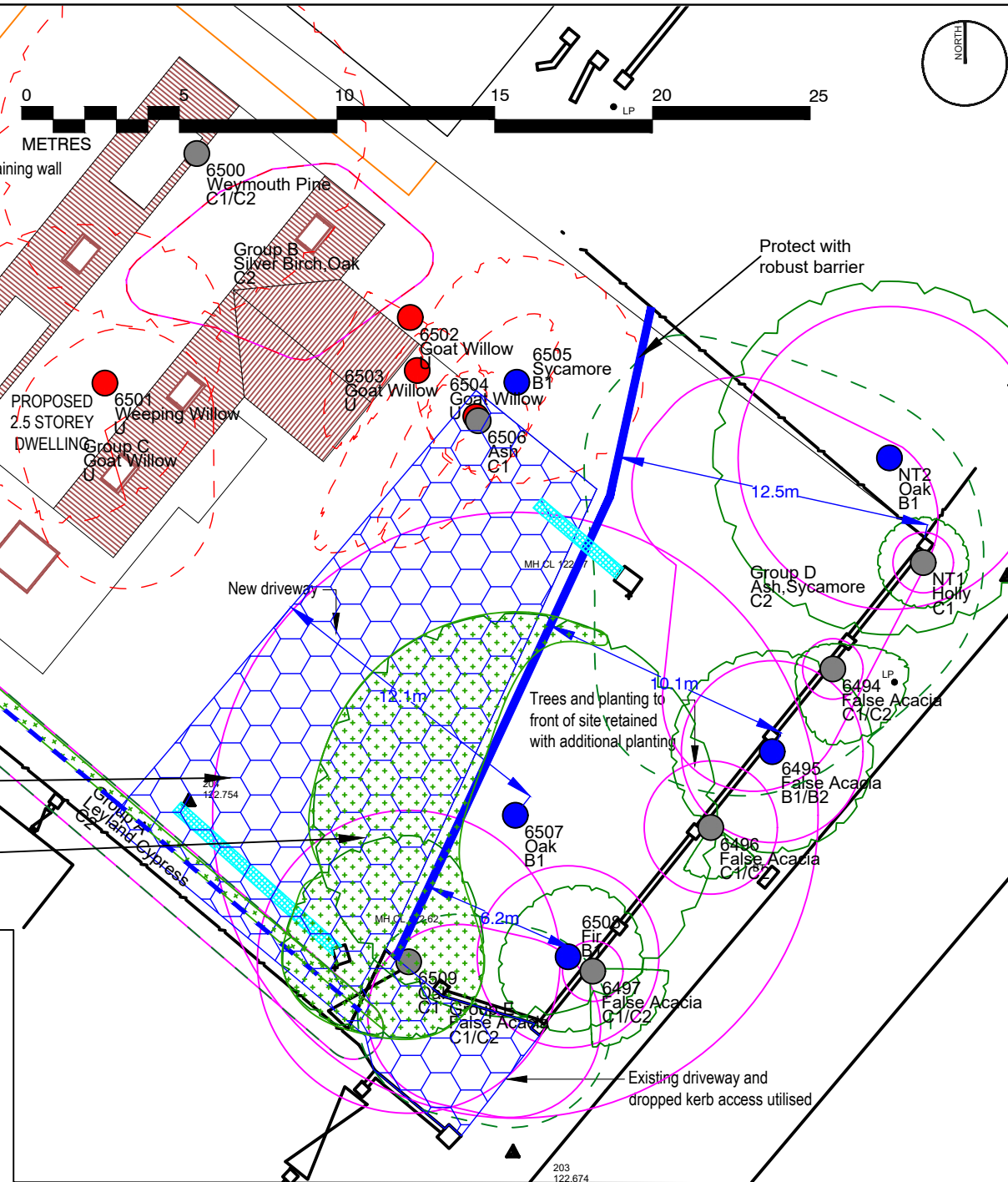

ARBORICULTURAL METHOD STATEMENT

General

This Method Statement provides recommendations for the protection of trees during development of the layout shown on the drawing.

Statutory implications

Trees and other vegetation can often provide nesting, roosting and feeding opportunities for protected species, including bats. Providing guidance on these issues is outside my expertise, so I recommend that appropriate advice is sought before any tree work proceeds on site.

Full Planning Consent overrides the need for a Tree Preservation Order works application.

Supervision and Monitoring

It is important that the tree protection measures are understood and adopted at all levels from client to project manager and any sub-contractors in order that the measures can be successful.

A qualified Arboricultural Consultant should be retained during the period of construction to:

- mark trees for removal and meet with the arboricultural contractor to discuss the tree works specified
- meet with contractors and the site manager prior to construction to discuss the implementation of the tree protection measures; the location of the site facilities (if not already known) and any phased construction that may affect the protection of trees
- inspect barriers prior to the commencement of construction or demolition
- attend site during installation of the driveway surfacing to provide a watching brief

Communication between the Client, Main Contractor (and their sub-contractors), the Project Manager and the Arboriculturalist are of high importance.

The Site Manager will monitor the physical and managed protective tree measures continually.

ARBORICULTURAL WORKS

Standards

Tree work is skilled and potentially dangerous work, which must be carried out by trained and certificated staff working to BS3998: 2010 and working in accordance with the various Regulations within the Health and Safety at Work Act 1974

Contractors must have Public Liability Insurance (preferably £5 million) and Employer's Liability Insurance (preferably £10 million)

Machinery and equipment must be maintained, inspected and operated in accordance with the various Regulations within the Health and Safety at Work Act 1974

Prior to works

Tree work must be the first operation, before any other activity on site involving plant, machinery or materials.

Before the commencement of any treeworks, the contractor will ensure that the proper checks for bats and nesting birds have been carried out by an appropriately-qualified inspector.

The Contractor will be responsible for producing their own Method Statement for the works that will include Risk Assessments, staff profiles and certification, machinery and equipment inspection records and certificates.

Disposal of timber, brush and other arising to be agreed with the Client.

Stump removal may be required and will be agreed with the Client, including the disposal of arisings as appropriate.

Work required

Remove the following trees:

- Scots Pine 6499
- Weymouth Pine 6500
- Group B
- Group C
- Weeping Willow 6501
- Goat Willow 6502
- Goat Willow 6503
- Goat Willow 6504
- Sycamore 6505
- Ash 6506

Lift the crowns of trees in Group D, Oak 6507 and Oak 6509 to 3.6m above the existing ground level.

Trim hedge Group A to 0.75m off the root line

Remove dead wood greater than 25mm from all retained trees.

Trim hedge back to 0.75m off rootline

Either lay no-dig driveway surface before any construction begins or protect with hired-in sheeting system until end of main construction phase

Lift crowns of Oaks to 3.6m over site

PROTECTIVE MEASURES

Barriers

Once the treeworks are complete, a barrier to Fig 2 BS5837 will be erected where shown by the broad blue lines and to Fig 3 where shown by the dashed broad blue lines on the Tree Protection Plan.

Weather-proof notices stating: 'PROTECTED AREA - DO NOT ENTER' to be erected on the fencing not less than 5m apart.

Temporary access to the protected area will be by permission of the LPA arboriculturalist.

The site manager will assess the integrity of the protective barrier protection measures continually. Any shortcomings must be rectified to the original specifications immediately.

Barriers will remain in place until the end of the main construction period.

The Site Manager will keep a copy of the Tree Protection Plan on site for reference during construction and for site induction where staff or contractors' work may implicate working near trees so they understand the purpose of the measures.

Ground Protection

Ground within the driveway area that will be constructed with minimal excavation will either be constructed in accordance with the method below or covered with a robust sheeting system for the duration of the main development phase. Areas for ground protection are shown by the blue honeycomb hatch on the drawing.

The following systems of ground protection would all be suitable but others are available:

- LIVE (formerly Eve) provide Trakway access systems in timber, aluminium or plastic for a variety of potential loads. See <http://www.livetrakway.com> for more details or call 08700 76 76 76).
- Alternatively, Ground-Guards provide a range of ground protection mats from lightweight to heavy-duty. See <http://www.ground-guards.co.uk> for more details or call 0113 267 6000).
- Start Traffic Ltd stock medium and heavy-duty ground protection mats with coarse tread patterns to provide traction in all weathers. See <https://starttraffic.uk/> for more details or call 01905 700 340)

CONSTRUCTION PHASE

General notes

Once the barriers and ground protection have been checked, development will then continue in accordance with the Approved Plans.

No fires will be lit on site.

No storage or discharge of materials within 5 metres of a tree bole.

No mixing of cement or dispensing of fuel or chemicals within 10 metres of the tree bole.

No stripping of topsoil, excavation or changing of levels to occur within the RPA.

Any damage that occurs to the trees during construction will be rectified to BS3998: 2010.

Trees must not be used as anchor points for winching or for supporting wires/cables.

Installation of Services

Any trenches to make connections to the existing inspection chambers will be carried out with care. Excavation will be minimised so far as is practical and any roots greater than 25mm diameter will be preserved.

Any other trenching for the installation of services or other excavations for soakaways etc. will be located at least 1m from the radial extent of the RPAs drawn.

Construction of Driveway

At the appropriate point in the construction phasing (this could be before any work starts) and after any service trenches have been back-filled, the area denoted by the blue hexagonal hatch on the drawing will be paved over the existing surface level so far as practical with the use of a cellular confinement system in accordance with the following specification:

- The soil in the driveway area (but not within any of the trees' root protection areas) will be sampled and tested in a laboratory for the California Bearing Ratio (CBR). The final specification of the driveway will be calculated by an engineer using the CBR figure derived from the laboratory testing; and with knowledge of the type of final paved finish approved elsewhere.
- The engineer will set out the area for finished levels that take account of the full depth of the geoweb and paved finish.
- The Project arboriculturalist will be in attendance for the installation of the no-dig surfacing.
- The vegetable layer of soil will be carefully removed by hand using hand tools only to a depth of no more than 75mm and deeper as necessary to allow the driveway to meet with the finished paved level of Kentish Lane
- A filter membrane such as 'Terram 1000' will be laid over the excavated area.
- A cellular confinement system to the specified profile depth will be laid over the membrane. Options include:

The Geoweb® Tree Root Protection System offered by Greenfix UK (see <http://greenfix.co.uk> for more details or call 01608 666027).

Cellweb® Tree Root Protection (TRP) from Geosynthetics Limited (see <http://www.geosyn.co.uk> or call 01455 617 139)

- If possible, the driveway edgings will be formed with timber edging boards supported by driven stakes. If concrete kerbs and haunching is essential, kerbs and concrete will be laid on top of the cellular confinement system and secured by driven reinforcing rods or similar.
- The cellular confinement system will be backfilled with 20-40mm no-fines graded stone and compacted, adding more aggregate as necessary to bring to level.
- If the surfacing is installed before development commences, the prepared surfacing will then be protected for the remainder of the main construction period with a filter membrane laid directly over the cellular confinement system that is capped with a 150mm sacrificial layer of MOT Type 1 or hired-in ground protection (see ground protection above)
- The prepared surface will be finished in accordance with the Approved Materials.

POST CONSTRUCTION PHASE

General notes

Once all the construction and hard landscaping works are completed, the protective barriers will be removed and the landscaping works will be completed.

Soil cultivation within the previously protected zones (i.e. within the Root Protection Areas) will be carried out by hand only. No machine cultivation will take place within these zones whatsoever.

Planting within Root Protection Areas will be carried out by hand using hand tools only.

Retained trees will be re-inspected post-development by a qualified arboriculturalist and any works arising carried out within the time limits specified.

Paving

Paving laid within root protection areas will be constructed with a minimum of excavation. Excavation will be limited to 50mm below the existing ground level.

Rev	Description	Date
	Purpose of Issue	
	Planning	
 Andrew Belson Arbicultural Consultant The Tree House, 1a First End Station Road, Uppingham Oakham LE15 9EU t: 01572 823637 e: info@belsontreesurvey.co.uk		
Client Mr M Vignali		
Project Land at 45 Kentish Lane, Brookmans Park		
Drawing Title Tree Protection Plan		
Drawn AMB	Checked --	Reviewed --
Job No. 4024	Scale 1:250	Sheet Size A3
Date 17/04/2020		
Drawing Number 4024.Brookmans.TD.TPP		