

Current Floor Plate  
Overall Circa 98sqm

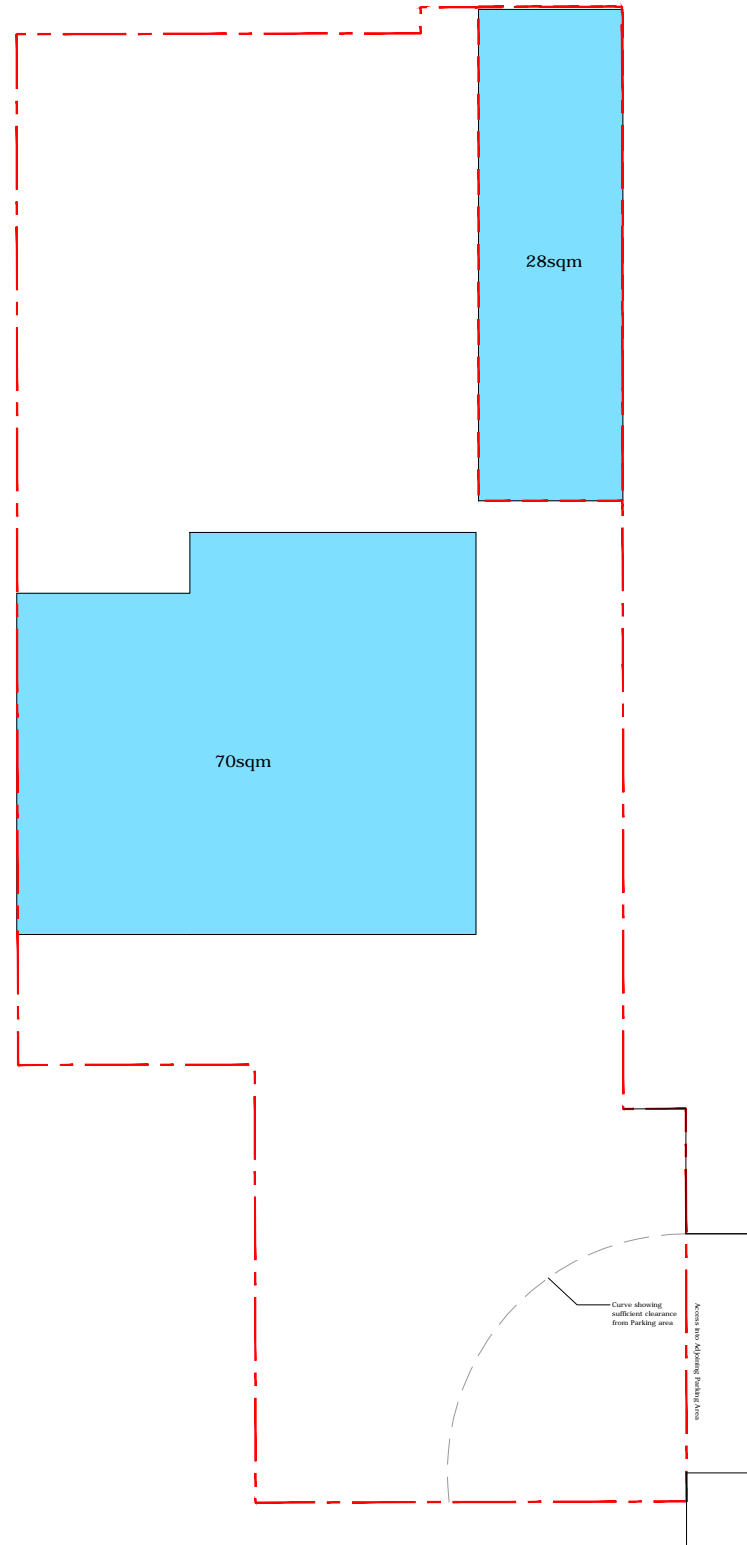

Existing Ground Floor

Proposed Additional Floor Plate  
56sqm

Combined New Floor Plate  
70sqm + 22sqm + 56sqm  
= 148sqm

Increase in Floor Area of 50sqm

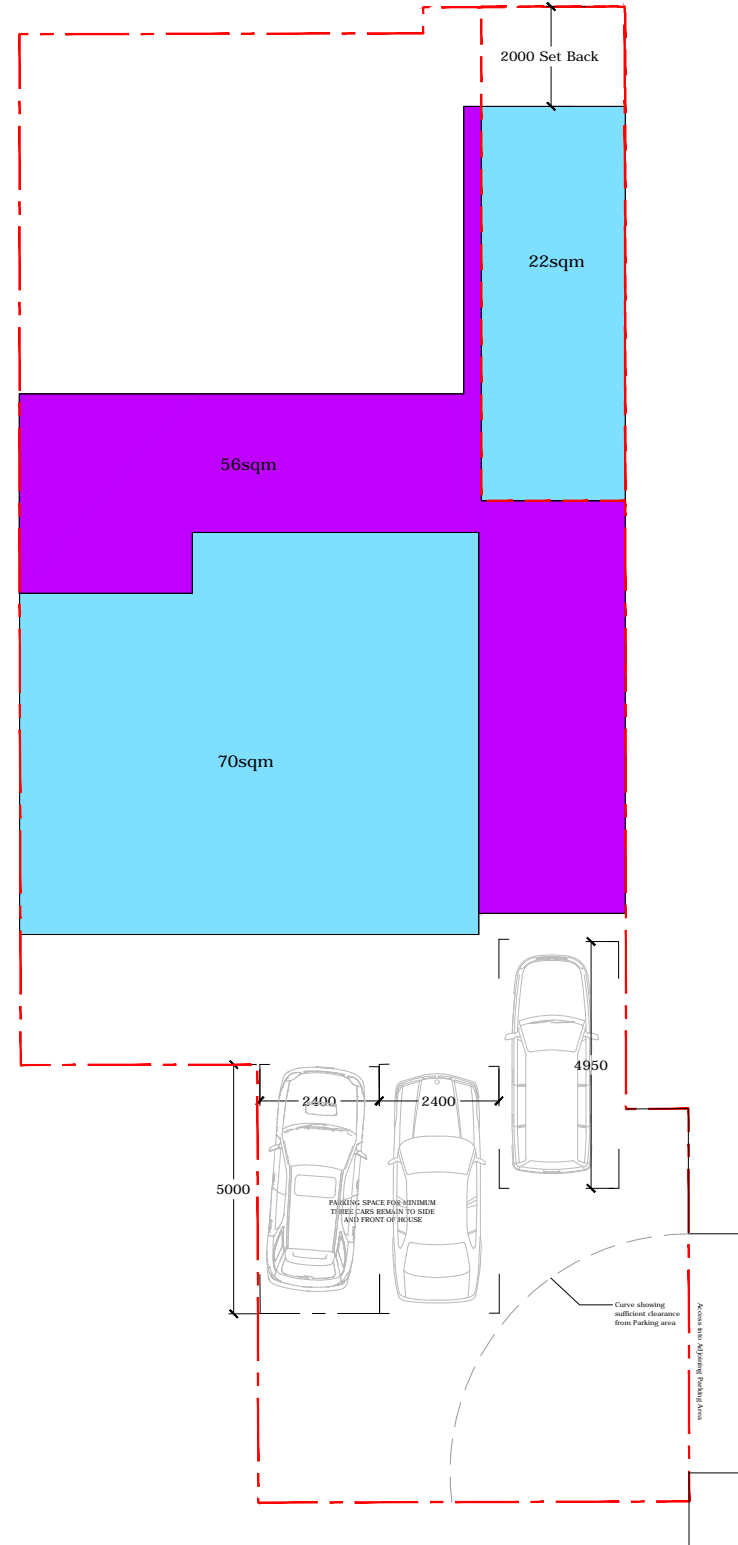

Proposed Ground Floor

**GENERAL NOTE**  
THIS DRAWING IS THE PROPERTY OF INK2DESIGN LTD. IT MAY NOT BE COPIED OR DISCLOSED TO ANY THIRD PARTY FOR ANY PURPOSE EXCEPT AS AUTHORISED IN WRITING BY INK2DESIGN LTD.

LARGE SCALE DRAWINGS TO BE USED IN PREFERENCE TO SMALL SCALE DRAWINGS.  
ALL DIMENSIONS ARE TO BE CHECKED ON SITE BEFORE ANY WORK PROCEEDS.  
ANY ERRORS OR OMISSIONS ARE TO BE REPORTED TO INK2DESIGN LTD.  
IF IN DOUBT ASK.

THIS DRAWING IS TO BE READ IN CONJUNCTION WITH ALL THE RELEVANT CONSULTANTS AND/OR SPECIALIST DRAWINGS/DOCUMENTS AND ANY DISCREPANCIES OR VARIATIONS ARE TO BE NOTIFIED TO INK2DESIGN LTD BEFORE THE AFFECTED WORK COMMENCES.

**PLEASE NOTE**  
THE CONTRACTOR MUST AVOID FORESEEABLE RISKS TO THE HEALTH AND SAFETY OF THOSE WORKING ON OR OFF SITE ON THIS CONSTRUCTION AND AVOID THE USE OF ANY MATERIALS OR PRACTICES WHICH MIGHT BE HAZARDOUS OR CONTRAVENE ANY REGULATIONS.

Rev:	Date:	Description

NOTES:

STATUS: **FOR INFORMATION ONLY**

job no: 3172  
project: 4 Queen Bee Court, Hatfield AL10 9PR  
drw title: Massing Plan

drwg no: 3172/PL/008    rev: 00    date: Oct 19    scale: NTS@A3

**INK2DESIGN LTD**  
Unit 1  
200 Mile End Road  
London E1 4LJ  
0207 791 2299  
info@ink2design.co.uk