

Location Plan 1:1250 @ A3

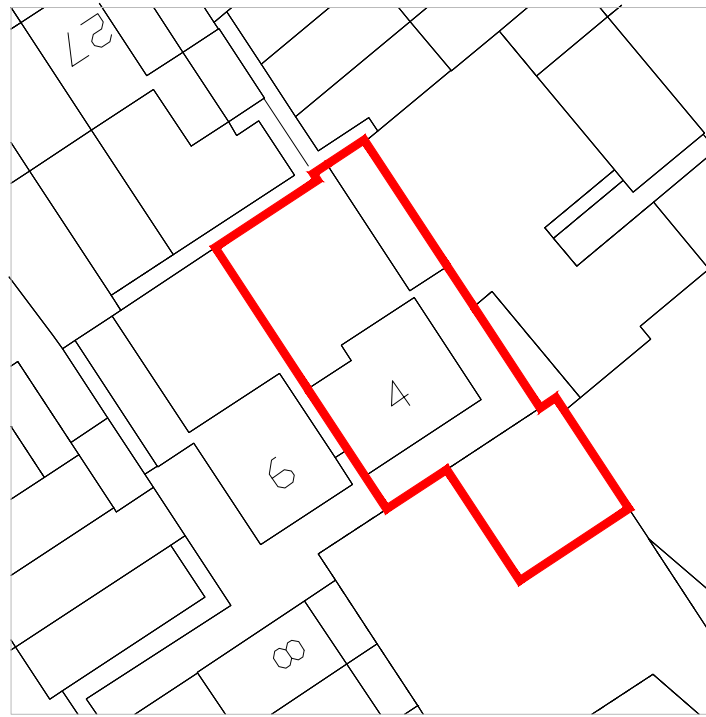

Existing Block Plan 1:500 @ A3

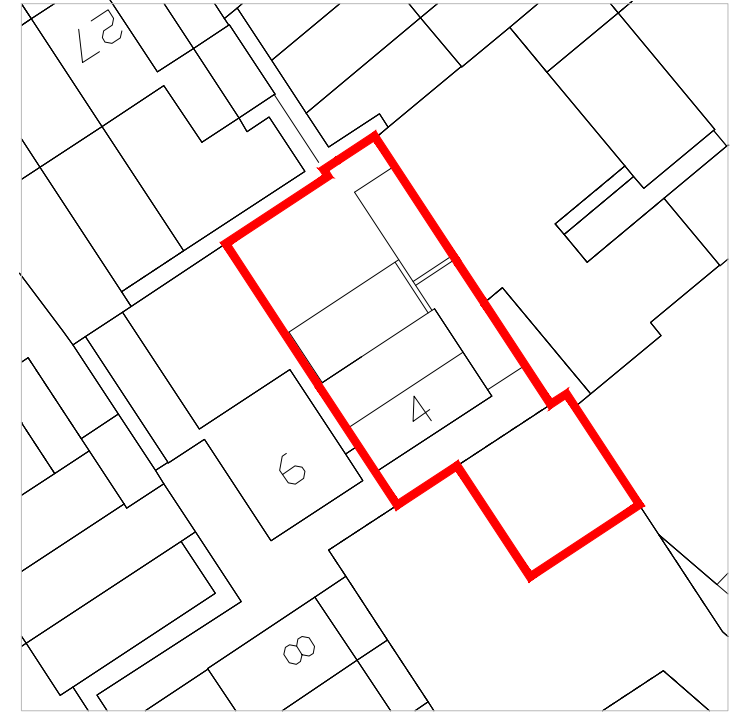

Proposed Block Plan 1:500 @ A3



View From Front



View From Rear

GENERAL NOTE
 THIS DRAWING IS THE PROPERTY OF INK2DESIGN LTD. IT MAY NOT BE COPIED OR DISCLOSED TO ANY THIRD PARTY FOR ANY PURPOSE EXCEPT AS AUTHORISED IN WRITING BY INK2DESIGN LTD.
 LARGE SCALE DRAWINGS TO BE USED IN PREFERENCE TO SMALL SCALE DRAWINGS.
 ALL DIMENSIONS ARE TO BE CHECKED ON SITE BEFORE ANY WORK PROCEEDS.
 ANY ERRORS OR OMISSIONS ARE TO BE REPORTED TO INK2DESIGN LTD.
 IF IN DOUBT ASK.
 THIS DRAWING IS TO BE READ IN CONJUNCTION WITH ALL THE RELEVANT CONSULTANTS AND/OR SPECIALIST DRAWINGS DOCUMENTS AND ANY DISCREPANCIES OR VARIATIONS ARE TO BE NOTIFIED TO INK2DESIGN LTD BEFORE THE AFFECTED WORK COMMENCES.
PLEASE NOTE
 THE CONTRACTOR MUST AVOID FORESEEABLE RISKS TO THE HEALTH AND SAFETY OF THOSE WORKING ON OR OFF SITE ON THIS CONSTRUCTION AND AVOID THE USE OF ANY MATERIALS OR PRACTICES WHICH MIGHT BE HAZARDOUS OR CONTRAVENE ANY REGULATIONS.

Rev:	Date:	Description
01	13.10.19	Updated to Show Amended Site Line in Accordance with Land Registry Document

NOTES:

STATUS: FOR INFORMATION ONLY

job no:	3172
project:	4 Queen Bee Court, Hatfield AL10 9PR
drw title:	Location Plan and Photos
drwg no:	3172/PL/000
rev:	01
date:	Aug 19
scale:	1:1250@A3

INK2DESIGN LTD
 Unit 1
 200 Mile End Road
 London E1 4LJ
 0207 791 2299
 info@ink2design.co.uk