

1 Location Plan
1:1250

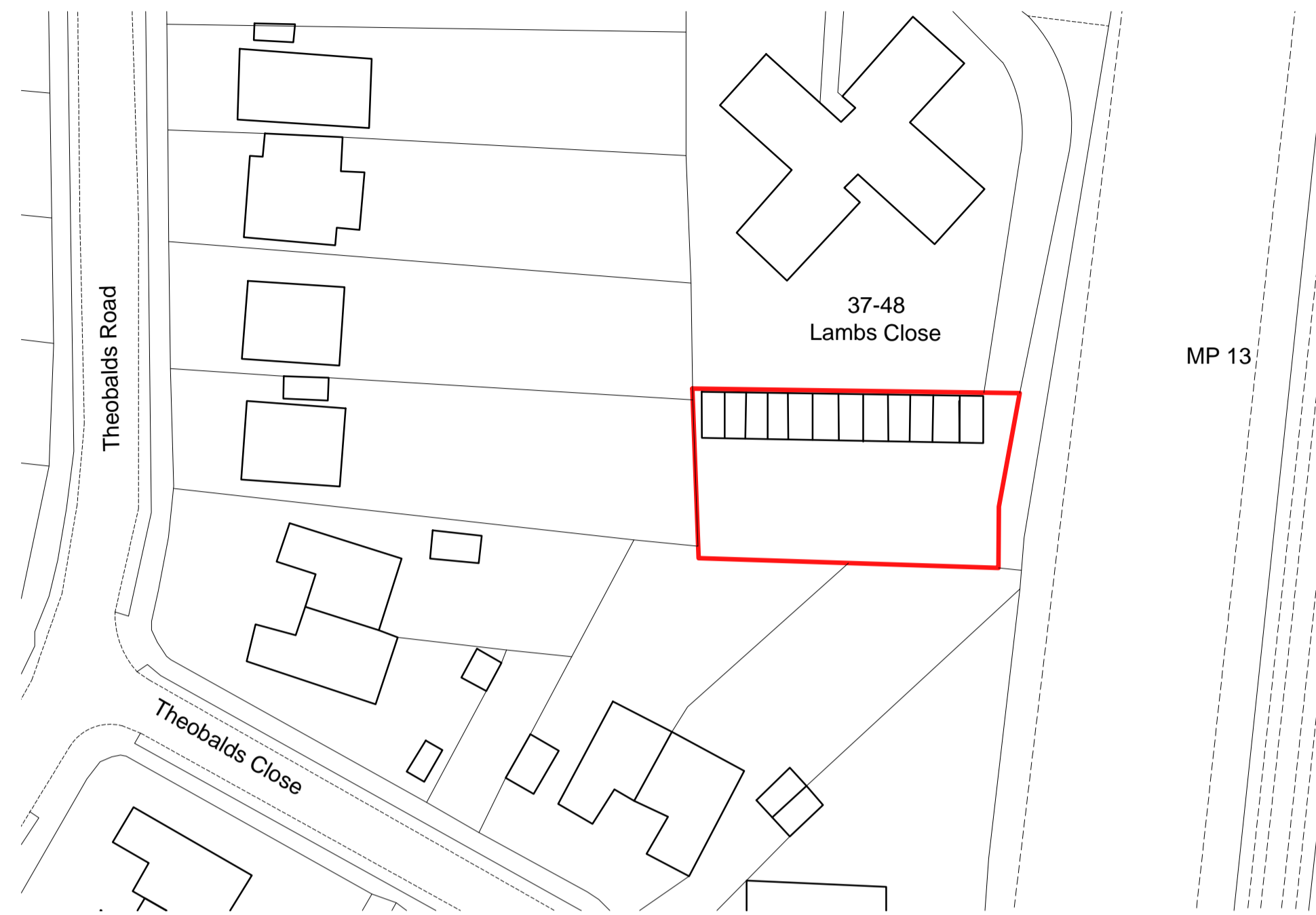

2 Block Plan Existing
1:500

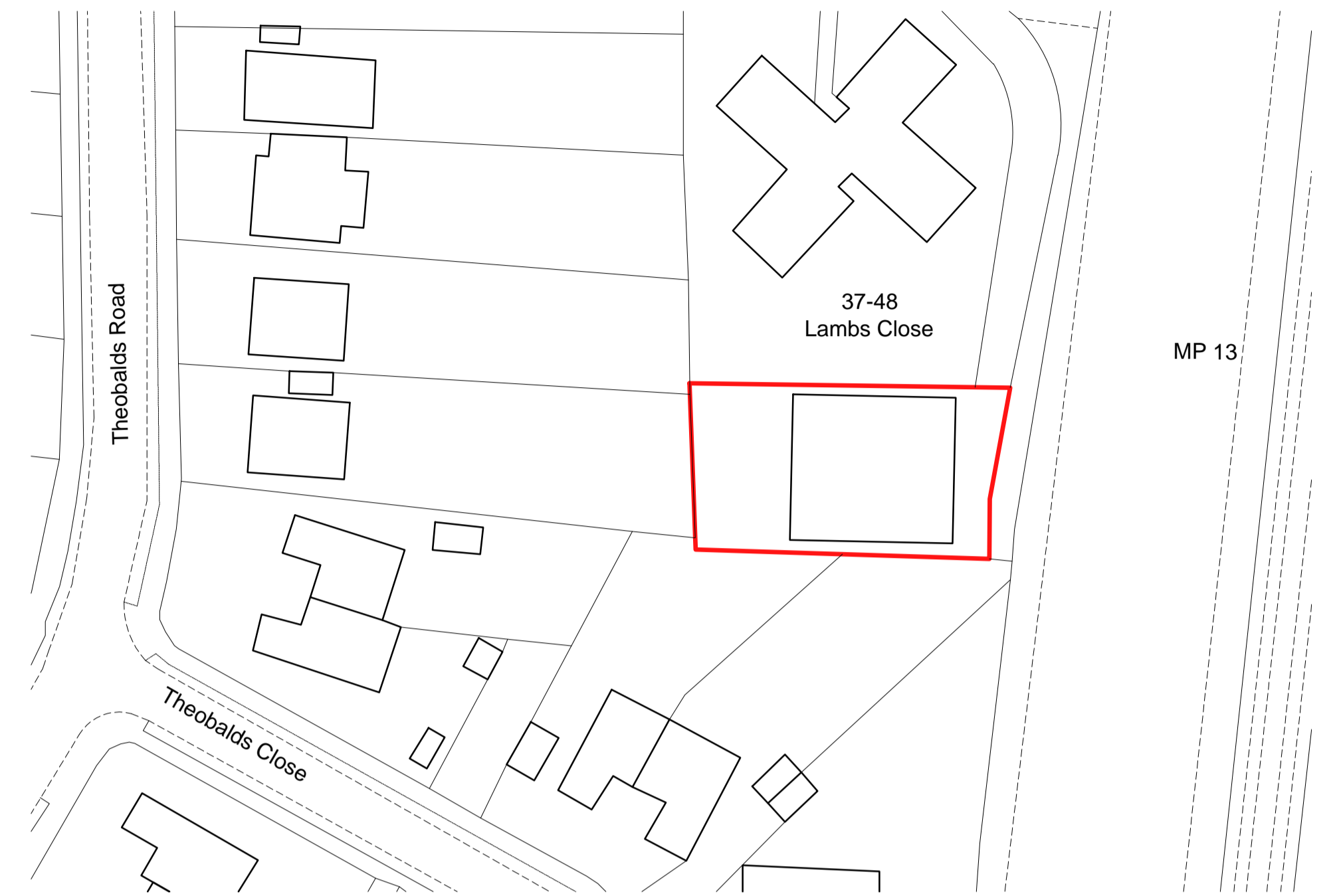

3 Block Plan Proposed
1:500

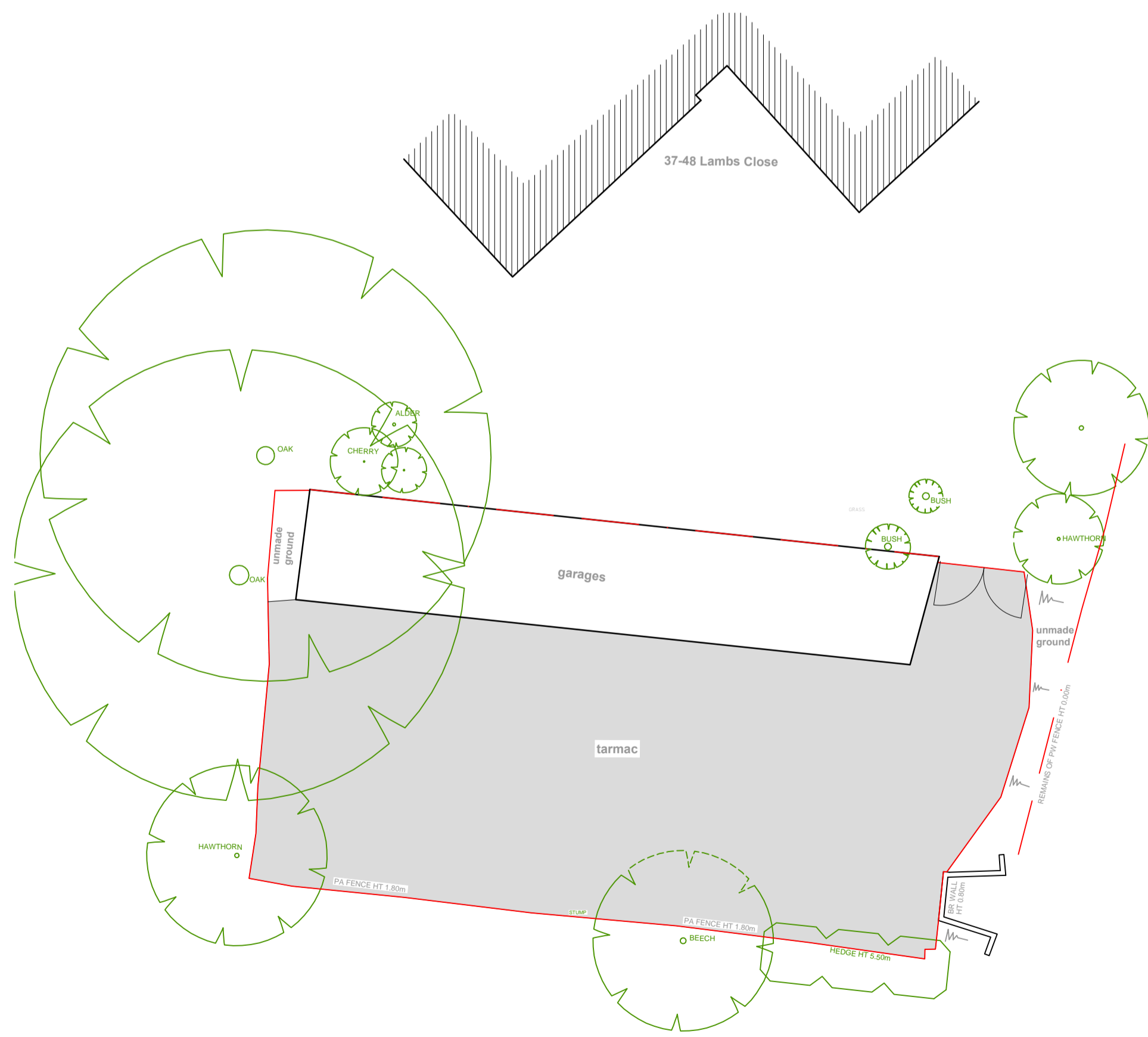

4 Existing Site Plan
1:200

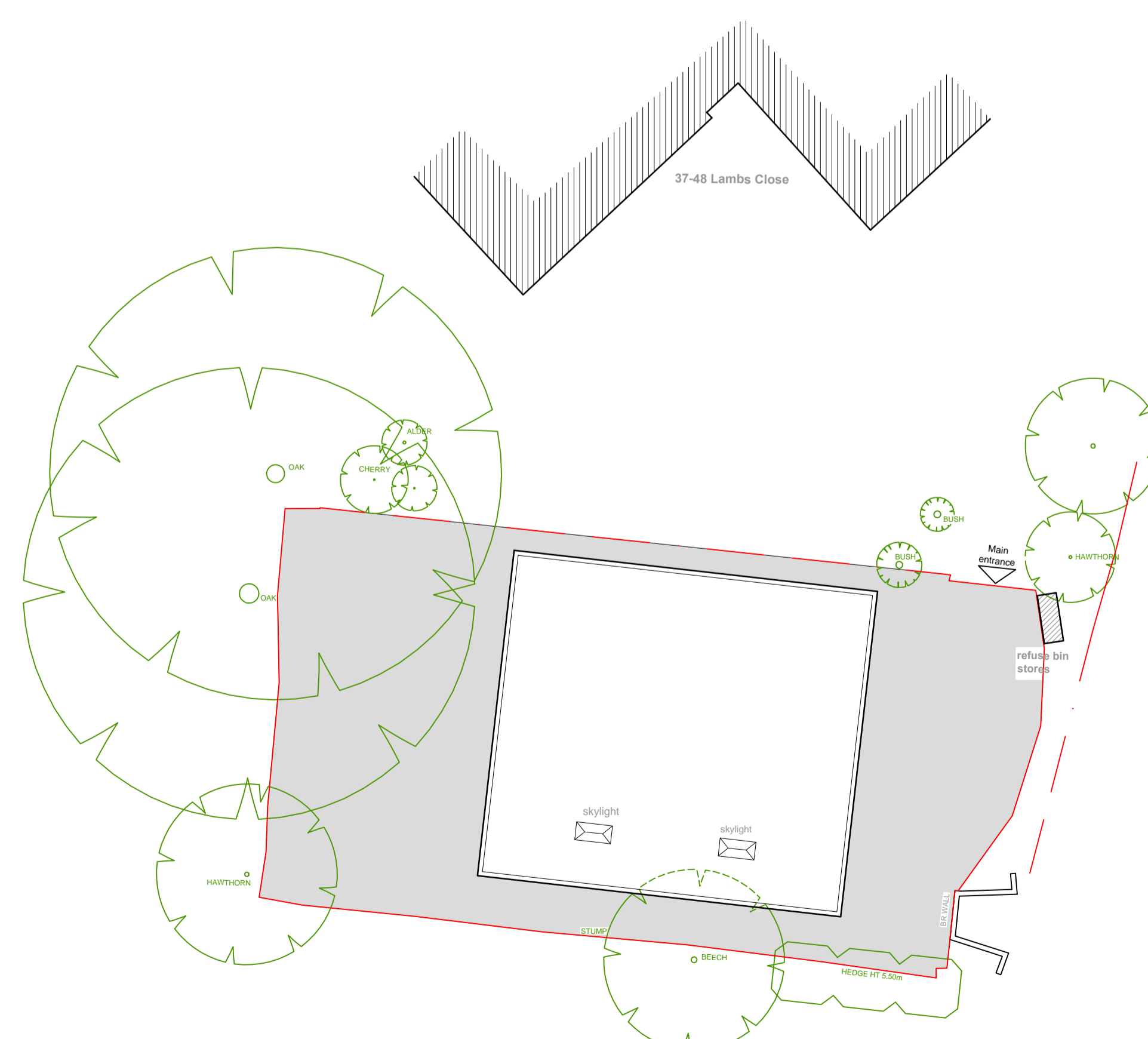

5 Proposed Site Plan - Roof Plan
1:200

dpa ARCHITECTS
INTERIOR DESIGNERS
PARTY WALL SURVEYORS
PLANNING CONSULTANTS

Hertfordshire Office
25 Tudor Hall
Brewery Road
Hoddesdon, Herts
EN11 8FP

London Office
9 Devonshire square
London
EC2M 4YF

RIBA 01992 469001
info@dpa-architects.co.uk
www.dpa-architects.co.uk

Client	Ludgate Property Development Ltd.
Site address	Land Adjacent to Flats at 37-48 aLambs Close Cuffley - Herts EN6 4HQ
Project Description	Demolition of Existing Garages and Erection of Two Flats Together with Parking and the Retention of 21 Existing Spaces of the Flats in Lambs Close
Drawing Title	Location Plan / Block Plan / Site Plan (Existing & Proposed)
Drawn	KI
Checked by	DP
Issued for	Planning Application
Scale	Various@A1
Drawing No.	1139 - 300
Date	20151016
Revisions