

NOTES:  
 Do Not Scale. (except for planning submission)  
 Report all discrepancies, errors and omissions.  
 Verify all dimensions on site before commencing any work on site or preparing shop drawings.  
 All materials, components and workmanship are to comply with the relevant British Standards, Codes of Practice, and appropriate manufacturers recommendations that from time to time shall apply.  
 For all specialist work, see relevant drawings.  
 This drawing and design are copyright of Clague LLP  
 Registration number OC335948.

Rev	Date	Description
A	09/01/17	Notes updated

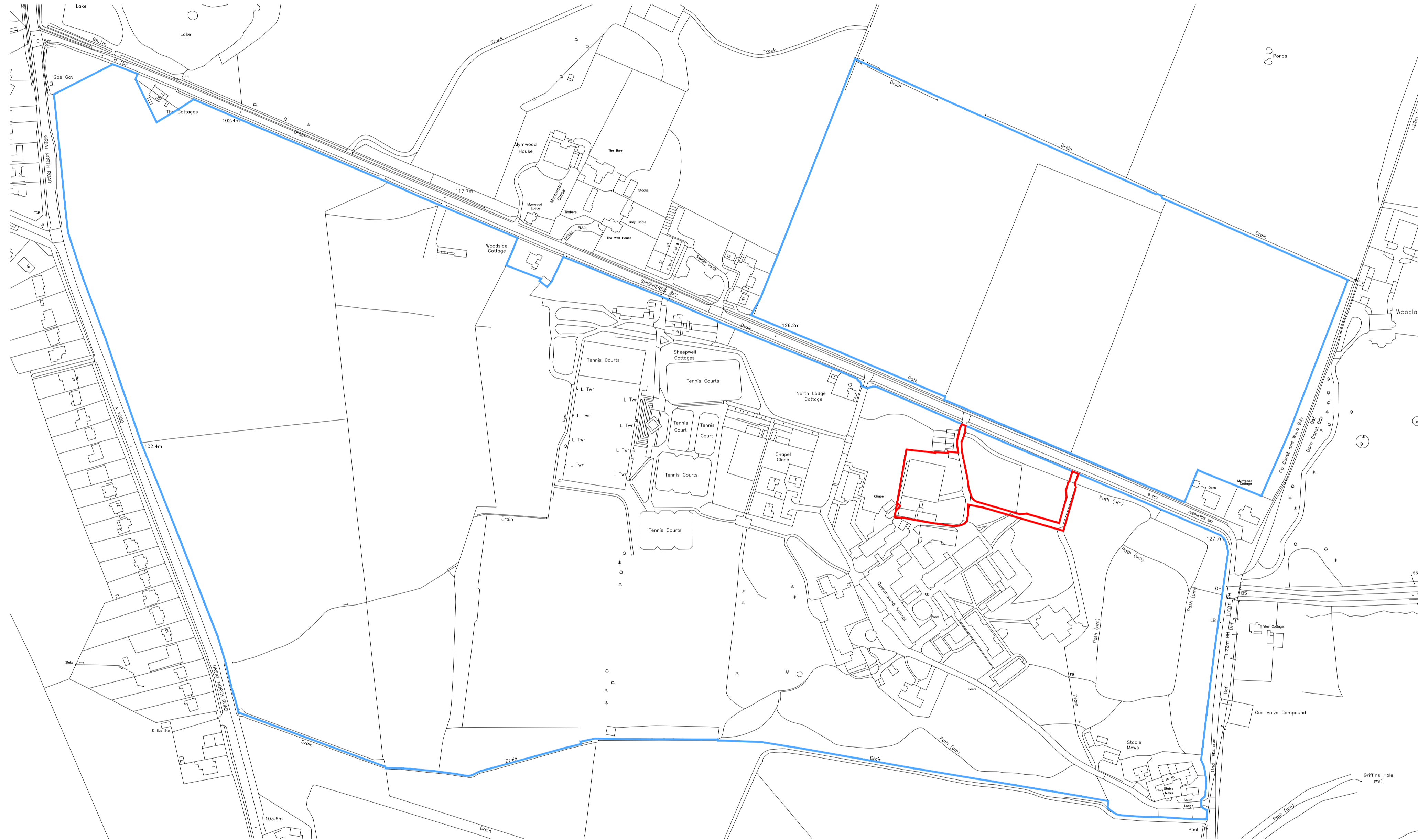

Ordnance Survey (c) Crown Copyright 2016. All rights reserved. Licence number 100022432

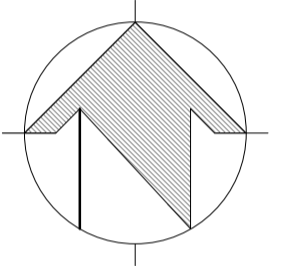

BALL HALL LIMITED  
**Ball Hall**

Project Title  
**Proposed New Sports Hall**  
**Queenswood School**  
**Sheperds Way**  
**Hatfield**  
**Hertfordshire**  
**AL9 6NS**

Drawing Description

**Location Plan**

Scale  
**1:2500 @ A1**  
 Date  
**Jan 2017**  
 Drawn by  
**LB**  
 Checked by

**CLAGUE ARCHITECTS**

62 Burgate, Canterbury  
 Kent CT1 2BH 01227 762060  
 1 Kinsbourne Court, Luton Road,  
 Harpenden, Hertfordshire AL5 3BL 01582 765102  
 4th Floor, 99 Charterhouse Street  
 London EC1M 6HR 0203 597 6112

CANTERBURY LONDON HARPENDEN

Drawing Number  
**22968A / 01**  
 Revision  
**A**