

DO NOT SCALE FROM THIS DRAWING | ALL DIMENSIONS TO BE CHECKED ON SITE | IF DISCREPANCIES OR DOUBT CONTACT DRAWING OFFICE.

COMPLIANCE WITH PLANNING CONSENT & CONDITIONS TO BE RESPONSIBILITY OF MAIN CONTRACTOR | SITE COMPLIANCE WITH BUILDING CONTROL TO BE DUTY OF MAIN CONTRACTOR | BUILDING CONTROL TO ASSESS ALL WORKS ON SITE AND AGREE COMPLIANCE PRIOR TO CONTRACTOR PROGRESSING WORKS.

THIS DRAWING IS ONLY LICENSED FOR THE PURPOSE INDICATED IN THE STATUS BAR.

UNAUTHORISED USE SHOULD BE REPORTED TO THE DRAWING OFFICE AND ANY SUCH USE IS NOT INDEMNIFIED | DRAWINGS TO BE READ IN CONJUNCTION WITH STRUCTURAL ENGINEERS INFORMATION WHEN NECESSARY | CDM 2015 REGULATIONS APPLY, SEE HSE.GOV.UK FOR DETAILS.

REAR

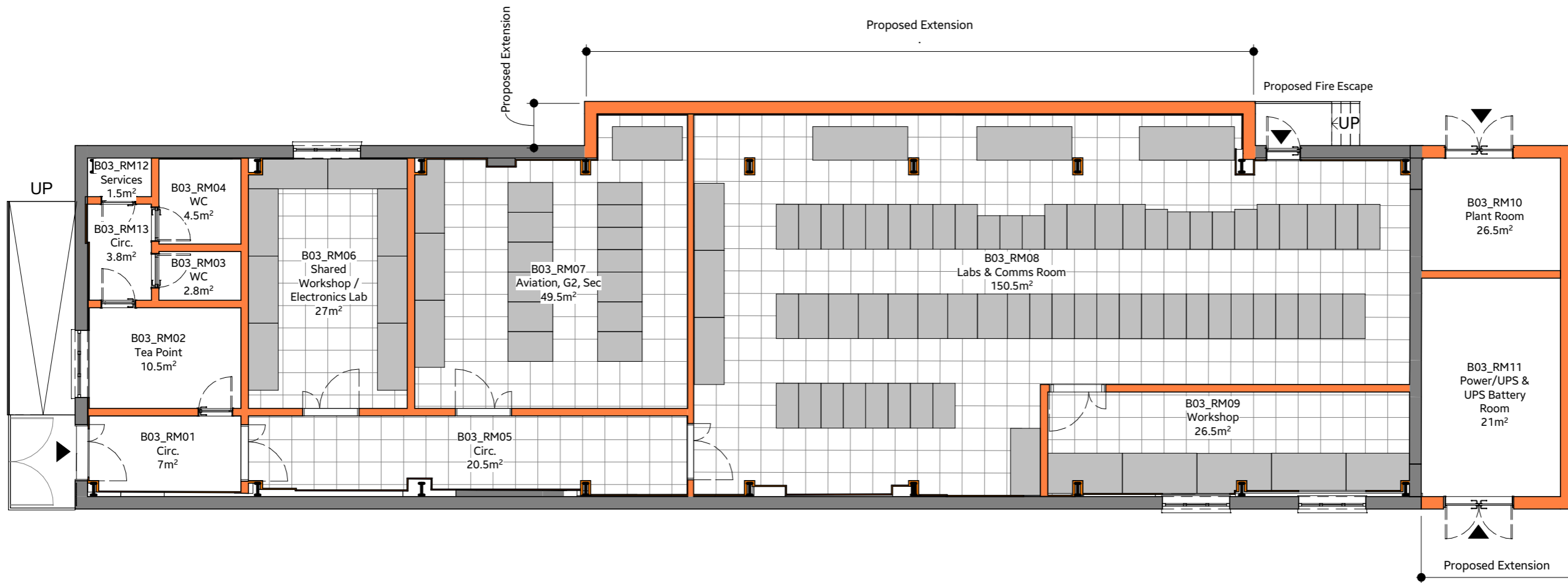

FRONT

Building 3 - Ground Floor Plan Proposed

1 : 125

REV.	DATE	REVISION	DRW.	CHK.
C	23/10/23	PLANNING ISSUE	WS	AD
B	22/09/23	Revisions Following Workshop 3	AM	WS
A	19/09/23	First Issue	AM	WS

made Architects Ltd
 The Stables | 1B Howard Road | Reigate
 w: www.made-architects.com
 e: info@made-architects.com
 t: +44 (0)203 633 4625
 madearchitects_

Client: INMARSAT LTD
 Job: Project Nano
 Address: Transmitting Teleport Station, Great North Rd Hatfield, AL9 6NE
 Drawing: Building 3 - Proposed GA Plan

Scale: As indicated
 Drawn: AM
 Checked: WS
 Date: Oct 2023

PRELIMINARY

Liability to change without notice, not for construction

Size: A3 Drg No. 0112 Rev. C

