

DO NOT SCALE FROM THIS DRAWING | ALL DIMENSIONS TO BE CHECKED ON SITE | IF DISCREPANCIES OR DOUBT CONTACT DRAWING OFFICE.

COMPLIANCE WITH PLANNING CONSENT & CONDITIONS TO BE RESPONSIBILITY OF MAIN CONTRACTOR | SITE COMPLIANCE WITH BUILDING CONTROL TO BE DUTY OF MAIN CONTRACTOR | BUILDING CONTROL TO ASSESS ALL WORKS ON SITE AND AGREE COMPLIANCE PRIOR TO CONTRACTOR PROGRESSING WORKS.

THIS DRAWING IS ONLY LICENSED FOR THE PURPOSE INDICATED IN THE STATUS BAR.

UNAUTHORISED USE SHOULD BE REPORTED TO THE DRAWING OFFICE AND ANY SUCH USE IS NOT INDEMNIFIED | DRAWINGS TO BE READ IN CONJUNCTION WITH STRUCTURAL ENGINEERS INFORMATION WHEN NECESSARY | CDM 2015 REGULATIONS APPLY, SEE HSE.GOV.UK FOR DETAILS.



APPLICATION BOUNDARY

BUILDINGS WITHIN APPLICATION BOUNDARY

BUILDINGS OUTSIDE OF APPLICATION BOUNDARY

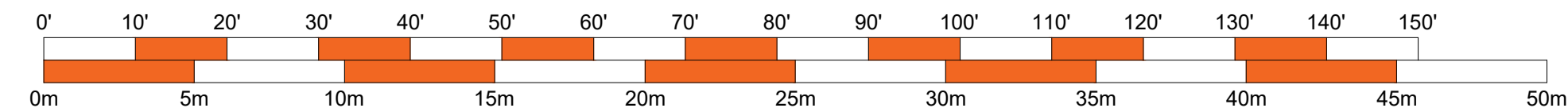
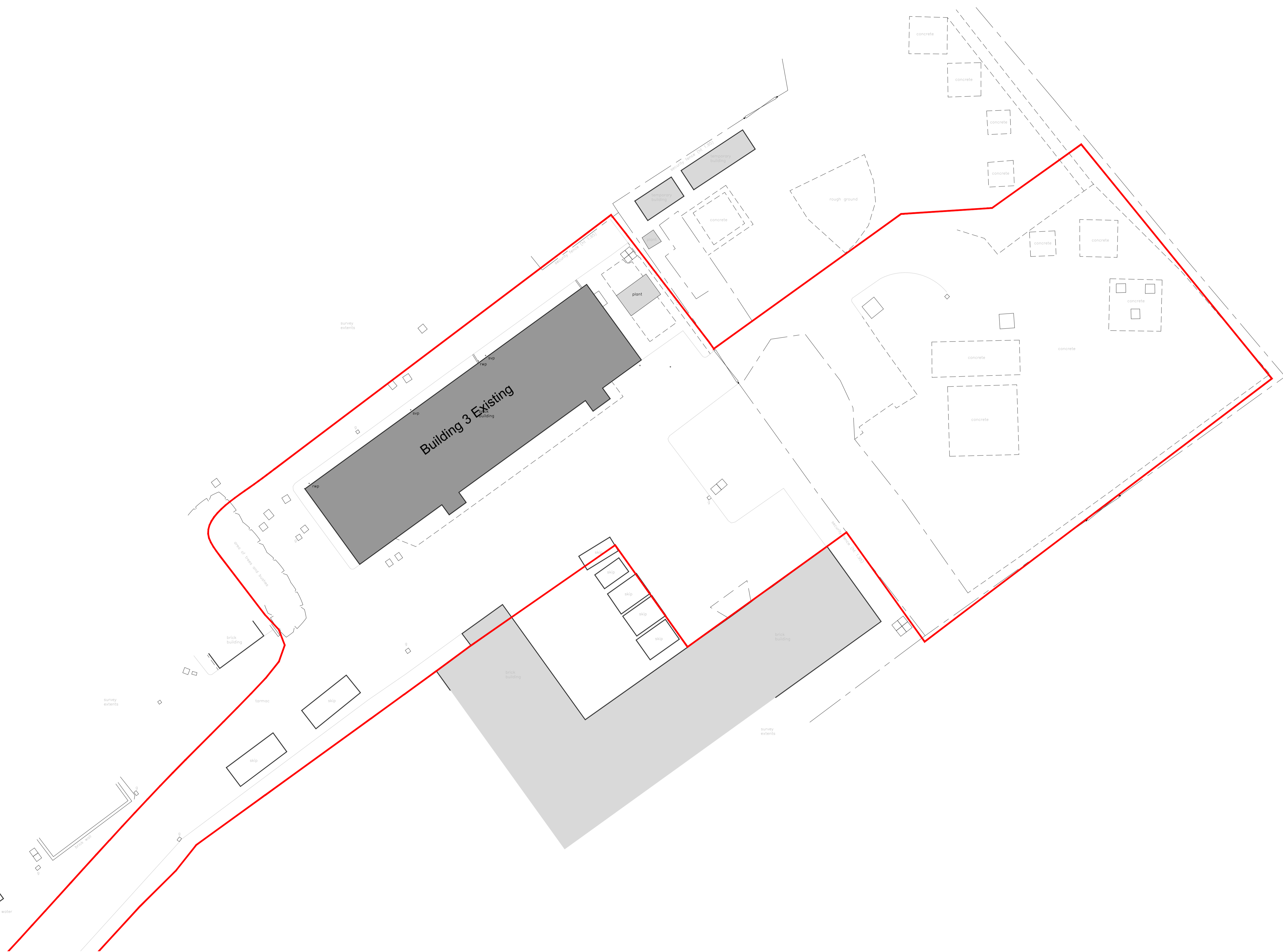

REVISIONS			
REV.	DATE	REVISION	ISSUE
A	31/10/23	PLANNING ISSUE	AM WS
			DRW/CHK



Client: Inmarsat
 Job: Project Nano
 Address: Brookmans Park
 Transmitting Teleport Station, Great North Rd
 Drawing: Existing Site Plan

Scale: 1:200
 Drawn: ABC
 Checked: WS
 Date: 31/10/2023

Size: A1 Dig No: 2296 - 0012 Rev: A