





**NOTES**

1. THIS DRAWING IS TO BE READ IN CONJUNCTION WITH ALL RELEVANT ARCHITECTS, ENGINEERS AND SPECIALIST DRAWINGS AND SPECIFICATIONS
2. DO NOT SCALE FROM THIS DRAWING IN EITHER PAPER OR DIGITAL FORM. USE WRITTEN DIMENSIONS ONLY.
3. DRAWING BASED ON TOPOGRAPHIC SURVEY BY PLOWMAN CRAVEN, REF. 30279T-01, DATED 18/12/2013.

**LEGEND**

-  SITE BOUNDARY
-  MAIN DEMOLITION WORKS
-  PUBLIC VEHICLE PARKING
-  SITE VEHICLE PARKING



VEHICLE BODY ENVELOPE  
 VEHICLE WHEEL SWEEP PATH  
 VEHICLE CHASSIS (SHOWN AT START & END OF PATH AND CHANGE OF DIRECTION)

**VEHICLE PROFILES**

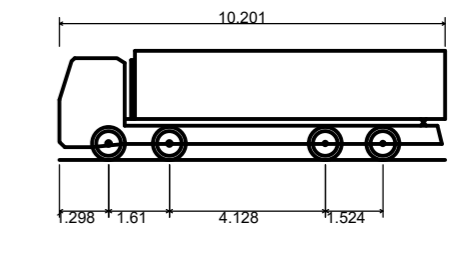

Large Tipper  
 Overall Length 10.201m  
 Overall Width 2.495m  
 Overall Body Height 2.800m  
 Min Body Ground Clearance 0.341m  
 Track Width 2.471m  
 Lock to lock time 6.00s  
 Kerb to Kerb Turning Radius 11.550m

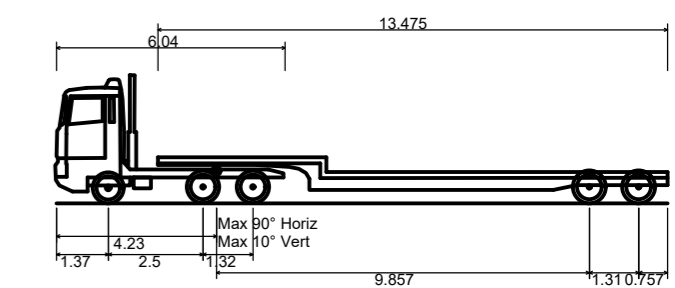

Low Loader  
 Overall Length 16.154m  
 Overall Width 2.520m  
 Overall Body Height 3.383m  
 Min Body Ground Clearance 0.318m  
 Max Track Width 2.500m  
 Lock to lock time 6.00s  
 Kerb to Kerb Turning Radius 6.990m

**KEY PLAN - 1:1000m**

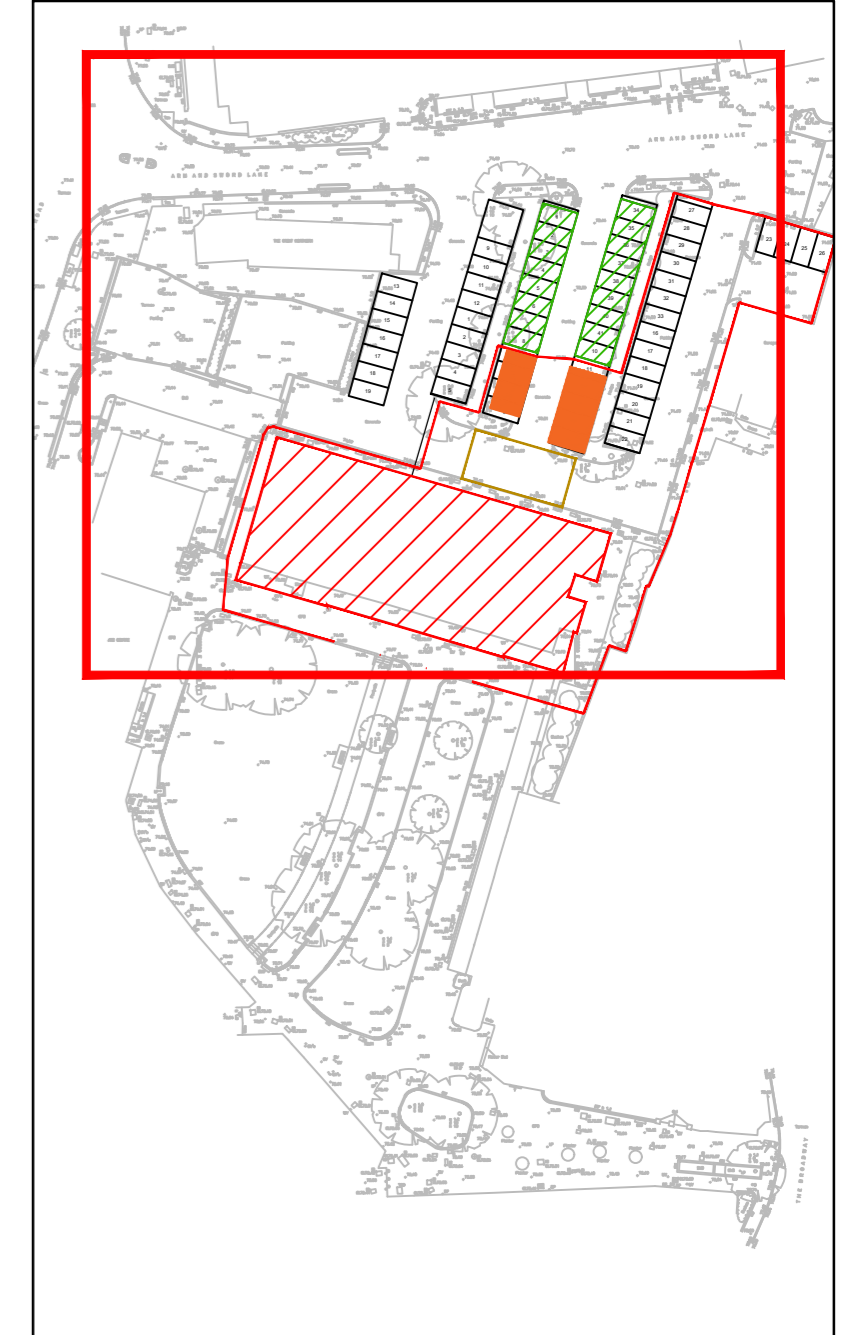

**NOT FOR CONSTRUCTION**

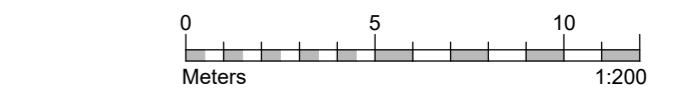

P02 03.07.23	ISSUED FOR PLANNING	JT	AM
P01 27.06.23	STAGE 3 ISSUE	JT	AM
Rev Date	Description	Drawn	Check

**conisbee** Consulting Structural Engineers  
 Consulting Civil Engineers  
 London • Cambridge • Norwich  
 1-5 Offord St London N1 1DH  
 Telephone 020 7700 6666  
 www.conisbee.co.uk

Drawing Status  
**S3 - SUITABLE FOR REVIEW & COMMENT**

Project  
**SALISBURY SQUARE  
 OLD HATFIELD**

Title  
**VEHICLE TRACKING  
 CONSTRUCTION PHASE**

Drawing No  
**221111-CON-XX-00-DR-C-6000**

Date JUN 2023  
 Scale 1:200@A1  
 Drawn JT  
 Engineer AM  
 Project No **221111**  
 Revision **P02**

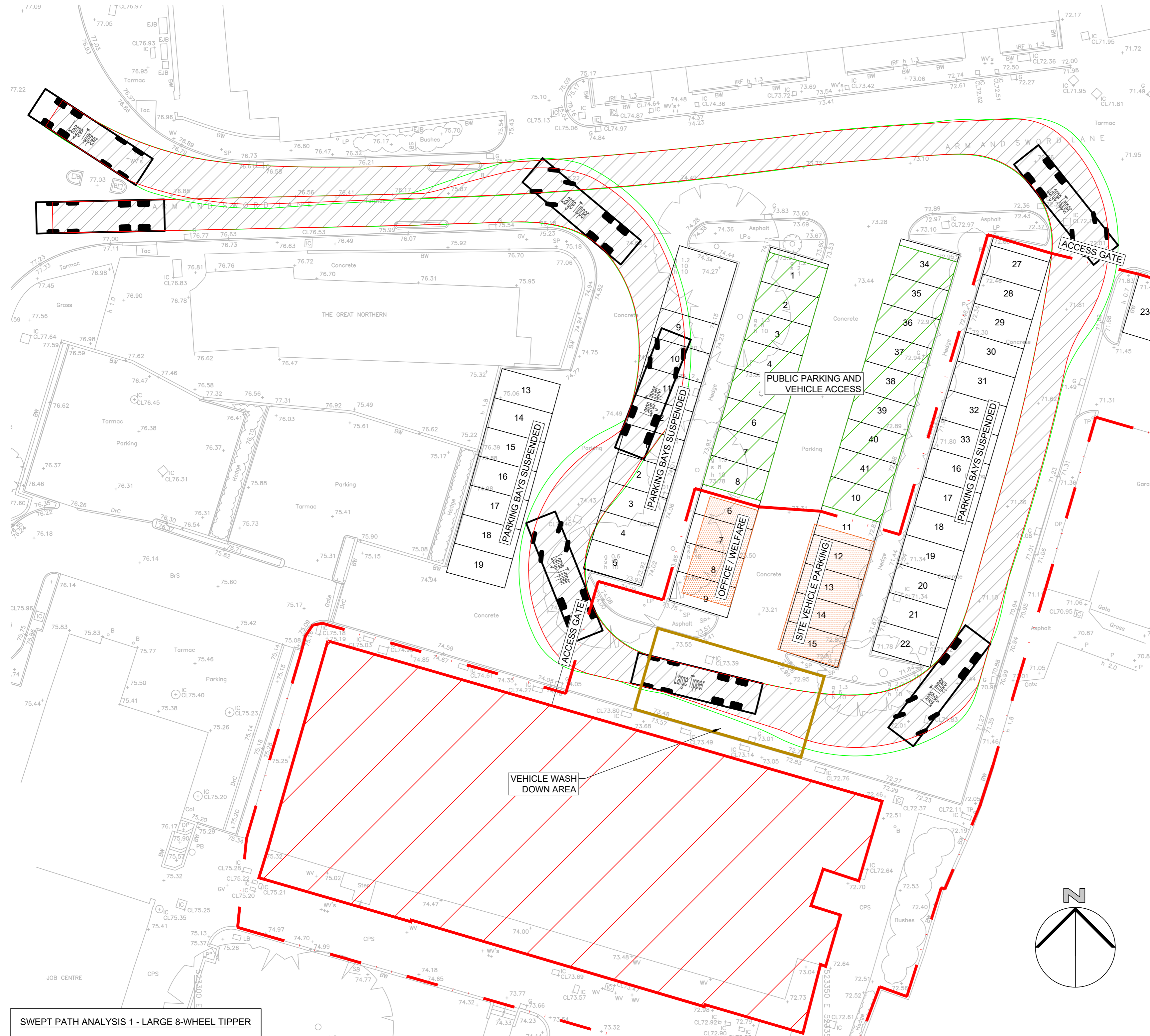

**SWEEP PATH ANALYSIS 1 - LARGE 8-WHEEL TIPPER**

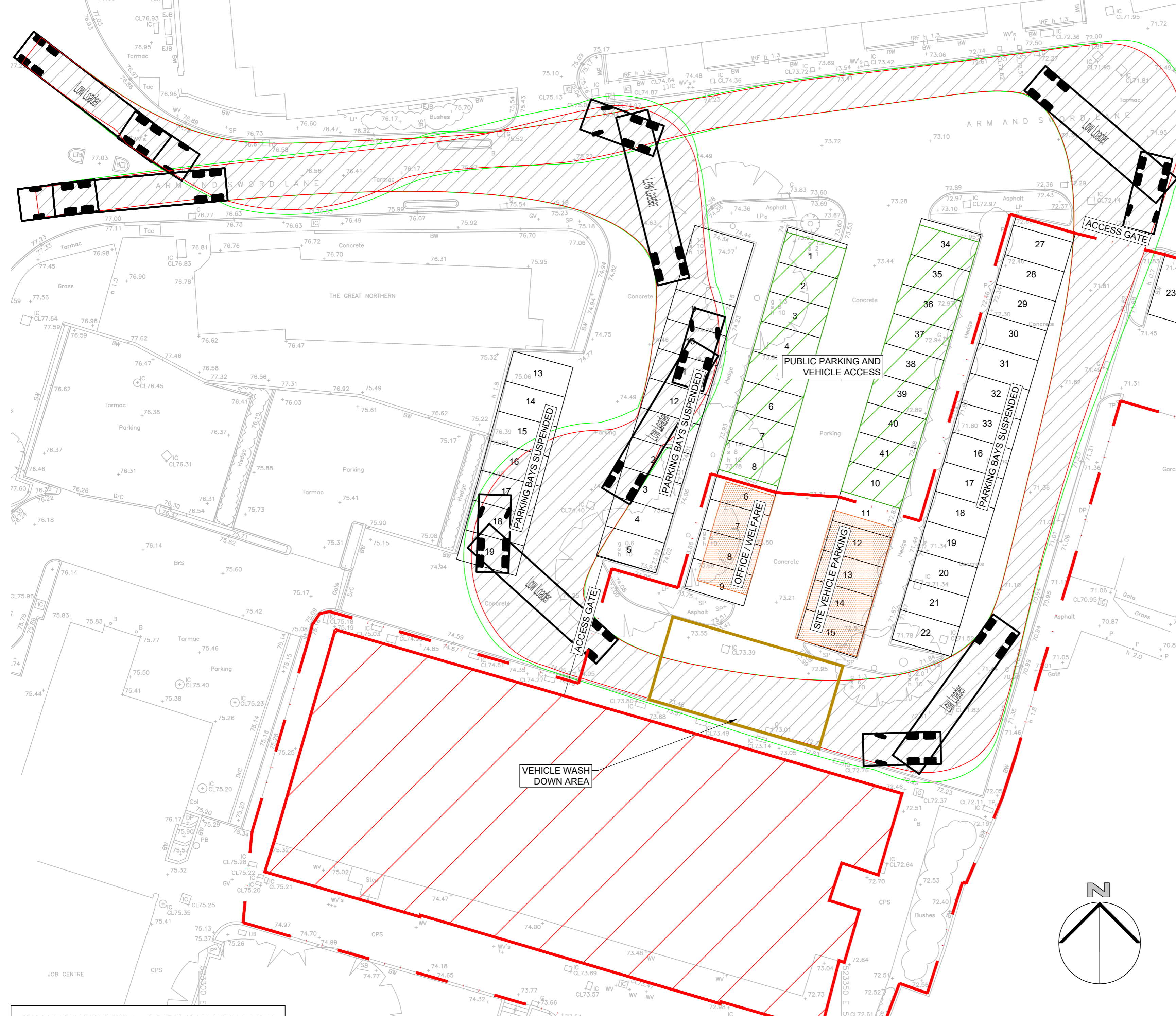

**SWEEP PATH ANALYSIS 2 - ARTICULATED LOW-LOADER**

