

22.034 Cambria. Plot 5610 Hatfield_ External Lighting 221128

Order No.:
Company:
Customer No.:

Date: 28.11.2022
Operator: Arkadiusz Gliszczynski

D&d Building Services Consulting Engineers Ltd
28 Market Place Kegworth
Derby DE74 2EE

Operator Arkadiusz Gliszczynski
Telephone 01509 670 100
Fax
e-Mail arkadiusz.gliszczynski@ddce.co.uk

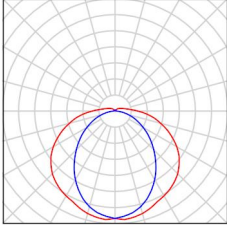

Table of contents

22.034 Cambria. Plot 5610 Hatfield_ External Lighting 221128	
Project Cover	1
Table of contents	2
Luminaire parts list	3
WHITECROFT ACH44K ACL INDUSTRY	
Luminaire Data Sheet	4
Whitecroft Lighting ACH44K ACL Industry	
Luminaire Data Sheet	5
WHITECROFT K6H44KHB KOLO IP65 HOOD	
Luminaire Data Sheet	6
Whitecroft Lighting SIMXH14KGA Sirocco Maxi area optic	
Luminaire Data Sheet	7
Whitecroft Lighting SIMXH24KGA Sirocco Maxi area optic	
Luminaire Data Sheet	8
External Lighting	
Planning data	9
Luminaire parts list	10
Floor plan	11
Luminaires (layout plan)	12
Objects (layout plan)	14
Luminous intensity calculation points (coordinates list)	16
Calculation surfaces (results overview)	18
3D Rendering	19
False Colour Rendering	20
Luminous intensity calculation points	
Luminous intensity calculation point 1	
Summary	21
Luminous intensity calculation point 2	
Summary	25
Luminous intensity calculation point 3	
Summary	29
Luminous intensity calculation point 4	
Summary	33
Luminous intensity calculation point 5	
Summary	37

D&d Building Services Consulting Engineers Ltd
28 Market Place Kegworth
Derby DE74 2EE

Operator Arkadiusz Gliszczynski
Telephone 01509 670 100
Fax
e-Mail arkadiusz.gliszczynski@ddce.co.uk

22.034 Cambria. Plot 5610 Hatfield_ External Lighting 221128 / Luminaire parts list

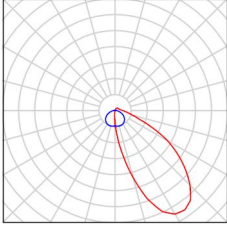
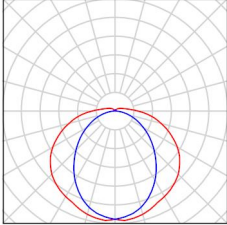
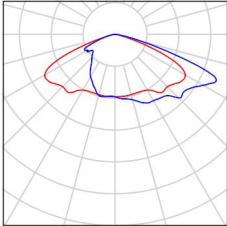
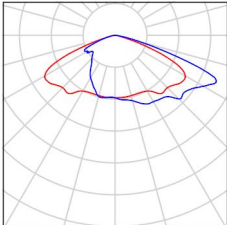
1 Pieces	<p>WHITECROFT ACH44K ACL INDUSTRY Article No.: ACH44K Luminous flux (Luminaire): 4636 lm Luminous flux (Lamps): 4636 lm Luminaire Wattage: 32.1 W Luminaire classification according to CIE: 94 CIE flux code: 41 71 90 94 100 Fitting: 1 x LED (Correction Factor 1.000).</p>		
41 Pieces	<p>WHITECROFT K6H44KHB KOLO IP65 HOOD Article No.: K6H44KHB Luminous flux (Luminaire): 1008 lm Luminous flux (Lamps): 1008 lm Luminaire Wattage: 14.2 W Luminaire classification according to CIE: 93 CIE flux code: 39 76 94 93 100 Fitting: 1 x K6H44KHB (Correction Factor 1.000).</p>		
2 Pieces	<p>Whitecroft Lighting ACH44K ACL Industry Article No.: ACH44K Luminous flux (Luminaire): 4636 lm Luminous flux (Lamps): 4628 lm Luminaire Wattage: 32.1 W Luminaire classification according to CIE: 94 CIE flux code: 41 71 90 94 100 Fitting: 1 x LED (Correction Factor 1.000).</p>	See our luminaire catalog for an image of the luminaire.	
9 Pieces	<p>Whitecroft Lighting SIMXH14KGA Sirocco Maxi area optic Article No.: SIMXH14KGA Luminous flux (Luminaire): 19080 lm Luminous flux (Lamps): 19080 lm Luminaire Wattage: 128.0 W Luminaire classification according to CIE: 100 CIE flux code: 33 68 96 100 100 Fitting: 1 x LED (Correction Factor 1.000).</p>	See our luminaire catalog for an image of the luminaire.	
11 Pieces	<p>Whitecroft Lighting SIMXH24KGA Sirocco Maxi area optic Article No.: SIMXH24KGA Luminous flux (Luminaire): 24627 lm Luminous flux (Lamps): 24627 lm Luminaire Wattage: 160.0 W Luminaire classification according to CIE: 100 CIE flux code: 33 68 96 100 100 Fitting: 1 x LED (Correction Factor 1.000).</p>	See our luminaire catalog for an image of the luminaire.	

D&d Building Services Consulting Engineers Ltd
 28 Market Place Kegworth
 Derby DE74 2EE

Operator Arkadiusz Gliszczynski
 Telephone 01509 670 100
 Fax
 e-Mail arkadiusz.gliszczynski@ddce.co.uk

WHITECROFT ACH44K ACL INDUSTRY / Luminaire Data Sheet

Luminous emittance 1:

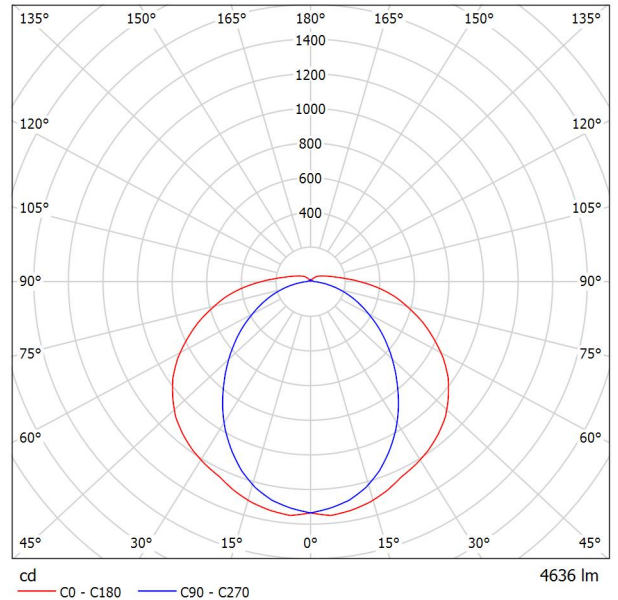

Luminaire classification according to CIE: 94
 CIE flux code: 41 71 90 94 100

ACL INDUSTRY

LED IP66 anti-corrosive luminaire with GRP body with high impact polycarbonate injection moulded opal diffuser. High quality seamless gasket for extreme durability – as Whitecroft Lighting ACL INDUSTRY

Emergency Output: 653lm

Luminous emittance 1:

Glare Evaluation According to UGR											
ρ Ceiling	70	70	50	50	30	70	70	50	50	30	
ρ Walls	50	30	50	30	30	50	30	50	30	30	
ρ Floor	20	20	20	20	20	20	20	20	20	20	
Room Size X Y	Viewing direction at right angles to lamp axis					Viewing direction parallel to lamp axis					
2H	2H	19.2	20.5	19.6	20.9	21.2	16.3	17.6	16.7	18.0	18.4
	3H	21.3	22.6	21.8	22.9	23.4	17.6	18.9	18.1	19.2	19.7
	4H	22.3	23.4	22.7	23.8	24.3	18.2	19.3	18.6	19.7	20.1
	6H	23.2	24.2	23.6	24.7	25.1	18.5	19.6	19.0	20.0	20.5
	8H	23.5	24.6	24.0	25.0	25.5	18.6	19.7	19.1	20.1	20.6
4H	2H	19.5	20.7	20.0	21.1	21.5	17.4	18.5	17.8	18.9	19.4
	3H	22.1	23.0	22.5	23.5	24.0	19.1	20.1	19.6	20.5	21.0
	4H	23.2	24.1	23.7	24.6	25.1	19.7	20.6	20.2	21.1	21.6
	6H	24.3	25.0	24.8	25.5	26.1	20.1	20.9	20.7	21.4	22.0
	8H	24.7	25.5	25.3	26.0	26.5	20.3	21.0	20.8	21.5	22.1
8H	2H	25.2	25.8	25.7	26.4	26.9	20.4	21.1	20.9	21.6	22.2
	4H	23.4	24.2	24.0	24.7	25.2	20.6	21.3	21.1	21.8	22.3
	6H	24.7	25.3	25.3	25.9	26.5	21.2	21.8	21.8	22.4	23.0
	8H	25.4	25.9	25.9	26.4	27.1	21.5	22.0	22.0	22.5	23.2
	12H	25.9	26.4	26.5	27.0	27.6	21.6	22.1	22.2	22.7	23.3
12H	4H	23.4	24.1	24.0	24.6	25.2	20.7	21.4	21.3	21.9	22.5
	6H	24.8	25.3	25.4	25.9	26.5	21.5	22.1	22.1	22.6	23.2
	8H	25.5	26.0	26.1	26.5	27.2	21.9	22.3	22.5	22.9	23.6
Variation of the observer position for the luminaire distances S											
S = 1.0H	+0.1 / -0.1					+0.1 / -0.1					
S = 1.5H	+0.2 / -0.2					+0.3 / -0.4					
S = 2.0H	+0.3 / -0.4					+0.5 / -0.7					
Standard table	BK09					BK06					
Correction Summand	4.0					-0.8					
Corrected Glare Indices referring to 4636lm Total Luminous Flux											

D&d Building Services Consulting Engineers Ltd
 28 Market Place Kegworth
 Derby DE74 2EE

Operator Arkadiusz Gliszczynski
 Telephone 01509 670 100
 Fax
 e-Mail arkadiusz.gliszczynski@ddce.co.uk

Whitecroft Lighting ACH44K ACL Industry / Luminaire Data Sheet

Luminous emittance 1:

See our luminaire catalog for an image of the luminaire.

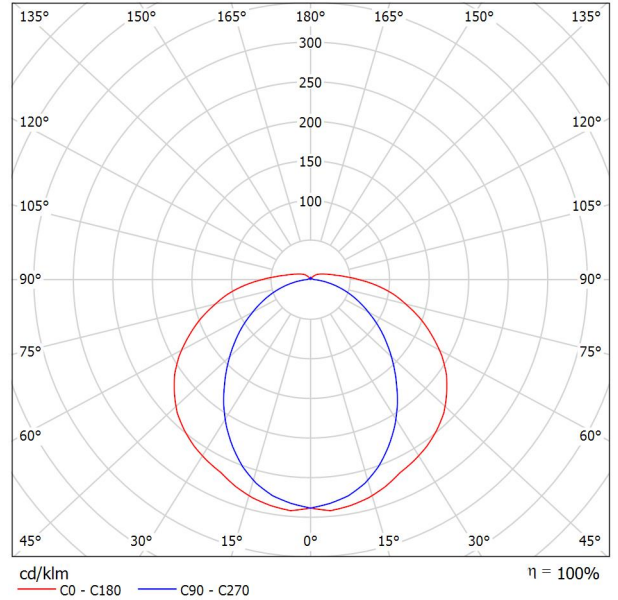

Luminaire classification according to CIE: 94
 CIE flux code: 41 71 90 94 100

Luminous emittance 1:

Glare Evaluation According to UGR											
ρ Ceiling	70	70	50	50	30	70	70	50	50	30	
ρ Walls	50	30	50	30	30	50	30	50	30	30	
ρ Floor	20	20	20	20	20	20	20	20	20	20	
Room Size X Y	Viewing direction at right angles to lamp axis					Viewing direction parallel to lamp axis					
2H	2H	19.2	20.5	19.6	20.9	21.2	16.3	17.6	16.7	18.0	18.4
	3H	21.3	22.6	21.8	22.9	23.4	17.6	18.9	18.1	19.2	19.7
	4H	22.3	23.4	22.7	23.8	24.3	18.2	19.3	18.6	19.7	20.1
	6H	23.2	24.2	23.6	24.7	25.1	18.5	19.6	19.0	20.0	20.5
	8H	23.5	24.6	24.0	25.0	25.5	18.6	19.7	19.1	20.1	20.6
4H	2H	19.5	20.7	20.0	21.1	21.5	17.4	18.5	17.8	18.9	19.4
	3H	22.1	23.0	22.5	23.5	24.0	19.1	20.1	19.6	20.5	21.0
	4H	23.2	24.1	23.7	24.6	25.1	19.7	20.6	20.2	21.1	21.6
	6H	24.3	25.0	24.8	25.5	26.1	20.1	20.9	20.7	21.4	22.0
	8H	24.7	25.5	25.3	26.0	26.5	20.3	21.0	20.8	21.5	22.1
8H	2H	25.2	25.8	25.7	26.4	26.9	20.4	21.1	20.9	21.6	22.2
	4H	23.4	24.2	24.0	24.7	25.2	20.6	21.3	21.1	21.8	22.3
	6H	24.7	25.3	25.3	25.9	26.5	21.2	21.8	21.8	22.4	23.0
	8H	25.4	25.9	25.9	26.4	27.1	21.5	22.0	22.0	22.5	23.2
	12H	25.9	26.4	26.5	27.0	27.6	21.6	22.1	22.2	22.7	23.3
12H	4H	23.4	24.1	24.0	24.6	25.2	20.7	21.4	21.3	21.9	22.5
	6H	24.8	25.3	25.4	25.9	26.5	21.5	22.1	22.1	22.6	23.2
	8H	25.5	26.0	26.1	26.5	27.2	21.9	22.3	22.5	22.9	23.6
Variation of the observer position for the luminaire distances S											
S = 1.0H	+0.1 / -0.1					+0.1 / -0.1					
S = 1.5H	+0.2 / -0.2					+0.3 / -0.4					
S = 2.0H	+0.3 / -0.4					+0.5 / -0.7					
Standard table	BK09					BK06					
Correction Summand	4.1					-0.8					
Corrected Glare Indices referring to 4628lm Total Luminous Flux											

D&d Building Services Consulting Engineers Ltd
 28 Market Place Kegworth
 Derby DE74 2EE

Operator Arkadiusz Gliszczynski
 Telephone 01509 670 100
 Fax
 e-Mail arkadiusz.gliszczynski@ddce.co.uk

WHITECROFT K6H44KHB KOLO IP65 HOOD / Luminaire Data Sheet

Luminous emittance 1:

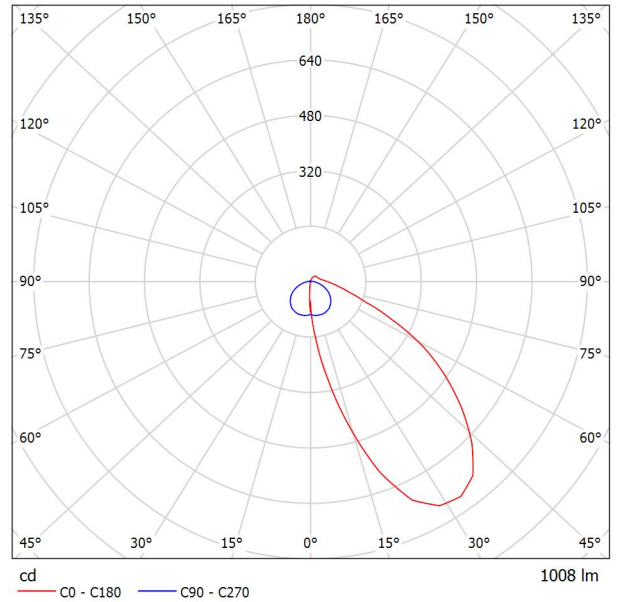

Luminaire classification according to CIE: 93
 CIE flux code: 39 76 94 93 100

Surface mounted circular IP65 LED bulkhead luminaire in 400mm diameter.
 Polycarbonate opal diffuser. Supplied with trim ring –
 as Whitecroft Lighting KOLO IP65 HOOD

Due to missing symmetry properties, no UGR table
 can be displayed for this luminaire.

D&d Building Services Consulting Engineers Ltd
28 Market Place Kegworth
Derby DE74 2EE

Operator Arkadiusz Gliszczynski
Telephone 01509 670 100
Fax
e-Mail arkadiusz.gliszczynski@ddce.co.uk

Whitecroft Lighting SIMXH14KGA Sirocco Maxi area optic / Luminaire Data Sheet

Luminous emittance 1:

See our luminaire catalog for an image of the luminaire.

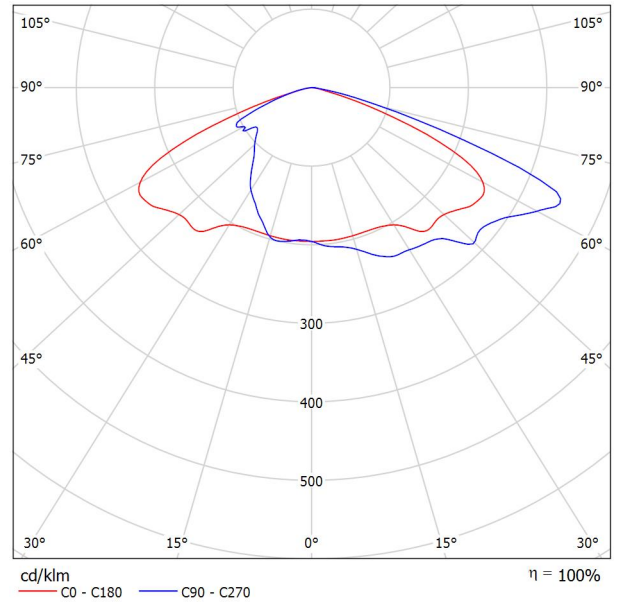

Luminaire classification according to CIE: 100
CIE flux code: 33 68 96 100 100

Due to missing symmetry properties, no UGR table can be displayed for this luminaire.

D&d Building Services Consulting Engineers Ltd
28 Market Place Kegworth
Derby DE74 2EE

Operator Arkadiusz Gliszczynski
Telephone 01509 670 100
Fax
e-Mail arkadiusz.gliszczynski@ddce.co.uk

Whitecroft Lighting SIMXH24KGA Sirocco Maxi area optic / Luminaire Data Sheet

Luminous emittance 1:

See our luminaire catalog for an image of the luminaire.

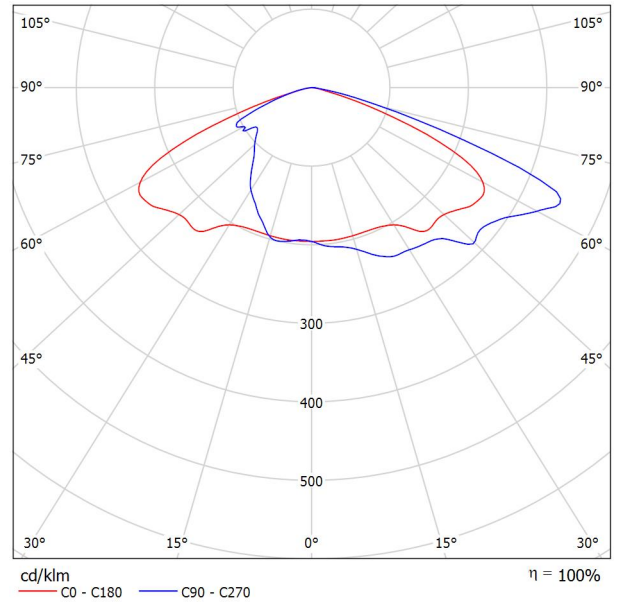

Luminaire classification according to CIE: 100
CIE flux code: 33 68 96 100 100

Due to missing symmetry properties, no UGR table can be displayed for this luminaire.

D&d Building Services Consulting Engineers Ltd
 28 Market Place Kegworth
 Derby DE74 2EE

Operator Arkadiusz Gliszczynski
 Telephone 01509 670 100
 Fax
 e-Mail arkadiusz.gliszczynski@ddce.co.uk

External Lighting / Planning data

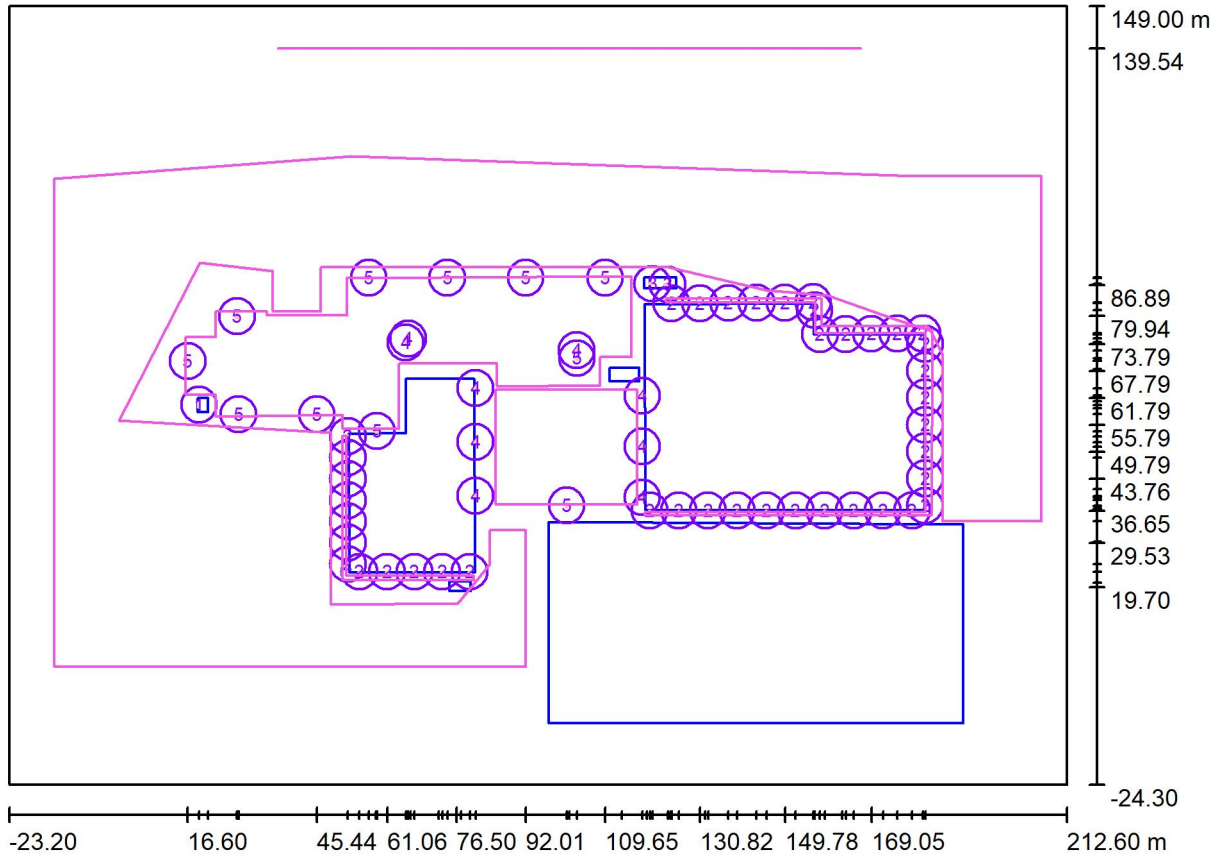

Maintenance factor: 0.67, ULR (Upward Light Ratio): 0.5%

Scale 1:1686



Luminaire Parts List

No.	Pieces	Designation (Correction Factor)	Φ (Luminaire) [lm]	Φ (Lamps) [lm]	P [W]
1	1	WHITECROFT ACH44K ACL INDUSTRY (1.000)	4636	4636	32.1
2	41	WHITECROFT K6H44KHB KOLO IP65 HOOD (1.000)	1008	1008	14.2
3	2	Whitecroft Lighting ACH44K ACL Industry (1.000)	4636	4628	32.1
4	9	Whitecroft Lighting SIMXH14KGA Sirocco Maxi area optic (1.000)	19080	19080	128.0
5	11	Whitecroft Lighting SIMXH24KGA Sirocco Maxi area optic (1.000)	24627	24627	160.0
Total:			497849	497837	3590.5

D&d Building Services Consulting Engineers Ltd
28 Market Place Kegworth
Derby DE74 2EE

Operator Arkadiusz Gliszczynski
Telephone 01509 670 100
Fax
e-Mail arkadiusz.gliszczynski@ddce.co.uk

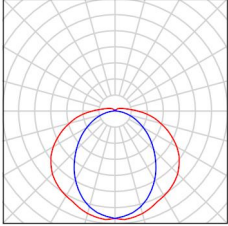
External Lighting / Luminaire parts list

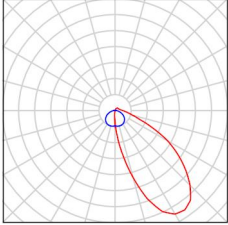
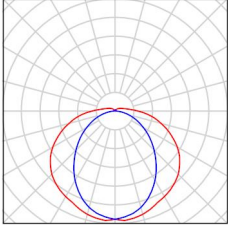
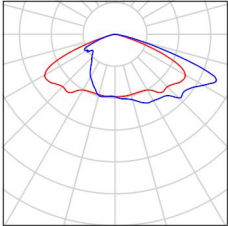
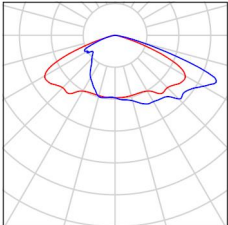
1 Pieces	<p>WHITECROFT ACH44K ACL INDUSTRY Article No.: ACH44K Luminous flux (Luminaire): 4636 lm Luminous flux (Lamps): 4636 lm Luminaire Wattage: 32.1 W Luminaire classification according to CIE: 94 CIE flux code: 41 71 90 94 100 Fitting: 1 x LED (Correction Factor 1.000).</p>		
41 Pieces	<p>WHITECROFT K6H44KHB KOLO IP65 HOOD Article No.: K6H44KHB Luminous flux (Luminaire): 1008 lm Luminous flux (Lamps): 1008 lm Luminaire Wattage: 14.2 W Luminaire classification according to CIE: 93 CIE flux code: 39 76 94 93 100 Fitting: 1 x K6H44KHB (Correction Factor 1.000).</p>		
2 Pieces	<p>Whitcroft Lighting ACH44K ACL Industry Article No.: ACH44K Luminous flux (Luminaire): 4636 lm Luminous flux (Lamps): 4628 lm Luminaire Wattage: 32.1 W Luminaire classification according to CIE: 94 CIE flux code: 41 71 90 94 100 Fitting: 1 x LED (Correction Factor 1.000).</p>	See our luminaire catalog for an image of the luminaire.	
9 Pieces	<p>Whitcroft Lighting SIMXH14KGA Sirocco Maxi area optic Article No.: SIMXH14KGA Luminous flux (Luminaire): 19080 lm Luminous flux (Lamps): 19080 lm Luminaire Wattage: 128.0 W Luminaire classification according to CIE: 100 CIE flux code: 33 68 96 100 100 Fitting: 1 x LED (Correction Factor 1.000).</p>	See our luminaire catalog for an image of the luminaire.	
11 Pieces	<p>Whitcroft Lighting SIMXH24KGA Sirocco Maxi area optic Article No.: SIMXH24KGA Luminous flux (Luminaire): 24627 lm Luminous flux (Lamps): 24627 lm Luminaire Wattage: 160.0 W Luminaire classification according to CIE: 100 CIE flux code: 33 68 96 100 100 Fitting: 1 x LED (Correction Factor 1.000).</p>	See our luminaire catalog for an image of the luminaire.	

D&d Building Services Consulting Engineers Ltd

28 Market Place Kegworth
Derby DE74 2EE

Operator Arkadiusz Gliszczynski
Telephone 01509 670 100
Fax
e-Mail arkadiusz.gliszczynski@ddce.co.uk

External Lighting / Floor plan

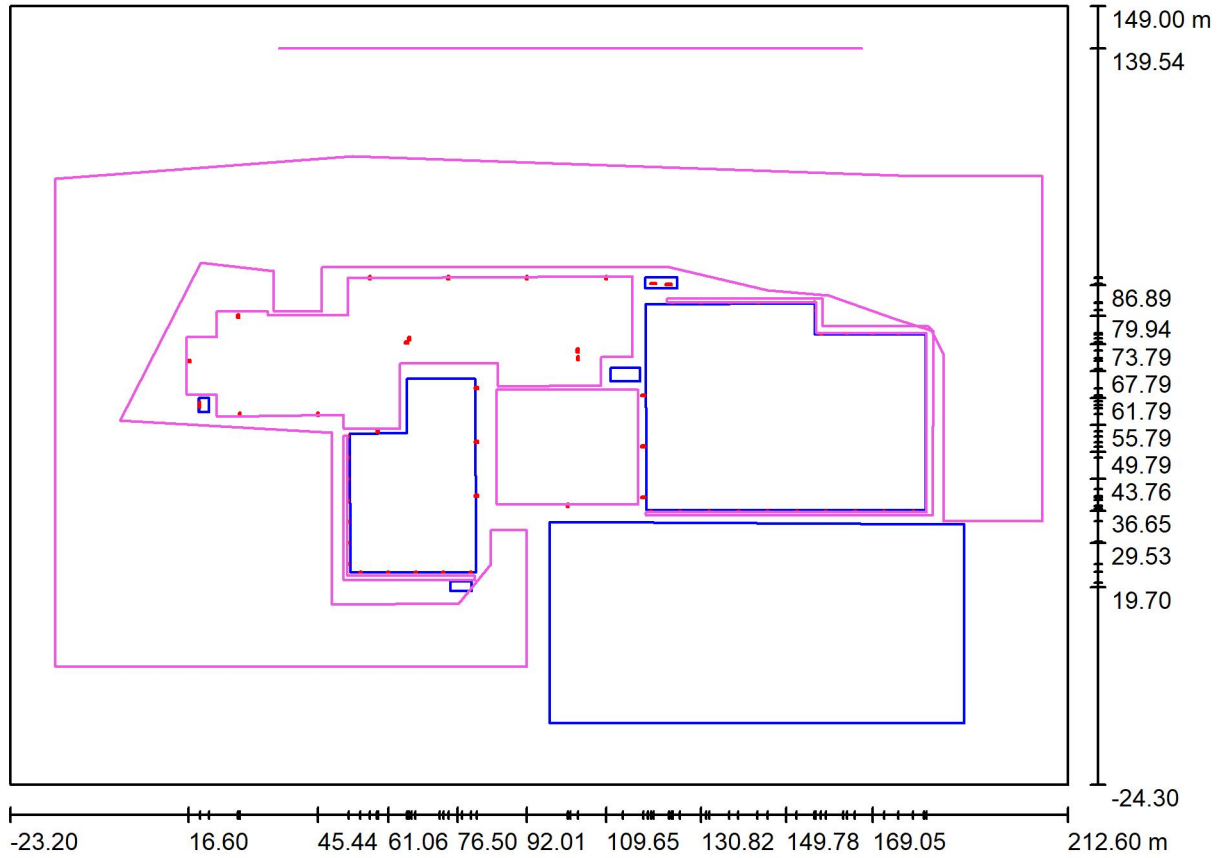

Scale 1 : 1686

D&d Building Services Consulting Engineers Ltd
 28 Market Place Kegworth
 Derby DE74 2EE

Operator Arkadiusz Gliszczynski
 Telephone 01509 670 100
 Fax
 e-Mail arkadiusz.gliszczynski@ddce.co.uk

External Lighting / Luminaires (layout plan)

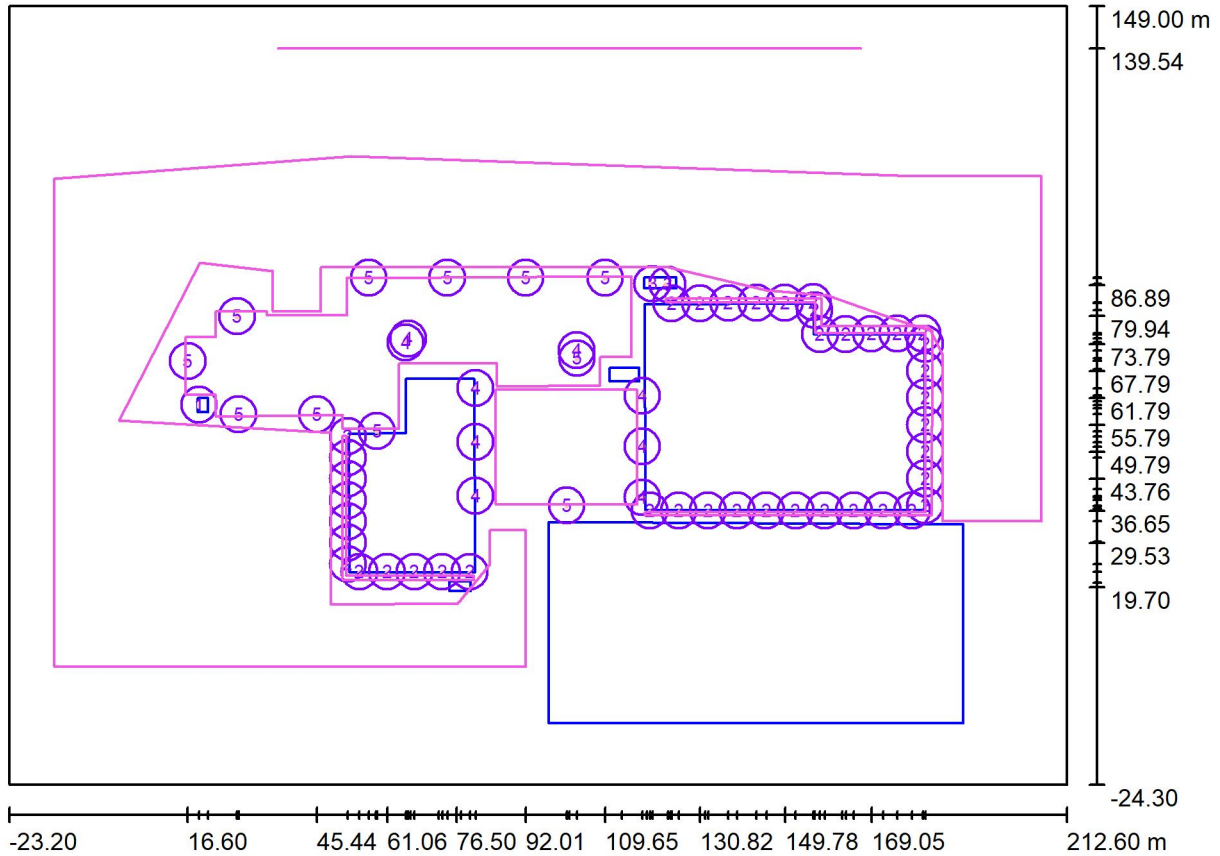

Scale 1 : 1686

Luminaire Parts List

No.	Pieces	Designation
1	1	WHITECROFT ACH44K ACL INDUSTRY
2	41	WHITECROFT K6H44KHB KOLO IP65 HOOD
3	2	Whitecroft Lighting ACH44K ACL Industry
4	9	Whitecroft Lighting SIMXH14KGA Sirocco Maxi area optic

D&d Building Services Consulting Engineers Ltd
28 Market Place Kegworth
Derby DE74 2EE

Operator Arkadiusz Gliszczynski
Telephone 01509 670 100
Fax
e-Mail arkadiusz.gliszczynski@ddce.co.uk

External Lighting / Luminaires (layout plan)

Luminaire Parts List

No.	Pieces	Designation
5	11	Whitecroft Lighting SIMXH24KGA Sirocco Maxi area optic

D&d Building Services Consulting Engineers Ltd
 28 Market Place Kegworth
 Derby DE74 2EE

Operator Arkadiusz Gliszczynski
 Telephone 01509 670 100
 Fax
 e-Mail arkadiusz.gliszczynski@ddce.co.uk

External Lighting / Objects (layout plan)

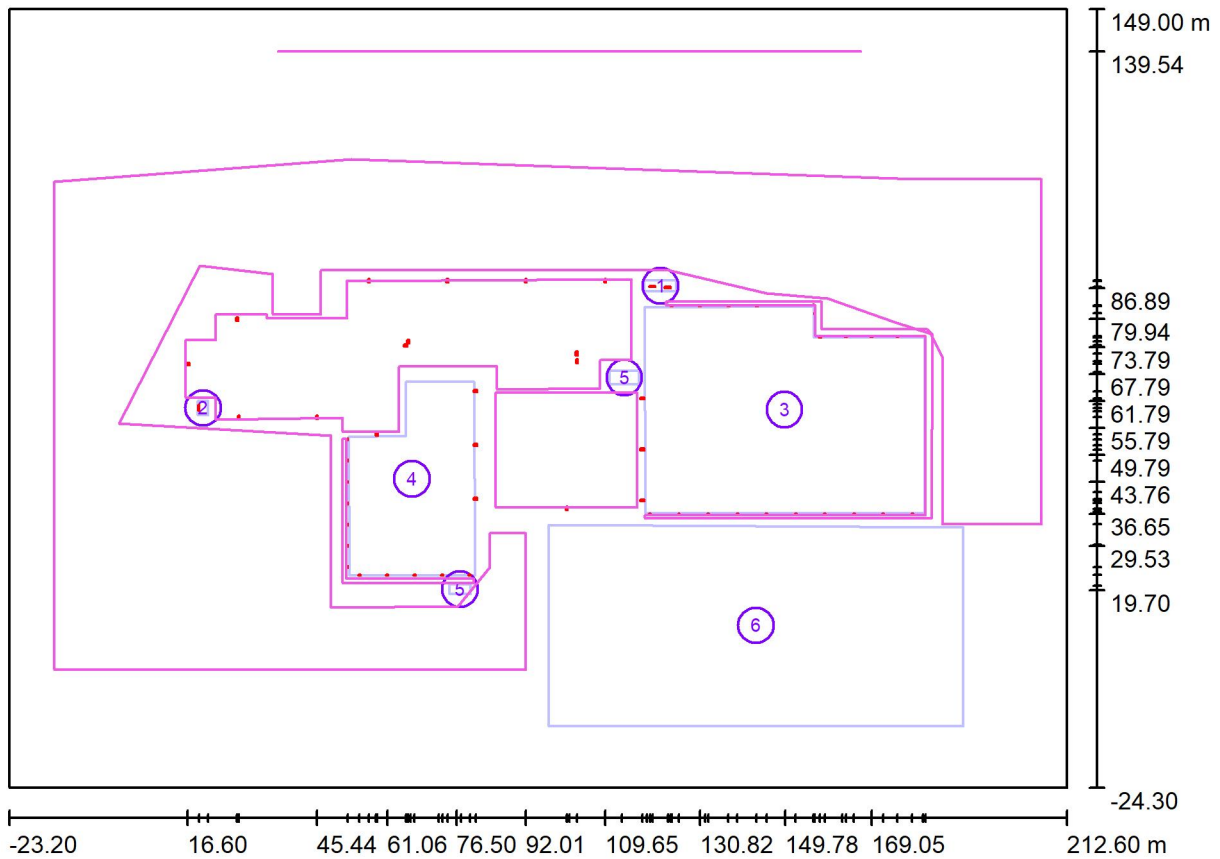

Scale 1 : 1686

Object parts list

No.	Pieces	Designation
1	1	Bike store
2	1	Bin store
3	1	Building A
4	1	Building B

D&d Building Services Consulting Engineers Ltd
28 Market Place Kegworth
Derby DE74 2EE

Operator Arkadiusz Gliszczynski
Telephone 01509 670 100
Fax
e-Mail arkadiusz.gliszczynski@ddce.co.uk

External Lighting / Objects (layout plan)

Object parts list

No.	Pieces	Designation
5	2	Plant bldg
6	1	Toolbank

D&d Building Services Consulting Engineers Ltd
 28 Market Place Kegworth
 Derby DE74 2EE

Operator Arkadiusz Gliszczynski
 Telephone 01509 670 100
 Fax
 e-Mail arkadiusz.gliszczynski@ddce.co.uk

External Lighting / Luminous intensity calculation points (coordinates list)

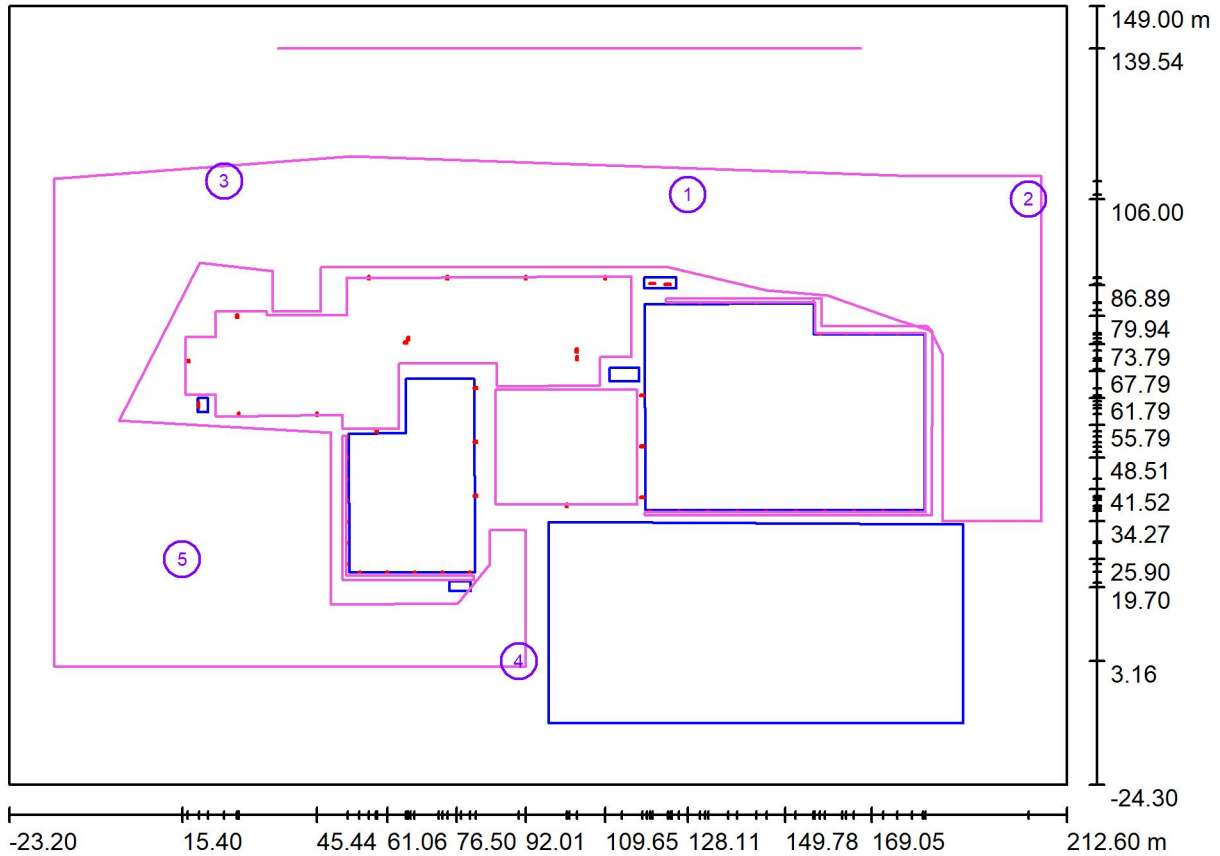

Scale 1 : 1686

List of the luminous intensity calculation points

No.	Designation	Position [m]		
		X	Y	Z
1	Luminous intensity calculation point 1	128.106	107.000	1.700
2	Luminous intensity calculation point 2	204.100	106.000	1.700
3	Luminous intensity calculation point 3	24.792	110.010	1.700
4	Luminous intensity calculation point 4	90.452	3.161	1.700

D&d Building Services Consulting Engineers Ltd
28 Market Place Kegworth
Derby DE74 2EE

Operator Arkadiusz Gliszczynski
Telephone 01509 670 100
Fax
e-Mail arkadiusz.gliszczynski@ddce.co.uk

External Lighting / Luminous intensity calculation points (coordinates list)

List of the luminous intensity calculation points

No.	Designation	Position [m]		
		X	Y	Z
5	Luminous intensity calculation point 5	15.400	25.900	1.700

D&d Building Services Consulting Engineers Ltd
 28 Market Place Kegworth
 Derby DE74 2EE

Operator Arkadiusz Gliszczynski
 Telephone 01509 670 100
 Fax
 e-Mail arkadiusz.gliszczynski@ddce.co.uk

External Lighting / Calculation surfaces (results overview)

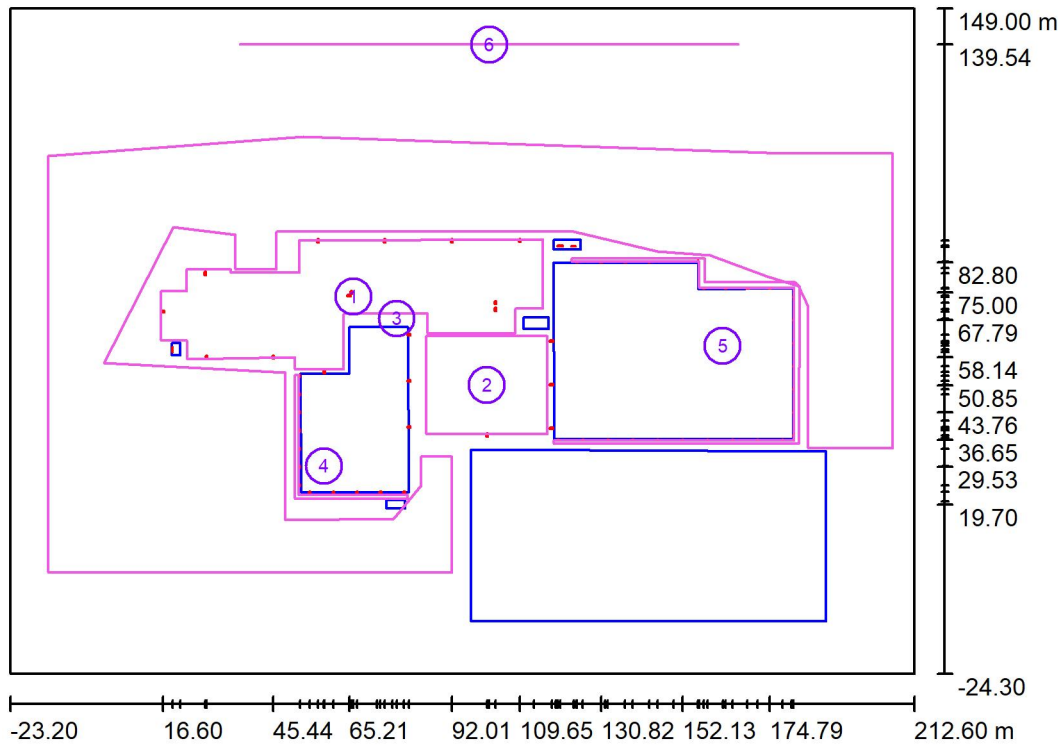

Scale 1 : 1972

Calculation Surface List

No.	Designation	Type	Grid	E_{av} [lx]	E_{min} [lx]	E_{max} [lx]	u0	E_{min} / E_{max}
1	Car Park & vehicle turning area	perpendicular	128 x 128	53	22	81	0.418	0.270
2	Vehicle Turning Area	perpendicular	64 x 64	53	37	86	0.688	0.426
3	Spill lighting	perpendicular	128 x 128	3.49	0.02	49	0.006	0.000
4	Path 2_amenity lighting _ Building B	perpendicular	128 x 128	35	11	76	0.323	0.148
5	Path 1_amenity lighting_Building A	perpendicular	128 x 128	26	6.61	80	0.256	0.083
6	Intrusive lighting on the premises	perpendicular	32 x 2	0.68	0.33	0.97	0.483	0.338

Summary of Results

Type	Quantity	Average [lx]	Min [lx]	Max [lx]	u0	E_{min} / E_{max}
perpendicular	6	13	0.02	86	0.00	0.00

D&d Building Services Consulting Engineers Ltd

28 Market Place Kegworth
Derby DE74 2EE

Operator Arkadiusz Gliszczynski
Telephone 01509 670 100
Fax
e-Mail arkadiusz.gliszczynski@ddce.co.uk

External Lighting / 3D Rendering

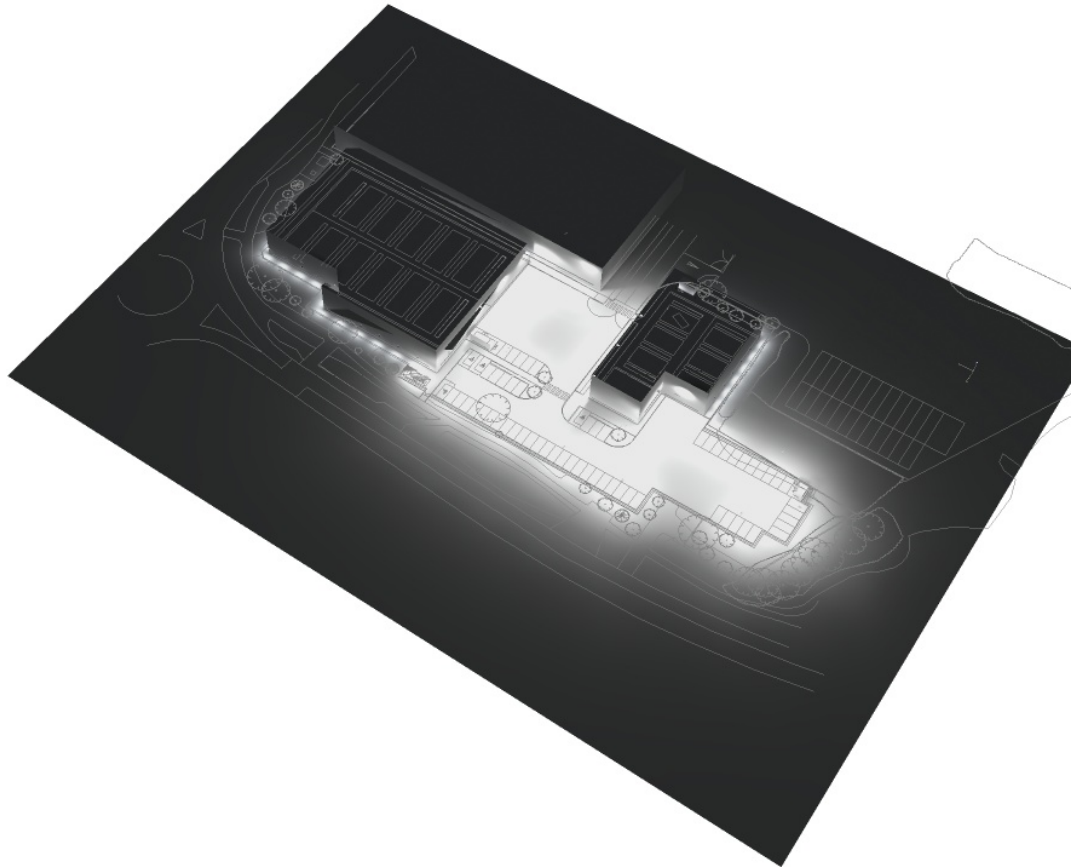

D&d Building Services Consulting Engineers Ltd

28 Market Place Kegworth
Derby DE74 2EE

Operator Arkadiusz Gliszczynski
Telephone 01509 670 100
Fax
e-Mail arkadiusz.gliszczynski@ddce.co.uk

External Lighting / False Colour Rendering

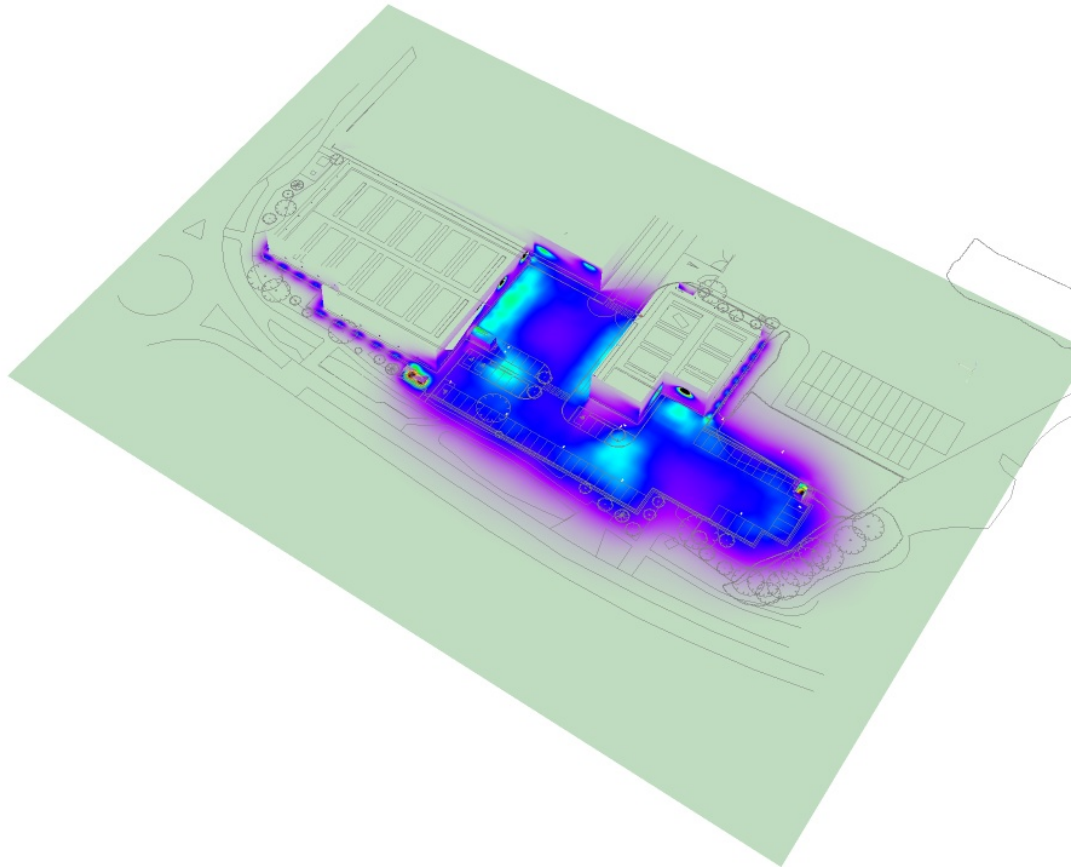

1 25.88 50.75 75.63 100.50 125.38 150.25 175.13 200

lx

D&d Building Services Consulting Engineers Ltd
28 Market Place Kegworth
Derby DE74 2EE

Operator Arkadiusz Gliszczynski
Telephone 01509 670 100
Fax
e-Mail arkadiusz.gliszczynski@ddce.co.uk

External Lighting / Luminous intensity calculation point 1 / Summary

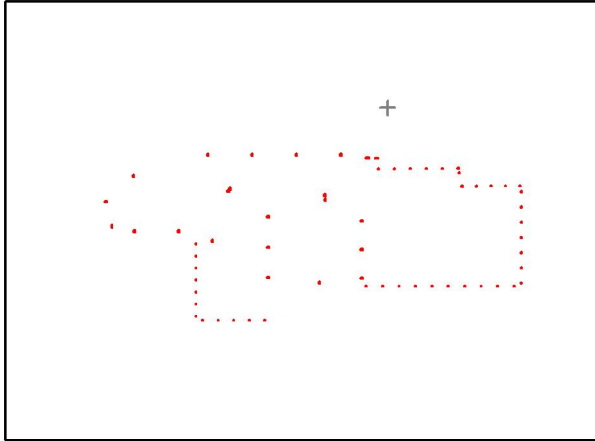

Position: (128.106 m, 107.000 m, 1.700 m)

Possible interference sources

No.	Luminaire	Position [m]			Luminous emittance	Luminous intensity [cd]
		X	Y	Z		
1	Whitecroft Lighting SIMXH14KGA Sirocco Maxi area optic	117.963	39.619	7.500	Luminous emittance 1	0
2	Whitecroft Lighting SIMXH14KGA Sirocco Maxi area optic	117.963	50.958	7.500	Luminous emittance 1	0
3	Whitecroft Lighting SIMXH14KGA Sirocco Maxi area optic	117.963	62.296	7.500	Luminous emittance 1	0
4	Whitecroft Lighting SIMXH14KGA Sirocco Maxi area optic	80.802	63.942	7.500	Luminous emittance 1	128
5	Whitecroft Lighting SIMXH14KGA Sirocco Maxi area optic	80.802	51.942	7.500	Luminous emittance 1	105
6	Whitecroft Lighting SIMXH14KGA Sirocco Maxi area optic	80.802	39.942	7.500	Luminous emittance 1	70
7	Whitecroft Lighting SIMXH24KGA Sirocco Maxi area optic	101.139	37.817	10.000	Luminous emittance 1	0
8	Whitecroft Lighting SIMXH24KGA Sirocco Maxi area optic	103.387	70.594	10.000	Luminous emittance 1	414
9	Whitecroft Lighting SIMXH24KGA Sirocco Maxi area optic	27.962	58.137	10.000	Luminous emittance 1	87
10	Whitecroft Lighting SIMXH24KGA Sirocco Maxi area optic	45.437	58.137	10.000	Luminous emittance 1	146
11	Whitecroft Lighting SIMXH14KGA Sirocco Maxi area optic	103.347	72.342	10.000	Luminous emittance 1	927
12	WHITECROFT K6H44KHB KOLO IP65 HOOD	124.498	82.803	2.500	Luminous emittance 1	35
13	WHITECROFT K6H44KHB KOLO IP65 HOOD	130.819	82.850	2.500	Luminous emittance 1	36
14	WHITECROFT K6H44KHB KOLO IP65 HOOD	137.139	82.897	2.500	Luminous emittance 1	37
15	WHITECROFT K6H44KHB KOLO IP65 HOOD	143.459	82.944	2.500	Luminous emittance 1	41

D&d Building Services Consulting Engineers Ltd
28 Market Place Kegworth
Derby DE74 2EE

Operator Arkadiusz Gliszczynski
Telephone 01509 670 100
Fax
e-Mail arkadiusz.gliszczynski@ddce.co.uk

External Lighting / Luminous intensity calculation point 1 / Summary

Possible interference sources

No.	Luminaire	Position [m]			Luminous emittance	Luminous intensity [cd]
		X	Y	Z		
16	WHITECROFT K6H44KHB KOLO IP65 HOOD	149.779	82.991	2.500	Luminous emittance 1	40
17	WHITECROFT K6H44KHB KOLO IP65 HOOD	156.099	83.038	2.500	Luminous emittance 1	39
18	WHITECROFT K6H44KHB KOLO IP65 HOOD	157.584	75.937	2.500	Luminous emittance 1	0
19	WHITECROFT K6H44KHB KOLO IP65 HOOD	163.318	75.982	2.500	Luminous emittance 1	0
20	WHITECROFT K6H44KHB KOLO IP65 HOOD	169.052	76.027	2.500	Luminous emittance 1	38
21	WHITECROFT K6H44KHB KOLO IP65 HOOD	174.786	76.072	2.500	Luminous emittance 1	37
22	WHITECROFT K6H44KHB KOLO IP65 HOOD	180.520	76.117	2.500	Luminous emittance 1	37
23	WHITECROFT K6H44KHB KOLO IP65 HOOD	156.400	81.300	2.500	Luminous emittance 1	0
24	WHITECROFT K6H44KHB KOLO IP65 HOOD	181.043	73.792	2.500	Luminous emittance 1	0
25	WHITECROFT K6H44KHB KOLO IP65 HOOD	181.039	67.792	2.500	Luminous emittance 1	0
26	WHITECROFT K6H44KHB KOLO IP65 HOOD	181.036	61.792	2.500	Luminous emittance 1	0
27	WHITECROFT K6H44KHB KOLO IP65 HOOD	181.032	55.792	2.500	Luminous emittance 1	0
28	WHITECROFT K6H44KHB KOLO IP65 HOOD	181.028	49.792	2.500	Luminous emittance 1	0
29	WHITECROFT K6H44KHB KOLO IP65 HOOD	181.024	43.792	2.500	Luminous emittance 1	0
30	WHITECROFT K6H44KHB KOLO IP65 HOOD	181.020	37.792	2.500	Luminous emittance 1	0
31	WHITECROFT K6H44KHB KOLO IP65 HOOD	52.330	24.783	2.500	Luminous emittance 1	0
32	WHITECROFT K6H44KHB KOLO IP65 HOOD	52.330	29.527	2.500	Luminous emittance 1	0
33	WHITECROFT K6H44KHB KOLO IP65 HOOD	52.330	34.272	2.500	Luminous emittance 1	0
34	WHITECROFT K6H44KHB KOLO IP65 HOOD	52.330	39.016	2.500	Luminous emittance 1	0
35	WHITECROFT K6H44KHB KOLO IP65 HOOD	52.330	43.761	2.500	Luminous emittance 1	0
36	WHITECROFT K6H44KHB KOLO IP65 HOOD	52.330	48.505	2.500	Luminous emittance 1	0
37	WHITECROFT K6H44KHB KOLO IP65 HOOD	52.330	53.250	2.500	Luminous emittance 1	0
38	WHITECROFT K6H44KHB KOLO IP65 HOOD	79.503	23.054	2.500	Luminous emittance 1	0
39	WHITECROFT K6H44KHB KOLO IP65 HOOD	73.357	23.054	2.500	Luminous emittance 1	0

D&d Building Services Consulting Engineers Ltd
28 Market Place Kegworth
Derby DE74 2EE

Operator Arkadiusz Gliszczynski
Telephone 01509 670 100
Fax
e-Mail arkadiusz.gliszczynski@ddce.co.uk

External Lighting / Luminous intensity calculation point 1 / Summary

Possible interference sources

No.	Luminaire	Position [m]			Luminous emittance	Luminous intensity [cd]
		X	Y	Z		
40	WHITECROFT K6H44KHB KOLO IP65 HOOD	67.210	23.054	2.500	Luminous emittance 1	0
41	WHITECROFT K6H44KHB KOLO IP65 HOOD	61.064	23.054	2.500	Luminous emittance 1	0
42	WHITECROFT K6H44KHB KOLO IP65 HOOD	54.918	23.054	2.500	Luminous emittance 1	0
43	WHITECROFT K6H44KHB KOLO IP65 HOOD	178.125	36.650	2.500	Luminous emittance 1	0
44	WHITECROFT K6H44KHB KOLO IP65 HOOD	171.625	36.650	2.500	Luminous emittance 1	0
45	WHITECROFT K6H44KHB KOLO IP65 HOOD	165.125	36.650	2.500	Luminous emittance 1	0
46	WHITECROFT K6H44KHB KOLO IP65 HOOD	158.625	36.650	2.500	Luminous emittance 1	0
47	WHITECROFT K6H44KHB KOLO IP65 HOOD	152.125	36.650	2.500	Luminous emittance 1	0
48	WHITECROFT K6H44KHB KOLO IP65 HOOD	145.625	36.650	2.500	Luminous emittance 1	0
49	WHITECROFT K6H44KHB KOLO IP65 HOOD	139.125	36.650	2.500	Luminous emittance 1	0
50	WHITECROFT K6H44KHB KOLO IP65 HOOD	132.625	36.650	2.500	Luminous emittance 1	0
51	WHITECROFT K6H44KHB KOLO IP65 HOOD	126.125	36.650	2.500	Luminous emittance 1	0
52	WHITECROFT K6H44KHB KOLO IP65 HOOD	119.625	36.650	2.500	Luminous emittance 1	0
53	Whitecroft Lighting SIMXH24KGA Sirocco Maxi area optic	109.654	88.524	10.000	Luminous emittance 1	721
54	Whitecroft Lighting SIMXH24KGA Sirocco Maxi area optic	74.502	88.500	10.000	Luminous emittance 1	133
55	Whitecroft Lighting SIMXH24KGA Sirocco Maxi area optic	57.002	88.500	10.000	Luminous emittance 1	70
56	Whitecroft Lighting SIMXH14KGA Sirocco Maxi area optic	65.784	74.997	10.000	Luminous emittance 1	192
57	Whitecroft Lighting SIMXH14KGA Sirocco Maxi area optic	65.214	74.113	10.000	Luminous emittance 1	80
58	Whitecroft Lighting SIMXH24KGA Sirocco Maxi area optic	92.010	88.500	10.000	Luminous emittance 1	292
59	Whitecroft Lighting SIMXH24KGA Sirocco Maxi area optic	27.644	79.942	10.000	Luminous emittance 1	36
60	Whitecroft Lighting SIMXH24KGA Sirocco Maxi area optic	58.774	54.381	7.500	Luminous emittance 1	0
61	Whitecroft Lighting SIMXH24KGA Sirocco Maxi area optic	16.602	69.963	10.000	Luminous emittance 1	78
62	Whitecroft Lighting ACH44K ACL Industry	123.647	87.025	2.000	Luminous emittance 1	182
63	Whitecroft Lighting ACH44K ACL Industry	120.200	87.180	2.000	Luminous emittance 1	180

D&d Building Services Consulting Engineers Ltd
28 Market Place Kegworth
Derby DE74 2EE

Operator Arkadiusz Gliszczynski
Telephone 01509 670 100
Fax
e-Mail arkadiusz.gliszczynski@ddce.co.uk

External Lighting / Luminous intensity calculation point 1 / Summary

Possible interference sources

No.	Luminaire	Position [m]			Luminous emittance	Luminous intensity [cd]
		X	Y	Z		
64	WHITECROFT ACH44K ACL INDUSTRY	19.139	60.200	1.800	Luminous emittance 1	0

All luminaires placed in the exterior scene are listed.

D&d Building Services Consulting Engineers Ltd
28 Market Place Kegworth
Derby DE74 2EE

Operator Arkadiusz Gliszczynski
Telephone 01509 670 100
Fax
e-Mail arkadiusz.gliszczynski@ddce.co.uk

External Lighting / Luminous intensity calculation point 2 / Summary

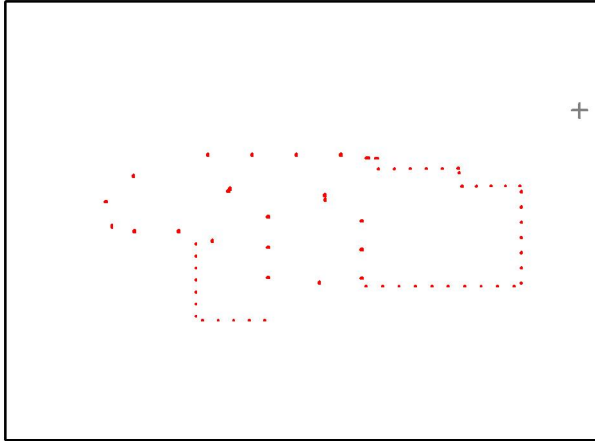

Position: (204.100 m, 106.000 m, 1.700 m)

Possible interference sources

No.	Luminaire	Position [m]			Luminous emittance	Luminous intensity [cd]
		X	Y	Z		
1	Whitecroft Lighting SIMXH14KGA Sirocco Maxi area optic	117.963	39.619	7.500	Luminous emittance 1	0
2	Whitecroft Lighting SIMXH14KGA Sirocco Maxi area optic	117.963	50.958	7.500	Luminous emittance 1	0
3	Whitecroft Lighting SIMXH14KGA Sirocco Maxi area optic	117.963	62.296	7.500	Luminous emittance 1	0
4	Whitecroft Lighting SIMXH14KGA Sirocco Maxi area optic	80.802	63.942	7.500	Luminous emittance 1	0
5	Whitecroft Lighting SIMXH14KGA Sirocco Maxi area optic	80.802	51.942	7.500	Luminous emittance 1	0
6	Whitecroft Lighting SIMXH14KGA Sirocco Maxi area optic	80.802	39.942	7.500	Luminous emittance 1	0
7	Whitecroft Lighting SIMXH24KGA Sirocco Maxi area optic	101.139	37.817	10.000	Luminous emittance 1	0
8	Whitecroft Lighting SIMXH24KGA Sirocco Maxi area optic	103.387	70.594	10.000	Luminous emittance 1	0
9	Whitecroft Lighting SIMXH24KGA Sirocco Maxi area optic	27.962	58.137	10.000	Luminous emittance 1	18
10	Whitecroft Lighting SIMXH24KGA Sirocco Maxi area optic	45.437	58.137	10.000	Luminous emittance 1	0
11	Whitecroft Lighting SIMXH14KGA Sirocco Maxi area optic	103.347	72.342	10.000	Luminous emittance 1	0
12	WHITECROFT K6H44KHB KOLO IP65 HOOD	124.498	82.803	2.500	Luminous emittance 1	22
13	WHITECROFT K6H44KHB KOLO IP65 HOOD	130.819	82.850	2.500	Luminous emittance 1	23
14	WHITECROFT K6H44KHB KOLO IP65 HOOD	137.139	82.897	2.500	Luminous emittance 1	25
15	WHITECROFT K6H44KHB KOLO IP65 HOOD	143.459	82.944	2.500	Luminous emittance 1	27

D&d Building Services Consulting Engineers Ltd
28 Market Place Kegworth
Derby DE74 2EE

Operator Arkadiusz Gliszczynski
Telephone 01509 670 100
Fax
e-Mail arkadiusz.gliszczynski@ddce.co.uk

External Lighting / Luminous intensity calculation point 2 / Summary

Possible interference sources

No.	Luminaire	Position [m]			Luminous emittance	Luminous intensity [cd]
		X	Y	Z		
16	WHITECROFT K6H44KHB KOLO IP65 HOOD	149.779	82.991	2.500	Luminous emittance 1	29
17	WHITECROFT K6H44KHB KOLO IP65 HOOD	156.099	83.038	2.500	Luminous emittance 1	32
18	WHITECROFT K6H44KHB KOLO IP65 HOOD	157.584	75.937	2.500	Luminous emittance 1	37
19	WHITECROFT K6H44KHB KOLO IP65 HOOD	163.318	75.982	2.500	Luminous emittance 1	37
20	WHITECROFT K6H44KHB KOLO IP65 HOOD	169.052	76.027	2.500	Luminous emittance 1	38
21	WHITECROFT K6H44KHB KOLO IP65 HOOD	174.786	76.072	2.500	Luminous emittance 1	39
22	WHITECROFT K6H44KHB KOLO IP65 HOOD	180.520	76.117	2.500	Luminous emittance 1	40
23	WHITECROFT K6H44KHB KOLO IP65 HOOD	156.400	81.300	2.500	Luminous emittance 1	38
24	WHITECROFT K6H44KHB KOLO IP65 HOOD	181.043	73.792	2.500	Luminous emittance 1	38
25	WHITECROFT K6H44KHB KOLO IP65 HOOD	181.039	67.792	2.500	Luminous emittance 1	37
26	WHITECROFT K6H44KHB KOLO IP65 HOOD	181.036	61.792	2.500	Luminous emittance 1	34
27	WHITECROFT K6H44KHB KOLO IP65 HOOD	181.032	55.792	2.500	Luminous emittance 1	31
28	WHITECROFT K6H44KHB KOLO IP65 HOOD	181.028	49.792	2.500	Luminous emittance 1	29
29	WHITECROFT K6H44KHB KOLO IP65 HOOD	181.024	43.792	2.500	Luminous emittance 1	27
30	WHITECROFT K6H44KHB KOLO IP65 HOOD	181.020	37.792	2.500	Luminous emittance 1	25
31	WHITECROFT K6H44KHB KOLO IP65 HOOD	52.330	24.783	2.500	Luminous emittance 1	0
32	WHITECROFT K6H44KHB KOLO IP65 HOOD	52.330	29.527	2.500	Luminous emittance 1	0
33	WHITECROFT K6H44KHB KOLO IP65 HOOD	52.330	34.272	2.500	Luminous emittance 1	0
34	WHITECROFT K6H44KHB KOLO IP65 HOOD	52.330	39.016	2.500	Luminous emittance 1	0
35	WHITECROFT K6H44KHB KOLO IP65 HOOD	52.330	43.761	2.500	Luminous emittance 1	0
36	WHITECROFT K6H44KHB KOLO IP65 HOOD	52.330	48.505	2.500	Luminous emittance 1	0
37	WHITECROFT K6H44KHB KOLO IP65 HOOD	52.330	53.250	2.500	Luminous emittance 1	0
38	WHITECROFT K6H44KHB KOLO IP65 HOOD	79.503	23.054	2.500	Luminous emittance 1	0
39	WHITECROFT K6H44KHB KOLO IP65 HOOD	73.357	23.054	2.500	Luminous emittance 1	0

D&d Building Services Consulting Engineers Ltd
28 Market Place Kegworth
Derby DE74 2EE

Operator Arkadiusz Gliszczynski
Telephone 01509 670 100
Fax
e-Mail arkadiusz.gliszczynski@ddce.co.uk

External Lighting / Luminous intensity calculation point 2 / Summary

Possible interference sources

No.	Luminaire	Position [m]			Luminous emittance	Luminous intensity [cd]
		X	Y	Z		
40	WHITECROFT K6H44KHB KOLO IP65 HOOD	67.210	23.054	2.500	Luminous emittance 1	0
41	WHITECROFT K6H44KHB KOLO IP65 HOOD	61.064	23.054	2.500	Luminous emittance 1	0
42	WHITECROFT K6H44KHB KOLO IP65 HOOD	54.918	23.054	2.500	Luminous emittance 1	0
43	WHITECROFT K6H44KHB KOLO IP65 HOOD	178.125	36.650	2.500	Luminous emittance 1	0
44	WHITECROFT K6H44KHB KOLO IP65 HOOD	171.625	36.650	2.500	Luminous emittance 1	0
45	WHITECROFT K6H44KHB KOLO IP65 HOOD	165.125	36.650	2.500	Luminous emittance 1	0
46	WHITECROFT K6H44KHB KOLO IP65 HOOD	158.625	36.650	2.500	Luminous emittance 1	0
47	WHITECROFT K6H44KHB KOLO IP65 HOOD	152.125	36.650	2.500	Luminous emittance 1	0
48	WHITECROFT K6H44KHB KOLO IP65 HOOD	145.625	36.650	2.500	Luminous emittance 1	0
49	WHITECROFT K6H44KHB KOLO IP65 HOOD	139.125	36.650	2.500	Luminous emittance 1	0
50	WHITECROFT K6H44KHB KOLO IP65 HOOD	132.625	36.650	2.500	Luminous emittance 1	0
51	WHITECROFT K6H44KHB KOLO IP65 HOOD	126.125	36.650	2.500	Luminous emittance 1	0
52	WHITECROFT K6H44KHB KOLO IP65 HOOD	119.625	36.650	2.500	Luminous emittance 1	0
53	Whitecroft Lighting SIMXH24KGA Sirocco Maxi area optic	109.654	88.524	10.000	Luminous emittance 1	42
54	Whitecroft Lighting SIMXH24KGA Sirocco Maxi area optic	74.502	88.500	10.000	Luminous emittance 1	22
55	Whitecroft Lighting SIMXH24KGA Sirocco Maxi area optic	57.002	88.500	10.000	Luminous emittance 1	17
56	Whitecroft Lighting SIMXH14KGA Sirocco Maxi area optic	65.784	74.997	10.000	Luminous emittance 1	22
57	Whitecroft Lighting SIMXH14KGA Sirocco Maxi area optic	65.214	74.113	10.000	Luminous emittance 1	8
58	Whitecroft Lighting SIMXH24KGA Sirocco Maxi area optic	92.010	88.500	10.000	Luminous emittance 1	30
59	Whitecroft Lighting SIMXH24KGA Sirocco Maxi area optic	27.644	79.942	10.000	Luminous emittance 1	15
60	Whitecroft Lighting SIMXH24KGA Sirocco Maxi area optic	58.774	54.381	7.500	Luminous emittance 1	0
61	Whitecroft Lighting SIMXH24KGA Sirocco Maxi area optic	16.602	69.963	10.000	Luminous emittance 1	29
62	Whitecroft Lighting ACH44K ACL Industry	123.647	87.025	2.000	Luminous emittance 1	25
63	Whitecroft Lighting ACH44K ACL Industry	120.200	87.180	2.000	Luminous emittance 1	25

D&d Building Services Consulting Engineers Ltd
 28 Market Place Kegworth
 Derby DE74 2EE

Operator Arkadiusz Gliszczyński
 Telephone 01509 670 100
 Fax
 e-Mail arkadiusz.gliszczyński@ddce.co.uk

External Lighting / Luminous intensity calculation point 2 / Summary

Possible interference sources

No.	Luminaire	Position [m]			Luminous emittance	Luminous intensity [cd]
		X	Y	Z		
64	WHITECROFT ACH44K ACL INDUSTRY	19.139	60.200	1.800	Luminous emittance 1	0

All luminaires placed in the exterior scene are listed.

D&d Building Services Consulting Engineers Ltd
28 Market Place Kegworth
Derby DE74 2EE

Operator Arkadiusz Gliszczynski
Telephone 01509 670 100
Fax
e-Mail arkadiusz.gliszczynski@ddce.co.uk

External Lighting / Luminous intensity calculation point 3 / Summary

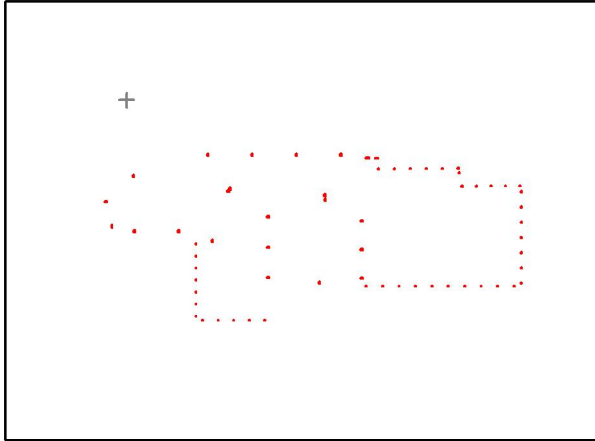

Position: (24.792 m, 110.010 m, 1.700 m)

Possible interference sources

No.	Luminaire	Position [m]			Luminous emittance	Luminous intensity [cd]
		X	Y	Z		
1	Whitecroft Lighting SIMXH14KGA Sirocco Maxi area optic	117.963	39.619	7.500	Luminous emittance 1	35
2	Whitecroft Lighting SIMXH14KGA Sirocco Maxi area optic	117.963	50.958	7.500	Luminous emittance 1	41
3	Whitecroft Lighting SIMXH14KGA Sirocco Maxi area optic	117.963	62.296	7.500	Luminous emittance 1	42
4	Whitecroft Lighting SIMXH14KGA Sirocco Maxi area optic	80.802	63.942	7.500	Luminous emittance 1	0
5	Whitecroft Lighting SIMXH14KGA Sirocco Maxi area optic	80.802	51.942	7.500	Luminous emittance 1	0
6	Whitecroft Lighting SIMXH14KGA Sirocco Maxi area optic	80.802	39.942	7.500	Luminous emittance 1	0
7	Whitecroft Lighting SIMXH24KGA Sirocco Maxi area optic	101.139	37.817	10.000	Luminous emittance 1	0
8	Whitecroft Lighting SIMXH24KGA Sirocco Maxi area optic	103.387	70.594	10.000	Luminous emittance 1	65
9	Whitecroft Lighting SIMXH24KGA Sirocco Maxi area optic	27.962	58.137	10.000	Luminous emittance 1	297
10	Whitecroft Lighting SIMXH24KGA Sirocco Maxi area optic	45.437	58.137	10.000	Luminous emittance 1	420
11	Whitecroft Lighting SIMXH14KGA Sirocco Maxi area optic	103.347	72.342	10.000	Luminous emittance 1	113
12	WHITECROFT K6H44KHB KOLO IP65 HOOD	124.498	82.803	2.500	Luminous emittance 1	22
13	WHITECROFT K6H44KHB KOLO IP65 HOOD	130.819	82.850	2.500	Luminous emittance 1	21
14	WHITECROFT K6H44KHB KOLO IP65 HOOD	137.139	82.897	2.500	Luminous emittance 1	20
15	WHITECROFT K6H44KHB KOLO IP65 HOOD	143.459	82.944	2.500	Luminous emittance 1	19

D&d Building Services Consulting Engineers Ltd
28 Market Place Kegworth
Derby DE74 2EE

Operator Arkadiusz Gliszczynski
Telephone 01509 670 100
Fax
e-Mail arkadiusz.gliszczynski@ddce.co.uk

External Lighting / Luminous intensity calculation point 3 / Summary

Possible interference sources

No.	Luminaire	Position [m]			Luminous emittance	Luminous intensity [cd]
		X	Y	Z		
16	WHITECROFT K6H44KHB KOLO IP65 HOOD	149.779	82.991	2.500	Luminous emittance 1	19
17	WHITECROFT K6H44KHB KOLO IP65 HOOD	156.099	83.038	2.500	Luminous emittance 1	18
18	WHITECROFT K6H44KHB KOLO IP65 HOOD	157.584	75.937	2.500	Luminous emittance 1	0
19	WHITECROFT K6H44KHB KOLO IP65 HOOD	163.318	75.982	2.500	Luminous emittance 1	0
20	WHITECROFT K6H44KHB KOLO IP65 HOOD	169.052	76.027	2.500	Luminous emittance 1	0
21	WHITECROFT K6H44KHB KOLO IP65 HOOD	174.786	76.072	2.500	Luminous emittance 1	0
22	WHITECROFT K6H44KHB KOLO IP65 HOOD	180.520	76.117	2.500	Luminous emittance 1	0
23	WHITECROFT K6H44KHB KOLO IP65 HOOD	156.400	81.300	2.500	Luminous emittance 1	0
24	WHITECROFT K6H44KHB KOLO IP65 HOOD	181.043	73.792	2.500	Luminous emittance 1	0
25	WHITECROFT K6H44KHB KOLO IP65 HOOD	181.039	67.792	2.500	Luminous emittance 1	0
26	WHITECROFT K6H44KHB KOLO IP65 HOOD	181.036	61.792	2.500	Luminous emittance 1	0
27	WHITECROFT K6H44KHB KOLO IP65 HOOD	181.032	55.792	2.500	Luminous emittance 1	0
28	WHITECROFT K6H44KHB KOLO IP65 HOOD	181.028	49.792	2.500	Luminous emittance 1	0
29	WHITECROFT K6H44KHB KOLO IP65 HOOD	181.024	43.792	2.500	Luminous emittance 1	0
30	WHITECROFT K6H44KHB KOLO IP65 HOOD	181.020	37.792	2.500	Luminous emittance 1	0
31	WHITECROFT K6H44KHB KOLO IP65 HOOD	52.330	24.783	2.500	Luminous emittance 1	24
32	WHITECROFT K6H44KHB KOLO IP65 HOOD	52.330	29.527	2.500	Luminous emittance 1	25
33	WHITECROFT K6H44KHB KOLO IP65 HOOD	52.330	34.272	2.500	Luminous emittance 1	26
34	WHITECROFT K6H44KHB KOLO IP65 HOOD	52.330	39.016	2.500	Luminous emittance 1	27
35	WHITECROFT K6H44KHB KOLO IP65 HOOD	52.330	43.761	2.500	Luminous emittance 1	29
36	WHITECROFT K6H44KHB KOLO IP65 HOOD	52.330	48.505	2.500	Luminous emittance 1	30
37	WHITECROFT K6H44KHB KOLO IP65 HOOD	52.330	53.250	2.500	Luminous emittance 1	32
38	WHITECROFT K6H44KHB KOLO IP65 HOOD	79.503	23.054	2.500	Luminous emittance 1	0
39	WHITECROFT K6H44KHB KOLO IP65 HOOD	73.357	23.054	2.500	Luminous emittance 1	0

D&d Building Services Consulting Engineers Ltd
28 Market Place Kegworth
Derby DE74 2EE

Operator Arkadiusz Gliszczynski
Telephone 01509 670 100
Fax
e-Mail arkadiusz.gliszczynski@ddce.co.uk

External Lighting / Luminous intensity calculation point 3 / Summary

Possible interference sources

No.	Luminaire	Position [m]			Luminous emittance	Luminous intensity [cd]
		X	Y	Z		
40	WHITECROFT K6H44KHB KOLO IP65 HOOD	67.210	23.054	2.500	Luminous emittance 1	0
41	WHITECROFT K6H44KHB KOLO IP65 HOOD	61.064	23.054	2.500	Luminous emittance 1	0
42	WHITECROFT K6H44KHB KOLO IP65 HOOD	54.918	23.054	2.500	Luminous emittance 1	0
43	WHITECROFT K6H44KHB KOLO IP65 HOOD	178.125	36.650	2.500	Luminous emittance 1	0
44	WHITECROFT K6H44KHB KOLO IP65 HOOD	171.625	36.650	2.500	Luminous emittance 1	0
45	WHITECROFT K6H44KHB KOLO IP65 HOOD	165.125	36.650	2.500	Luminous emittance 1	0
46	WHITECROFT K6H44KHB KOLO IP65 HOOD	158.625	36.650	2.500	Luminous emittance 1	0
47	WHITECROFT K6H44KHB KOLO IP65 HOOD	152.125	36.650	2.500	Luminous emittance 1	0
48	WHITECROFT K6H44KHB KOLO IP65 HOOD	145.625	36.650	2.500	Luminous emittance 1	0
49	WHITECROFT K6H44KHB KOLO IP65 HOOD	139.125	36.650	2.500	Luminous emittance 1	0
50	WHITECROFT K6H44KHB KOLO IP65 HOOD	132.625	36.650	2.500	Luminous emittance 1	0
51	WHITECROFT K6H44KHB KOLO IP65 HOOD	126.125	36.650	2.500	Luminous emittance 1	0
52	WHITECROFT K6H44KHB KOLO IP65 HOOD	119.625	36.650	2.500	Luminous emittance 1	0
53	Whitecroft Lighting SIMXH24KGA Sirocco Maxi area optic	109.654	88.524	10.000	Luminous emittance 1	50
54	Whitecroft Lighting SIMXH24KGA Sirocco Maxi area optic	74.502	88.500	10.000	Luminous emittance 1	155
55	Whitecroft Lighting SIMXH24KGA Sirocco Maxi area optic	57.002	88.500	10.000	Luminous emittance 1	340
56	Whitecroft Lighting SIMXH14KGA Sirocco Maxi area optic	65.784	74.997	10.000	Luminous emittance 1	487
57	Whitecroft Lighting SIMXH14KGA Sirocco Maxi area optic	65.214	74.113	10.000	Luminous emittance 1	513
58	Whitecroft Lighting SIMXH24KGA Sirocco Maxi area optic	92.010	88.500	10.000	Luminous emittance 1	83
59	Whitecroft Lighting SIMXH24KGA Sirocco Maxi area optic	27.644	79.942	10.000	Luminous emittance 1	503
60	Whitecroft Lighting SIMXH24KGA Sirocco Maxi area optic	58.774	54.381	7.500	Luminous emittance 1	180
61	Whitecroft Lighting SIMXH24KGA Sirocco Maxi area optic	16.602	69.963	10.000	Luminous emittance 1	347
62	Whitecroft Lighting ACH44K ACL Industry	123.647	87.025	2.000	Luminous emittance 1	25
63	Whitecroft Lighting ACH44K ACL Industry	120.200	87.180	2.000	Luminous emittance 1	25

D&d Building Services Consulting Engineers Ltd
 28 Market Place Kegworth
 Derby DE74 2EE

Operator Arkadiusz Gliszczynski
 Telephone 01509 670 100
 Fax
 e-Mail arkadiusz.gliszczynski@ddce.co.uk

External Lighting / Luminous intensity calculation point 3 / Summary

Possible interference sources

No.	Luminaire	Position [m]			Luminous emittance	Luminous intensity [cd]
		X	Y	Z		
64	WHITECROFT ACH44K ACL INDUSTRY	19.139	60.200	1.800	Luminous emittance 1	0

All luminaires placed in the exterior scene are listed.

D&d Building Services Consulting Engineers Ltd
28 Market Place Kegworth
Derby DE74 2EE

Operator Arkadiusz Gliszczynski
Telephone 01509 670 100
Fax
e-Mail arkadiusz.gliszczynski@ddce.co.uk

External Lighting / Luminous intensity calculation point 4 / Summary

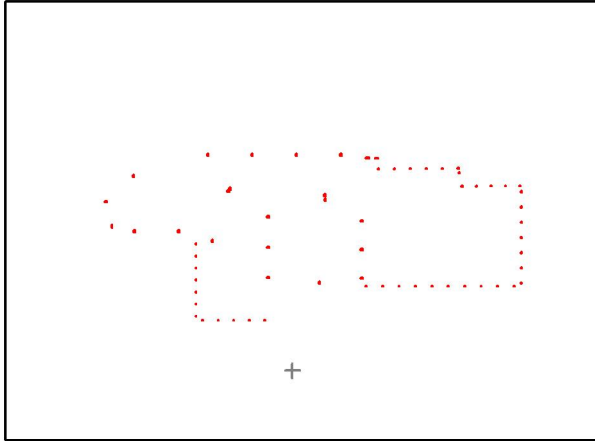

Position: (90.452 m, 3.161 m, 1.700 m)

Possible interference sources

No.	Luminaire	Position [m]			Luminous emittance	Luminous intensity [cd]
		X	Y	Z		
1	Whitecroft Lighting SIMXH14KGA Sirocco Maxi area optic	117.963	39.619	7.500	Luminous emittance 1	0
2	Whitecroft Lighting SIMXH14KGA Sirocco Maxi area optic	117.963	50.958	7.500	Luminous emittance 1	0
3	Whitecroft Lighting SIMXH14KGA Sirocco Maxi area optic	117.963	62.296	7.500	Luminous emittance 1	0
4	Whitecroft Lighting SIMXH14KGA Sirocco Maxi area optic	80.802	63.942	7.500	Luminous emittance 1	50
5	Whitecroft Lighting SIMXH14KGA Sirocco Maxi area optic	80.802	51.942	7.500	Luminous emittance 1	85
6	Whitecroft Lighting SIMXH14KGA Sirocco Maxi area optic	80.802	39.942	7.500	Luminous emittance 1	166
7	Whitecroft Lighting SIMXH24KGA Sirocco Maxi area optic	101.139	37.817	10.000	Luminous emittance 1	0
8	Whitecroft Lighting SIMXH24KGA Sirocco Maxi area optic	103.387	70.594	10.000	Luminous emittance 1	177
9	Whitecroft Lighting SIMXH24KGA Sirocco Maxi area optic	27.962	58.137	10.000	Luminous emittance 1	0
10	Whitecroft Lighting SIMXH24KGA Sirocco Maxi area optic	45.437	58.137	10.000	Luminous emittance 1	0
11	Whitecroft Lighting SIMXH14KGA Sirocco Maxi area optic	103.347	72.342	10.000	Luminous emittance 1	35
12	WHITECROFT K6H44KHB KOLO IP65 HOOD	124.498	82.803	2.500	Luminous emittance 1	0
13	WHITECROFT K6H44KHB KOLO IP65 HOOD	130.819	82.850	2.500	Luminous emittance 1	0
14	WHITECROFT K6H44KHB KOLO IP65 HOOD	137.139	82.897	2.500	Luminous emittance 1	0
15	WHITECROFT K6H44KHB KOLO IP65 HOOD	143.459	82.944	2.500	Luminous emittance 1	0

D&d Building Services Consulting Engineers Ltd
28 Market Place Kegworth
Derby DE74 2EE

Operator Arkadiusz Gliszczynski
Telephone 01509 670 100
Fax
e-Mail arkadiusz.gliszczynski@ddce.co.uk

External Lighting / Luminous intensity calculation point 4 / Summary

Possible interference sources

No.	Luminaire	Position [m]			Luminous emittance	Luminous intensity [cd]
		X	Y	Z		
16	WHITECROFT K6H44KHB KOLO IP65 HOOD	149.779	82.991	2.500	Luminous emittance 1	0
17	WHITECROFT K6H44KHB KOLO IP65 HOOD	156.099	83.038	2.500	Luminous emittance 1	0
18	WHITECROFT K6H44KHB KOLO IP65 HOOD	157.584	75.937	2.500	Luminous emittance 1	0
19	WHITECROFT K6H44KHB KOLO IP65 HOOD	163.318	75.982	2.500	Luminous emittance 1	0
20	WHITECROFT K6H44KHB KOLO IP65 HOOD	169.052	76.027	2.500	Luminous emittance 1	0
21	WHITECROFT K6H44KHB KOLO IP65 HOOD	174.786	76.072	2.500	Luminous emittance 1	0
22	WHITECROFT K6H44KHB KOLO IP65 HOOD	180.520	76.117	2.500	Luminous emittance 1	0
23	WHITECROFT K6H44KHB KOLO IP65 HOOD	156.400	81.300	2.500	Luminous emittance 1	0
24	WHITECROFT K6H44KHB KOLO IP65 HOOD	181.043	73.792	2.500	Luminous emittance 1	0
25	WHITECROFT K6H44KHB KOLO IP65 HOOD	181.039	67.792	2.500	Luminous emittance 1	0
26	WHITECROFT K6H44KHB KOLO IP65 HOOD	181.036	61.792	2.500	Luminous emittance 1	0
27	WHITECROFT K6H44KHB KOLO IP65 HOOD	181.032	55.792	2.500	Luminous emittance 1	0
28	WHITECROFT K6H44KHB KOLO IP65 HOOD	181.028	49.792	2.500	Luminous emittance 1	0
29	WHITECROFT K6H44KHB KOLO IP65 HOOD	181.024	43.792	2.500	Luminous emittance 1	0
30	WHITECROFT K6H44KHB KOLO IP65 HOOD	181.020	37.792	2.500	Luminous emittance 1	0
31	WHITECROFT K6H44KHB KOLO IP65 HOOD	52.330	24.783	2.500	Luminous emittance 1	0
32	WHITECROFT K6H44KHB KOLO IP65 HOOD	52.330	29.527	2.500	Luminous emittance 1	0
33	WHITECROFT K6H44KHB KOLO IP65 HOOD	52.330	34.272	2.500	Luminous emittance 1	0
34	WHITECROFT K6H44KHB KOLO IP65 HOOD	52.330	39.016	2.500	Luminous emittance 1	0
35	WHITECROFT K6H44KHB KOLO IP65 HOOD	52.330	43.761	2.500	Luminous emittance 1	0
36	WHITECROFT K6H44KHB KOLO IP65 HOOD	52.330	48.505	2.500	Luminous emittance 1	0
37	WHITECROFT K6H44KHB KOLO IP65 HOOD	52.330	53.250	2.500	Luminous emittance 1	0
38	WHITECROFT K6H44KHB KOLO IP65 HOOD	79.503	23.054	2.500	Luminous emittance 1	42
39	WHITECROFT K6H44KHB KOLO IP65 HOOD	73.357	23.054	2.500	Luminous emittance 1	0

D&d Building Services Consulting Engineers Ltd
28 Market Place Kegworth
Derby DE74 2EE

Operator Arkadiusz Gliszczynski
Telephone 01509 670 100
Fax
e-Mail arkadiusz.gliszczynski@ddce.co.uk

External Lighting / Luminous intensity calculation point 4 / Summary

Possible interference sources

No.	Luminaire	Position [m]			Luminous emittance	Luminous intensity [cd]
		X	Y	Z		
40	WHITECROFT K6H44KHB KOLO IP65 HOOD	67.210	23.054	2.500	Luminous emittance 1	39
41	WHITECROFT K6H44KHB KOLO IP65 HOOD	61.064	23.054	2.500	Luminous emittance 1	38
42	WHITECROFT K6H44KHB KOLO IP65 HOOD	54.918	23.054	2.500	Luminous emittance 1	36
43	WHITECROFT K6H44KHB KOLO IP65 HOOD	178.125	36.650	2.500	Luminous emittance 1	0
44	WHITECROFT K6H44KHB KOLO IP65 HOOD	171.625	36.650	2.500	Luminous emittance 1	0
45	WHITECROFT K6H44KHB KOLO IP65 HOOD	165.125	36.650	2.500	Luminous emittance 1	0
46	WHITECROFT K6H44KHB KOLO IP65 HOOD	158.625	36.650	2.500	Luminous emittance 1	0
47	WHITECROFT K6H44KHB KOLO IP65 HOOD	152.125	36.650	2.500	Luminous emittance 1	0
48	WHITECROFT K6H44KHB KOLO IP65 HOOD	145.625	36.650	2.500	Luminous emittance 1	0
49	WHITECROFT K6H44KHB KOLO IP65 HOOD	139.125	36.650	2.500	Luminous emittance 1	0
50	WHITECROFT K6H44KHB KOLO IP65 HOOD	132.625	36.650	2.500	Luminous emittance 1	0
51	WHITECROFT K6H44KHB KOLO IP65 HOOD	126.125	36.650	2.500	Luminous emittance 1	0
52	WHITECROFT K6H44KHB KOLO IP65 HOOD	119.625	36.650	2.500	Luminous emittance 1	0
53	Whitecroft Lighting SIMXH24KGA Sirocco Maxi area optic	109.654	88.524	10.000	Luminous emittance 1	0
54	Whitecroft Lighting SIMXH24KGA Sirocco Maxi area optic	74.502	88.500	10.000	Luminous emittance 1	0
55	Whitecroft Lighting SIMXH24KGA Sirocco Maxi area optic	57.002	88.500	10.000	Luminous emittance 1	0
56	Whitecroft Lighting SIMXH14KGA Sirocco Maxi area optic	65.784	74.997	10.000	Luminous emittance 1	0
57	Whitecroft Lighting SIMXH14KGA Sirocco Maxi area optic	65.214	74.113	10.000	Luminous emittance 1	0
58	Whitecroft Lighting SIMXH24KGA Sirocco Maxi area optic	92.010	88.500	10.000	Luminous emittance 1	102
59	Whitecroft Lighting SIMXH24KGA Sirocco Maxi area optic	27.644	79.942	10.000	Luminous emittance 1	0
60	Whitecroft Lighting SIMXH24KGA Sirocco Maxi area optic	58.774	54.381	7.500	Luminous emittance 1	0
61	Whitecroft Lighting SIMXH24KGA Sirocco Maxi area optic	16.602	69.963	10.000	Luminous emittance 1	0
62	Whitecroft Lighting ACH44K ACL Industry	123.647	87.025	2.000	Luminous emittance 1	0
63	Whitecroft Lighting ACH44K ACL Industry	120.200	87.180	2.000	Luminous emittance 1	0

D&d Building Services Consulting Engineers Ltd
28 Market Place Kegworth
Derby DE74 2EE

Operator Arkadiusz Gliszczyński
Telephone 01509 670 100
Fax
e-Mail arkadiusz.gliszczyński@ddce.co.uk

External Lighting / Luminous intensity calculation point 4 / Summary

Possible interference sources

No.	Luminaire	Position [m]			Luminous emittance	Luminous intensity [cd]
		X	Y	Z		
64	WHITECROFT ACH44K ACL INDUSTRY	19.139	60.200	1.800	Luminous emittance 1	0

All luminaires placed in the exterior scene are listed.

D&d Building Services Consulting Engineers Ltd
28 Market Place Kegworth
Derby DE74 2EE

Operator Arkadiusz Gliszczynski
Telephone 01509 670 100
Fax
e-Mail arkadiusz.gliszczynski@ddce.co.uk

External Lighting / Luminous intensity calculation point 5 / Summary

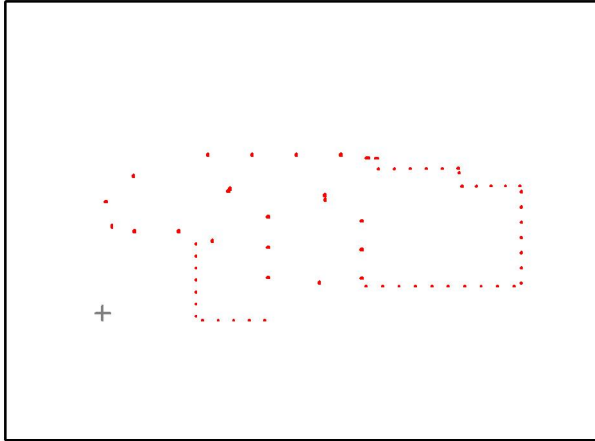

Position: (15.400 m, 25.900 m, 1.700 m)

Possible interference sources

No.	Luminaire	Position [m]			Luminous emittance	Luminous intensity [cd]
		X	Y	Z		
1	Whitecroft Lighting SIMXH14KGA Sirocco Maxi area optic	117.963	39.619	7.500	Luminous emittance 1	0
2	Whitecroft Lighting SIMXH14KGA Sirocco Maxi area optic	117.963	50.958	7.500	Luminous emittance 1	0
3	Whitecroft Lighting SIMXH14KGA Sirocco Maxi area optic	117.963	62.296	7.500	Luminous emittance 1	0
4	Whitecroft Lighting SIMXH14KGA Sirocco Maxi area optic	80.802	63.942	7.500	Luminous emittance 1	0
5	Whitecroft Lighting SIMXH14KGA Sirocco Maxi area optic	80.802	51.942	7.500	Luminous emittance 1	0
6	Whitecroft Lighting SIMXH14KGA Sirocco Maxi area optic	80.802	39.942	7.500	Luminous emittance 1	0
7	Whitecroft Lighting SIMXH24KGA Sirocco Maxi area optic	101.139	37.817	10.000	Luminous emittance 1	0
8	Whitecroft Lighting SIMXH24KGA Sirocco Maxi area optic	103.387	70.594	10.000	Luminous emittance 1	0
9	Whitecroft Lighting SIMXH24KGA Sirocco Maxi area optic	27.962	58.137	10.000	Luminous emittance 1	550
10	Whitecroft Lighting SIMXH24KGA Sirocco Maxi area optic	45.437	58.137	10.000	Luminous emittance 1	404
11	Whitecroft Lighting SIMXH14KGA Sirocco Maxi area optic	103.347	72.342	10.000	Luminous emittance 1	0
12	WHITECROFT K6H44KHB KOLO IP65 HOOD	124.498	82.803	2.500	Luminous emittance 1	0
13	WHITECROFT K6H44KHB KOLO IP65 HOOD	130.819	82.850	2.500	Luminous emittance 1	0
14	WHITECROFT K6H44KHB KOLO IP65 HOOD	137.139	82.897	2.500	Luminous emittance 1	0
15	WHITECROFT K6H44KHB KOLO IP65 HOOD	143.459	82.944	2.500	Luminous emittance 1	0

D&d Building Services Consulting Engineers Ltd
28 Market Place Kegworth
Derby DE74 2EE

Operator Arkadiusz Gliszczynski
Telephone 01509 670 100
Fax
e-Mail arkadiusz.gliszczynski@ddce.co.uk

External Lighting / Luminous intensity calculation point 5 / Summary

Possible interference sources

No.	Luminaire	Position [m]			Luminous emittance	Luminous intensity [cd]
		X	Y	Z		
16	WHITECROFT K6H44KHB KOLO IP65 HOOD	149.779	82.991	2.500	Luminous emittance 1	0
17	WHITECROFT K6H44KHB KOLO IP65 HOOD	156.099	83.038	2.500	Luminous emittance 1	0
18	WHITECROFT K6H44KHB KOLO IP65 HOOD	157.584	75.937	2.500	Luminous emittance 1	0
19	WHITECROFT K6H44KHB KOLO IP65 HOOD	163.318	75.982	2.500	Luminous emittance 1	0
20	WHITECROFT K6H44KHB KOLO IP65 HOOD	169.052	76.027	2.500	Luminous emittance 1	0
21	WHITECROFT K6H44KHB KOLO IP65 HOOD	174.786	76.072	2.500	Luminous emittance 1	0
22	WHITECROFT K6H44KHB KOLO IP65 HOOD	180.520	76.117	2.500	Luminous emittance 1	0
23	WHITECROFT K6H44KHB KOLO IP65 HOOD	156.400	81.300	2.500	Luminous emittance 1	0
24	WHITECROFT K6H44KHB KOLO IP65 HOOD	181.043	73.792	2.500	Luminous emittance 1	0
25	WHITECROFT K6H44KHB KOLO IP65 HOOD	181.039	67.792	2.500	Luminous emittance 1	0
26	WHITECROFT K6H44KHB KOLO IP65 HOOD	181.036	61.792	2.500	Luminous emittance 1	0
27	WHITECROFT K6H44KHB KOLO IP65 HOOD	181.032	55.792	2.500	Luminous emittance 1	0
28	WHITECROFT K6H44KHB KOLO IP65 HOOD	181.028	49.792	2.500	Luminous emittance 1	0
29	WHITECROFT K6H44KHB KOLO IP65 HOOD	181.024	43.792	2.500	Luminous emittance 1	0
30	WHITECROFT K6H44KHB KOLO IP65 HOOD	181.020	37.792	2.500	Luminous emittance 1	0
31	WHITECROFT K6H44KHB KOLO IP65 HOOD	52.330	24.783	2.500	Luminous emittance 1	34
32	WHITECROFT K6H44KHB KOLO IP65 HOOD	52.330	29.527	2.500	Luminous emittance 1	34
33	WHITECROFT K6H44KHB KOLO IP65 HOOD	52.330	34.272	2.500	Luminous emittance 1	34
34	WHITECROFT K6H44KHB KOLO IP65 HOOD	52.330	39.016	2.500	Luminous emittance 1	36
35	WHITECROFT K6H44KHB KOLO IP65 HOOD	52.330	43.761	2.500	Luminous emittance 1	38
36	WHITECROFT K6H44KHB KOLO IP65 HOOD	52.330	48.505	2.500	Luminous emittance 1	40
37	WHITECROFT K6H44KHB KOLO IP65 HOOD	52.330	53.250	2.500	Luminous emittance 1	39
38	WHITECROFT K6H44KHB KOLO IP65 HOOD	79.503	23.054	2.500	Luminous emittance 1	0
39	WHITECROFT K6H44KHB KOLO IP65 HOOD	73.357	23.054	2.500	Luminous emittance 1	0

D&d Building Services Consulting Engineers Ltd
28 Market Place Kegworth
Derby DE74 2EE

Operator Arkadiusz Gliszczynski
Telephone 01509 670 100
Fax
e-Mail arkadiusz.gliszczynski@ddce.co.uk

External Lighting / Luminous intensity calculation point 5 / Summary

Possible interference sources

No.	Luminaire	Position [m]			Luminous emittance	Luminous intensity [cd]
		X	Y	Z		
40	WHITECROFT K6H44KHB KOLO IP65 HOOD	67.210	23.054	2.500	Luminous emittance 1	0
41	WHITECROFT K6H44KHB KOLO IP65 HOOD	61.064	23.054	2.500	Luminous emittance 1	5
42	WHITECROFT K6H44KHB KOLO IP65 HOOD	54.918	23.054	2.500	Luminous emittance 1	5
43	WHITECROFT K6H44KHB KOLO IP65 HOOD	178.125	36.650	2.500	Luminous emittance 1	0
44	WHITECROFT K6H44KHB KOLO IP65 HOOD	171.625	36.650	2.500	Luminous emittance 1	0
45	WHITECROFT K6H44KHB KOLO IP65 HOOD	165.125	36.650	2.500	Luminous emittance 1	0
46	WHITECROFT K6H44KHB KOLO IP65 HOOD	158.625	36.650	2.500	Luminous emittance 1	0
47	WHITECROFT K6H44KHB KOLO IP65 HOOD	152.125	36.650	2.500	Luminous emittance 1	0
48	WHITECROFT K6H44KHB KOLO IP65 HOOD	145.625	36.650	2.500	Luminous emittance 1	0
49	WHITECROFT K6H44KHB KOLO IP65 HOOD	139.125	36.650	2.500	Luminous emittance 1	0
50	WHITECROFT K6H44KHB KOLO IP65 HOOD	132.625	36.650	2.500	Luminous emittance 1	0
51	WHITECROFT K6H44KHB KOLO IP65 HOOD	126.125	36.650	2.500	Luminous emittance 1	0
52	WHITECROFT K6H44KHB KOLO IP65 HOOD	119.625	36.650	2.500	Luminous emittance 1	0
53	Whitecroft Lighting SIMXH24KGA Sirocco Maxi area optic	109.654	88.524	10.000	Luminous emittance 1	0
54	Whitecroft Lighting SIMXH24KGA Sirocco Maxi area optic	74.502	88.500	10.000	Luminous emittance 1	199
55	Whitecroft Lighting SIMXH24KGA Sirocco Maxi area optic	57.002	88.500	10.000	Luminous emittance 1	285
56	Whitecroft Lighting SIMXH14KGA Sirocco Maxi area optic	65.784	74.997	10.000	Luminous emittance 1	204
57	Whitecroft Lighting SIMXH14KGA Sirocco Maxi area optic	65.214	74.113	10.000	Luminous emittance 1	267
58	Whitecroft Lighting SIMXH24KGA Sirocco Maxi area optic	92.010	88.500	10.000	Luminous emittance 1	155
59	Whitecroft Lighting SIMXH24KGA Sirocco Maxi area optic	27.644	79.942	10.000	Luminous emittance 1	297
60	Whitecroft Lighting SIMXH24KGA Sirocco Maxi area optic	58.774	54.381	7.500	Luminous emittance 1	0
61	Whitecroft Lighting SIMXH24KGA Sirocco Maxi area optic	16.602	69.963	10.000	Luminous emittance 1	184
62	Whitecroft Lighting ACH44K ACL Industry	123.647	87.025	2.000	Luminous emittance 1	0
63	Whitecroft Lighting ACH44K ACL Industry	120.200	87.180	2.000	Luminous emittance 1	0

D&d Building Services Consulting Engineers Ltd
28 Market Place Kegworth
Derby DE74 2EE

Operator Arkadiusz Gliszczynski
Telephone 01509 670 100
Fax
e-Mail arkadiusz.gliszczynski@ddce.co.uk

External Lighting / Luminous intensity calculation point 5 / Summary

Possible interference sources

No.	Luminaire	Position [m]			Luminous emittance	Luminous intensity [cd]
		X	Y	Z		
64	WHITECROFT ACH44K ACL INDUSTRY	19.139	60.200	1.800	Luminous emittance 1	0

All luminaires placed in the exterior scene are listed.