

Notes :

This drawing is intended as an initial appraisal of the site only. Do not use for the purposes of valuation. This drawing has been produced using OS information and a full measured laser digital survey. The proposals are subject to further detailed site inspection(s) and are subject to planning. All building work must comply with relevant British Standards and Building Regulations. All dimensions to be checked on site prior to the commencement of works and any discrepancies or omissions referred to the Architect / Engineer / Contractor

The ownership of copyright of this drawing remains the property of Studio:08 architecture + planning ltd in accordance with the Copyright Design + Patents Act 1988.

Reproduction of this drawing or its content, wholly or in part by a 3rd party is prohibited without written approval. No implied licence exists.

NB: If a hard copy of this drawing is to be printed or copied at a remote source by a 3rd party it could result in minor distortions in the original scale. It is advised to verify the original scale has been reproduced accurately by checking the visual scales on the drawing.

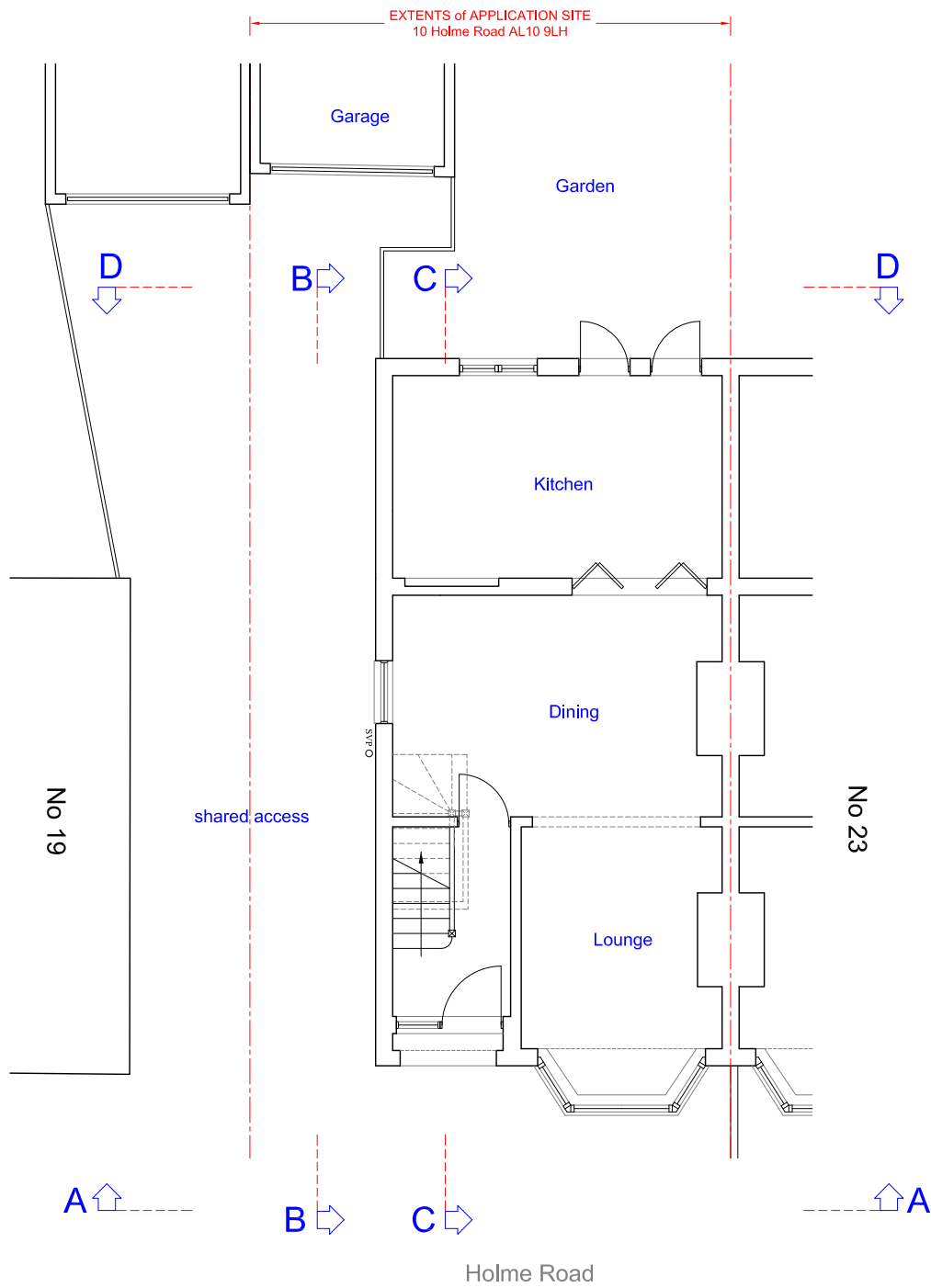
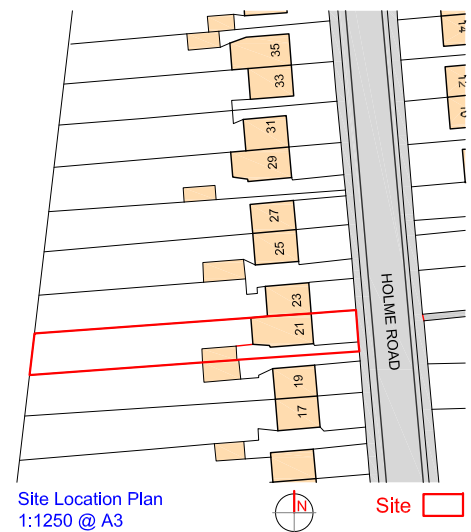

21 Holme Road, Hatfield AL10 9LH
PROPOSED (No Alterations)
Ground Floor Plan

scale 1:100 @ A3

SCALE

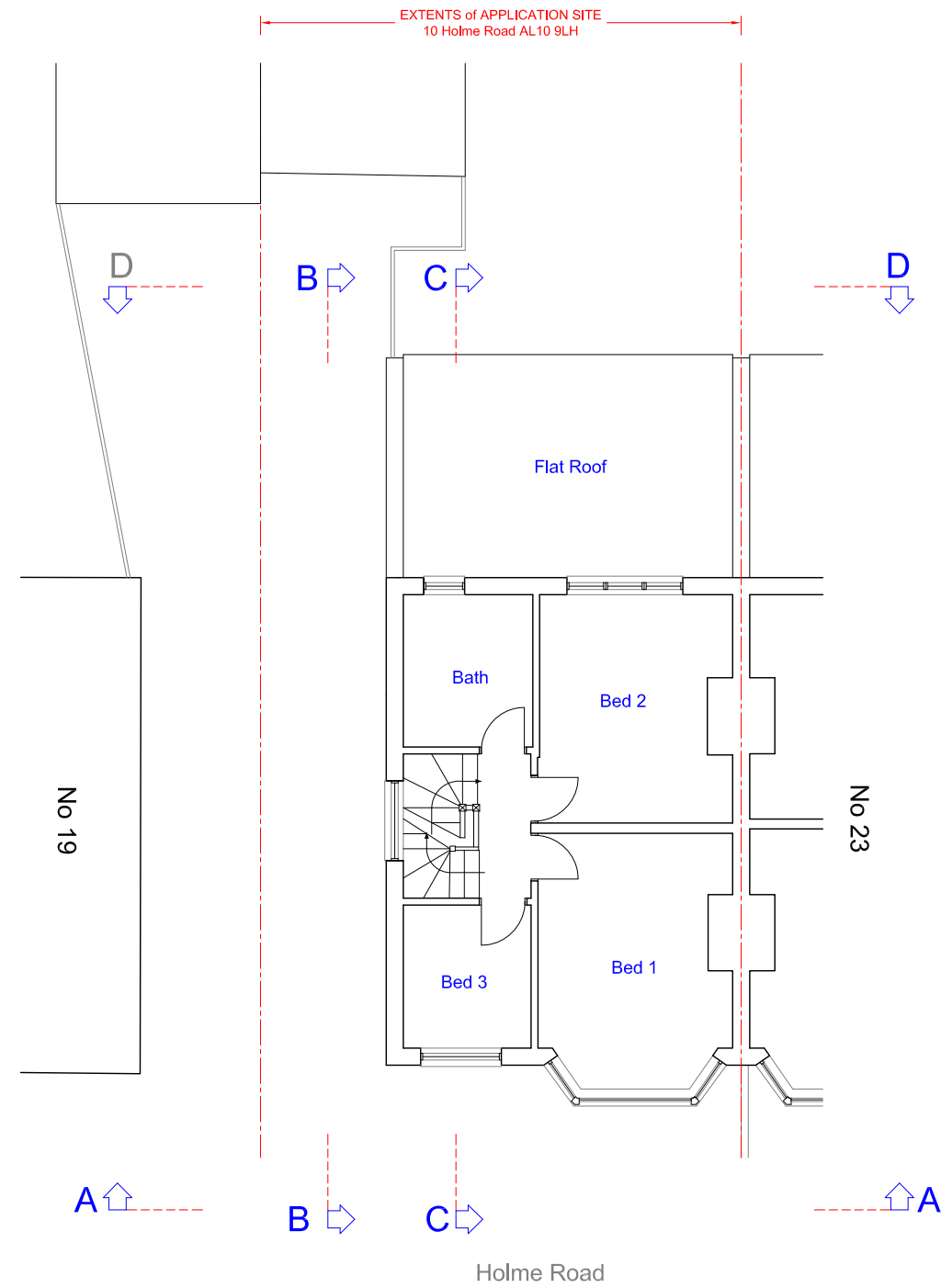

21 Holme Road, Hatfield AL10 9LH
PROPOSED
First Floor Plan

scale 1:100 @ A3

SCALE



Rev	Detail	Date
-----	--------	------

Drawing No. : 2019.P.11 Revision :

2019.P.11

Scale :

1:50 @ A1
1:100 @ A3

Date :

10.05.18

Project Title:

21 Holme Road
Hatfield
Herts AL10 9LH

Drawing Title :

PROPOSED
Ground and First Floor Plans