

Condition 27 (Access to & egress from adjoining highway)

CONDITION

Prior to first occupation of the development, vehicular and pedestrian (and cyclist) access to and egress from the adjoining highway shall be limited to the access(es) shown on drawing number (47179/5501/101 Rev P5) only. Any of the access(es) or egresses shall be permanently closed, and the footway / highway verge shall be reinstated in accordance with a detailed scheme to be agreed with the Local Planning Authority, concurrently with the bringing into use of the new access.

RESPONSE

In the interest of highway safety, the development, vehicular and pedestrian (and cyclist) access to and egress from the adjoining highway is limited to the access(es) shown on drawing number (47179/5501/101 Rev P5) only on our site plan.

Attached drawing under appendices demonstrate that condition has been complied with.

Drawings	Title	Rev	Date
HAT-RDB-XX-ST-DR-A-0002	Site Plan	R02	15 July 2022

REASON

In the interest of highway safety in accordance with Policy SADM 2 of the Welwyn Hatfield Borough Council Draft Local Plan Proposed Submission August 2016, and the National Planning Policy Framework.



Do not scale from drawings. Verify all dimensions on site prior to construction. This drawing is to be read in conjunction with all relevant documents and drawings. Report all discrepancies to Redbrooks immediately.

No unauthorised use, disclosure, storage or copying.

Notes

- KEY**
-  ACCESS ENTRANCE TO DEVELOPMENT
 -  OWNERSHIP BOUNDARY OUTLINED IN RED

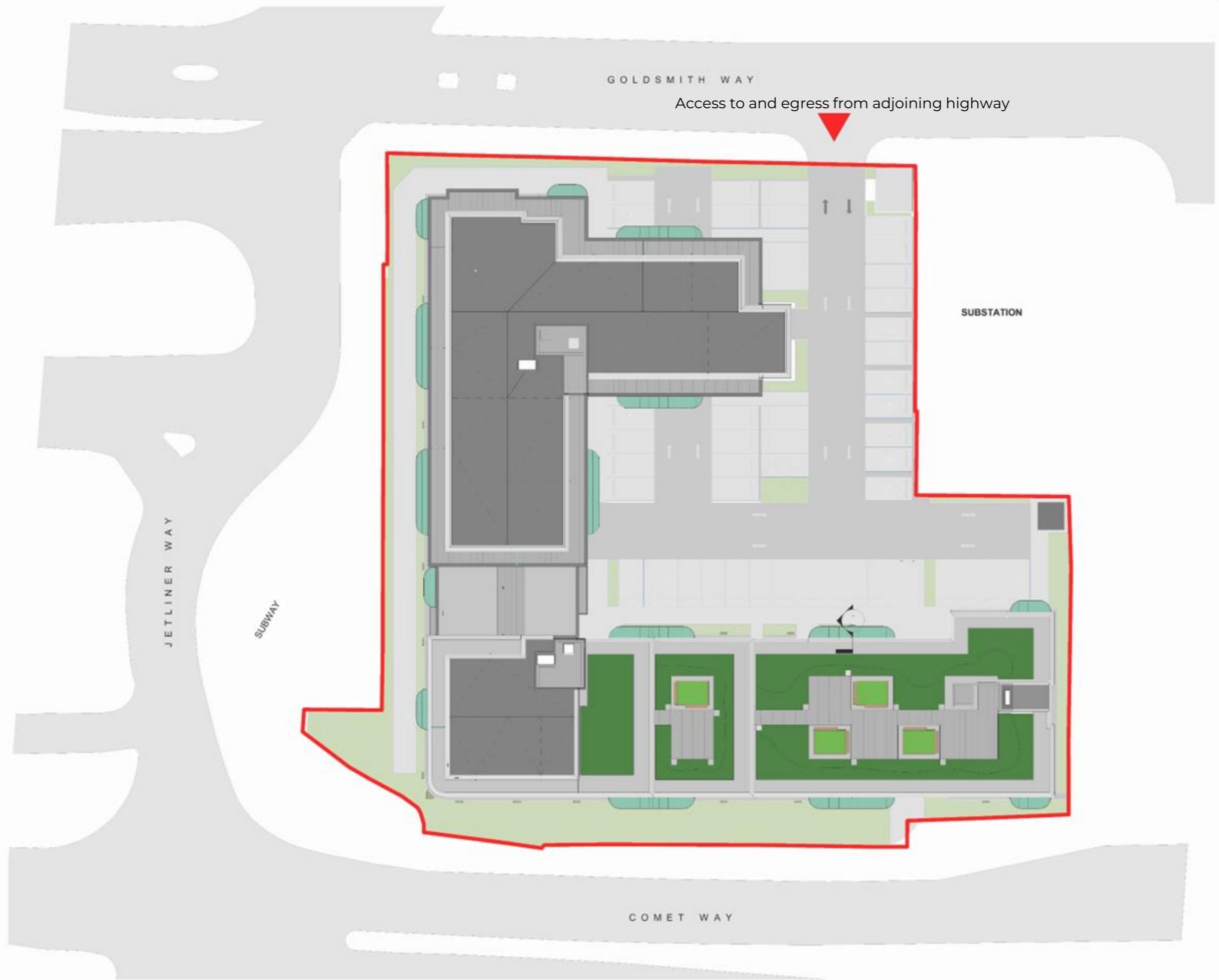

Access to and egress from adjoining highway

SUBSTATION

JETLINER WAY

SUBWAY

GOLDSMITH WAY

COMET WAY

Rev	Date	Description
R02	15.07.22	ISSUED FOR INFORMATION
R01	26.05.22	ISSUED FOR INFORMATION

Key Plan

Project Status
RIBA 4

Client



New Ways
Modern, sustainable building
Unit 8 Central Park, Central Close, Boston 5514 30W



Redbrooks
Unit 8 Central Park, Central Close, Boston 5514 30W

Project Name & Address
VOLKSWAGEN HATFIELD
COMET WAY, HATFIELD, AL10 9TF

Building Type
RESIDENTIAL DEVELOPMENT

Drawing Title
SITE PLAN

Drawn By	N.B.	Date	23.05.2022
Checked By	J.B.	Date	24.05.2022
Approved By	R.V.	Date	24.05.2022

Drawing Number
HAT-RDB-XX-ST-DR-A-0002

Sheet No.	Scale	Orig. Sheet Size	Rev.
01 of 01	1:200	@A1	R02

Site plan