

This scheme is subject to Town Planning and all other necessary consents. Dimensions, areas and levels where given are only approximate and subject to site survey. All dimensions are to be checked on site. All feasibility studies are subject to full site survey. This drawing is to be read in conjunction with all relevant consultants and/or specialist drawings/documents and any discrepancies or variations are to be notified to the architect in writing before the affected work commences. All queries relating to design of structural elements are to be referred to the structural engineering consultant for resolution. The workmanship and materials of all trades and building operations shall comply with the recommendations of British Standards (BS)800 parts 1-14, inclusive and with Approved Document to support Regulation 7 1999 edition (incorporating 2000 amendments) of the Building Regulations 2010. All design and construction is to be in accordance with the Construction (Design and Management) Regulations 2015.

Rev	Date	Description	By
-----	------	-------------	----

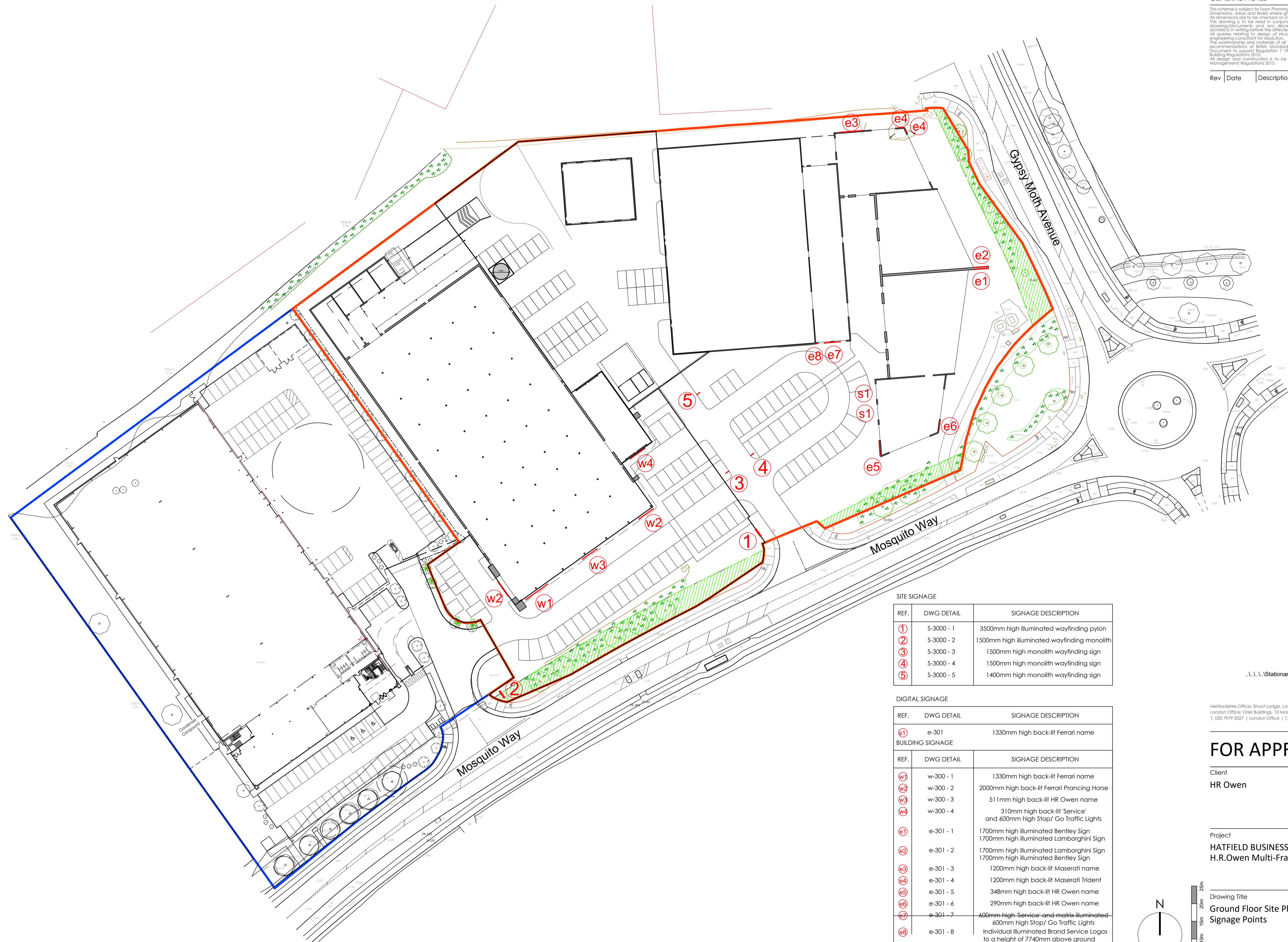

SITE SIGNAGE

REF.	DWG DETAIL	SIGNAGE DESCRIPTION
①	S-3000 - 1	3500mm high illuminated wayfinding pylon
②	S-3000 - 2	1500mm high illuminated wayfinding monolith
③	S-3000 - 3	1500mm high monolith wayfinding sign
④	S-3000 - 4	1500mm high monolith wayfinding sign
⑤	S-3000 - 5	1400mm high monolith wayfinding sign

DIGITAL SIGNAGE

REF.	DWG DETAIL	SIGNAGE DESCRIPTION
s1	e-301	1330mm high back-lit Ferrari name

BUILDING SIGNAGE

REF.	DWG DETAIL	SIGNAGE DESCRIPTION
w1	w-300 - 1	1330mm high back-lit Ferrari name
w2	w-300 - 2	2000mm high back-lit Ferrari Prancing Horse
w3	w-300 - 3	511mm high back-lit HR Owen name
w4	w-300 - 4	310mm high back-lit 'Service' and 600mm high Stop/ Go Traffic Lights
e1	e-301 - 1	1700mm high illuminated Bentley Sign 1700mm high illuminated Lamborghini Sign
e2	e-301 - 2	1700mm high illuminated Lamborghini Sign 1700mm high illuminated Bentley Sign
e3	e-301 - 3	1200mm high back-lit Maserati name
e4	e-301 - 4	1200mm high back-lit Maserati Trident
e5	e-301 - 5	348mm high back-lit HR Owen name
e6	e-301 - 6	290mm high back-lit HR Owen name
e7	e-301 - 7	600mm high 'Service' and matrix illuminated 600mm high Stop/ Go Traffic Lights
e8	e-301 - 8	Individual illuminated Brand Service Logos to a height of 7740mm above ground

...\\A.L.A.\Stationary LDS\LDS-Logo-RGB.jpg

Hertfordshire Office: Shaft Lodge, Lawrence End Road, Wotton Green LU2 8PH.
London Office: Oriol Buildings, 10 Margaret Street, London W1W 8RL.
T. 020 7979 2027 | London Office | T. 01438 833003 | Hertfordshire Office

FOR APPROVAL

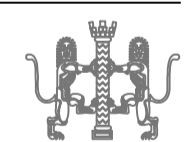

Client
HR Owen

Project
**HATFIELD BUSINESS PARK PLOT 5100
H.R.Owen Multi-Franchise Motor Dealership**

Drawing Title
**Ground Floor Site Plan
Signage Points**

Drawn	Date	Checked	Scale @ A1
NER	AUG 2022		1:500
Job No	Drawing No	Revision	Note
2018-22	S-1000		

