

Artificial grass by NottsSport Synthetic Turf installed by Playcubed, colour Olive Green or similar approved

Marshalls Fairstone Granite Eclipse Sawn Setts Colour Light for large areas, and Colour Dark for edges or similar approved

Marshalls Fairstone Sawn Sandstone King Size - Colour Autumn Bronze Multi or similar approved

Design Board Mocha by London Stone or similar approved

Moda Primo 4 outdoor sofa seating (see spec booklet) or similar approved

Westminster Madison Stacking Armchair and table (see spec booklet) or similar approved

Timber pergola with fabric protection / screening (see spec booklet) or similar approved

The Pot Company Polystone planters (see spec booklet) or similar approved

Illuminated planter by Illuminated Pots (see spec booklet) or similar approved

Roof Terrace Planting Schedule			
Shrubs			
Number	Species	Height	Pot Size
4 No.	Brachyglottis elaeagnifolia	30-40cm	3L
5 No.	Buxus sempervirens 'Aureovariegata'	30-40cm	3L
3 No.	Cytisus scoparius	30-40cm	3L
4 No.	Laurus nobilis	100-125cm	10L
6 No.	Lavandula intermedia 'Grosso'	30-40cm	3L
4 No.	Philadelphus 'Sybille'	30-40cm	3L
2 No.	Phormium 'Jester'	100-125cm	10L
2 No.	Photinia glabra 'Variegata'	100-125cm	10L
4 No.	Sarcococca hookerana digy. 'Purple Stem'	30-40cm	3L
6 No.	Zauschneria californica cana 'Dublin'	30-40cm	3L
Climbers			
Number	Species	Height	Pot Size
1 No.	Clematis armandii	40-60cm	3L
1 No.	Clematis montana 'Alba'	40-60cm	3L
1 No.	Jasminum beesianum	40-60cm	3L
3 No.	Lonicera periclymenum	40-60cm	3L
2 No.	Passiflora caerulea	40-60cm	3L
Grasses			
Number	Species	Pot Size	
6 No.	Miscanthus sinensis 'Morning Light'	3L	

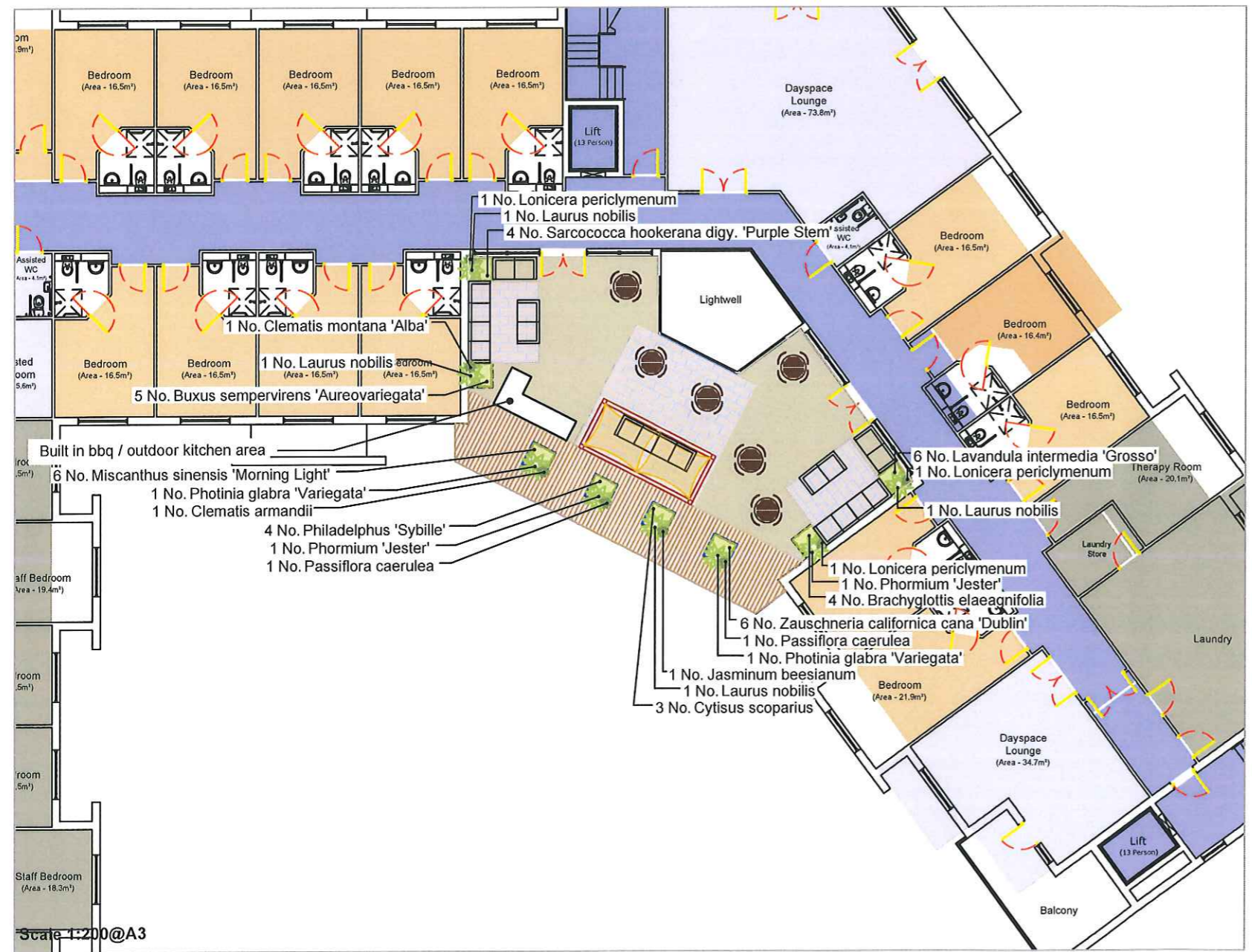
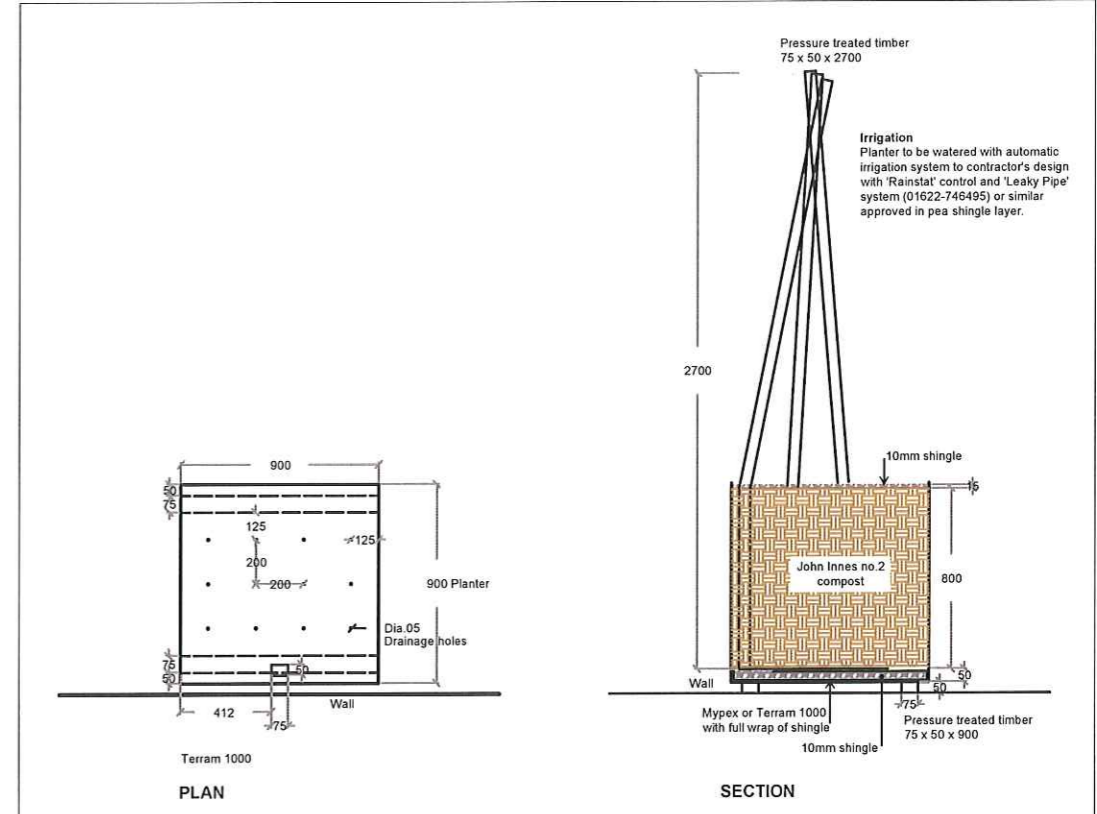

**ROOF TERRACE NOTES**

**Management**  
The planting is as shown in planters.

The planters are all raised above the roof paving and each has drainage holes in the base. The base drainage layer is enclosed in a geotextile to ensure that it is protected from the ingress of silt from the compost mix. The compost has a soil content, which has the advantages of better water retention, better nutrient retention and easier re-wetting when dry compared to an all organic compost.

The plants have been selected for their ease of establishment and suitability for the planters conditions.

Watering will be required for establishment and long term management. An automatic watering system with a 'Rainstat' control has been provided for each planter with a porous pipe system (Leaky Pipe or similar) in each planter. The operator must fully familiarise themselves with the operation of the system so that optimum watering is supplied and water is not wasted.

During the establishment phase watering will have to be checked up to twice a week to ensure that it is delivering water to each plan, depending on the weather. This is to re-wet the soil in the original compost the plant was growing in, as for several months there will not be significant water uptake from the compost around the rootball.

Future watering will be controlled by the setting of the automatic irrigation system to meet the water demands of the plants in this situation on a roof.

An annual fertiliser application should be made each March of 50 grams of Growmore to each square metre of surface area of the compost in the planter.

Pruning requirements will be determined as the plants grow and to suit the users of the roofs.

**HW & CO**

01622 437196 lydia@hwandco.co.uk www.hwandco.co.uk  
2 Keswick Drive, Maidstone, Kent ME16 0DQ Hill-Wood & Co (Kent) Ltd Company no. 1006666

**PLANNING**

Project - **HATFIELD CARE HOME, HATFIELD**

Drawing title **Landscape Planting Plan - roof terrace schedule and details**

Rev	Description	Date
A	Design amended	10.18

Scale	Date	Drawing number	Rev
As noted @A3	Jun 2017	0020/17/B/6A	

Scale 1:200@A3