

This scheme is subject to Town Planning and all other necessary consents. Dimensions, areas and levels where given are only approximate and subject to site survey. All dimensions are to be checked on site. All feasibility studies are subject to full site survey. This drawing is to be read in conjunction with all relevant consultants and/or specialist drawings/documents and any discrepancies or variations are to be notified to the architect in writing before the affected work commences. All queries relating to design of structural elements are to be referred to the structural engineering consultant for resolution. The workmanship and materials of all trades and building operations shall comply with the recommendations of British Standards (BS)800 parts 1-14, inclusive and with Approved Document 1 to support Regulation 7 1999 edition (incorporating 2000 amendments) of the Building Regulations 2010. All design and construction is to be in accordance with the Construction (Design and Management) Regulations 2015.

Rev	Date	Description	By
A	18.03.19	RAMP ADJUSTED	RGH
B	02.09.19	Amended to suit VE	MRW
C	21.04.20	5 Parking spaces omitted from SE side of building	MRW

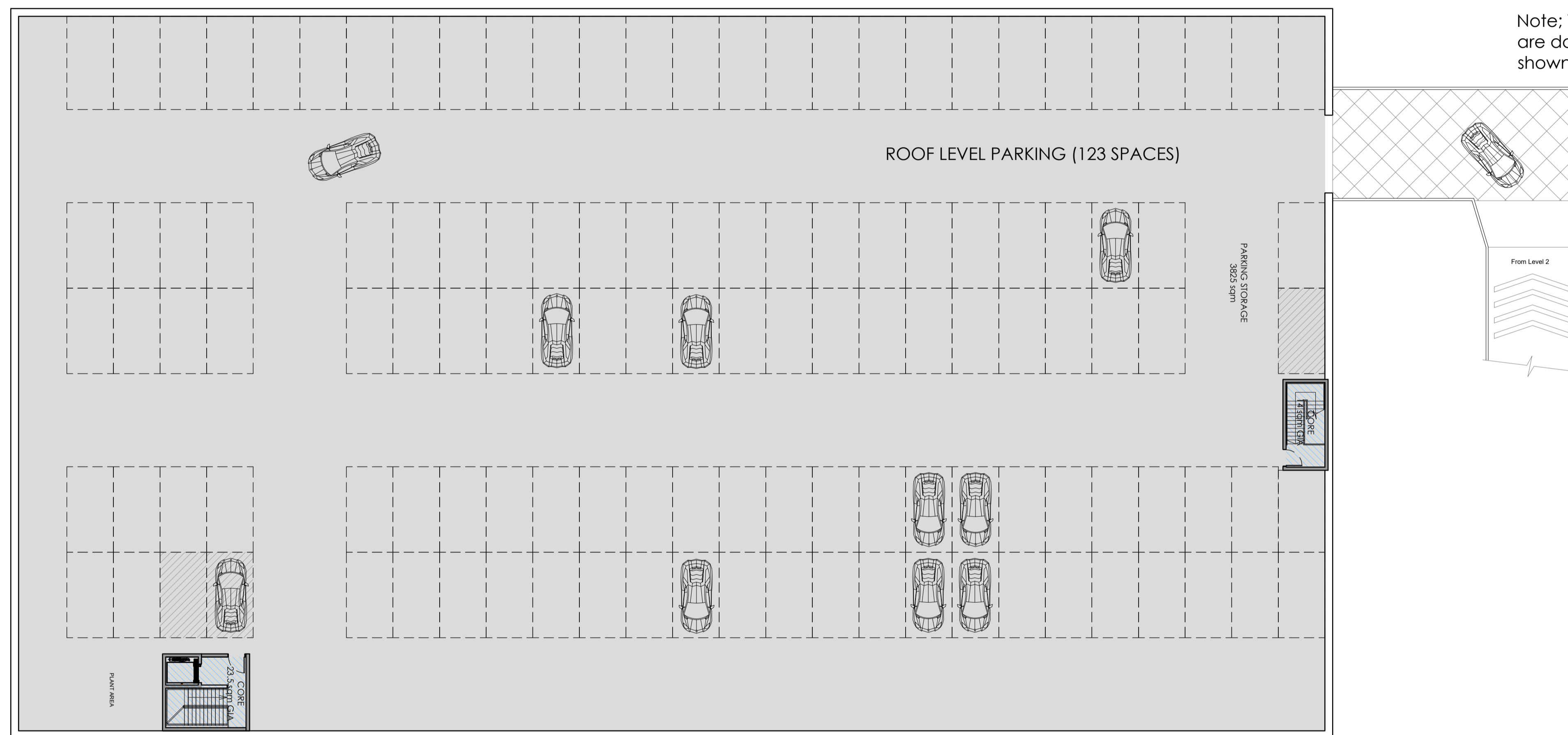

Note: Three spaces are double park bays, shown hatched

WEST BUILDING
HR OWEN PARKING
ROOF LEVEL PLAN

Louis de Soissons

Herefordshire Office: Shoot Lodge, Lawrence End Road, Wandon Green LU2 8PH.
London Office: Oriol Buildings, 10 Margaret Street, London W1W 8RL.
T. 020 7979 2027 | London Office | T. 01438 833003 | Herefordshire Office

PLANNING

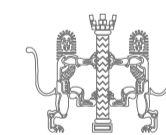

Client
Arlington Business Parks GP Ltd

Project
HATFIELD BUSINESS PARK PLOT 5100
H.R.Owen Multi-Franchise Motor Dealership

Drawing Title
Workshop C and West Showroom
Third Floor Roof Plan
Rooftop Car Parking and Plant

Drawn	Date	Checked	Scale @ A1
RGH	FEB 2019	MRW	1:200
Job No	Drawing No	Revision	Note
2018-22	C-190	C	

