

This scheme is subject to Town Planning and all other necessary consents. Dimensions, areas and levels where given are only approximate and subject to site survey. All dimensions are to be checked on site. All feasibility studies are subject to full site survey. This drawing is to be read in conjunction with all relevant consultants and/or specialist drawings/documents and any discrepancies or variations are to be notified to the architect in writing before the affected work commences. All queries relating to design of structural elements are to be referred to the structural engineering consultant for resolution. The workmanship and materials of all trades and building operations shall comply with the recommendations of British Standards (BS)800 parts 1-14, inclusive and with Approved Document 1 to support Regulation 7 1999 edition (incorporating 2000 amendments) of the Building Regulations 2010. All design and construction is to be in accordance with the Construction (Design and Management) Regulations 2015.

Rev	Date	Description	By
A	07.02.19	Building positions adjusted Building Grids reset. Ramp narrowed. Switchgear Block shown indicatively	RGH
B	22.02.19	Stair Cores Revised Parking at rooftop added and additional ramp Parapet level raised 1m.	RGH
C	07.03.19	Louvres to storage levels removed. Columns shown to ramp. Shopfront entrances revised. Roller shutter replaced with door at rear elevation.	RGH
D	18.03.19	Shading Revised	RGH
E	02.09.19	Amended to suit VE	MRW
F	04.12.20	Updated for Non Material Amendment Application - Refer to separate schedule of revisions.	RGH
G	11.12.20	Updated for Non Material Amendment Application - Refer to separate schedule of revisions.	RGH

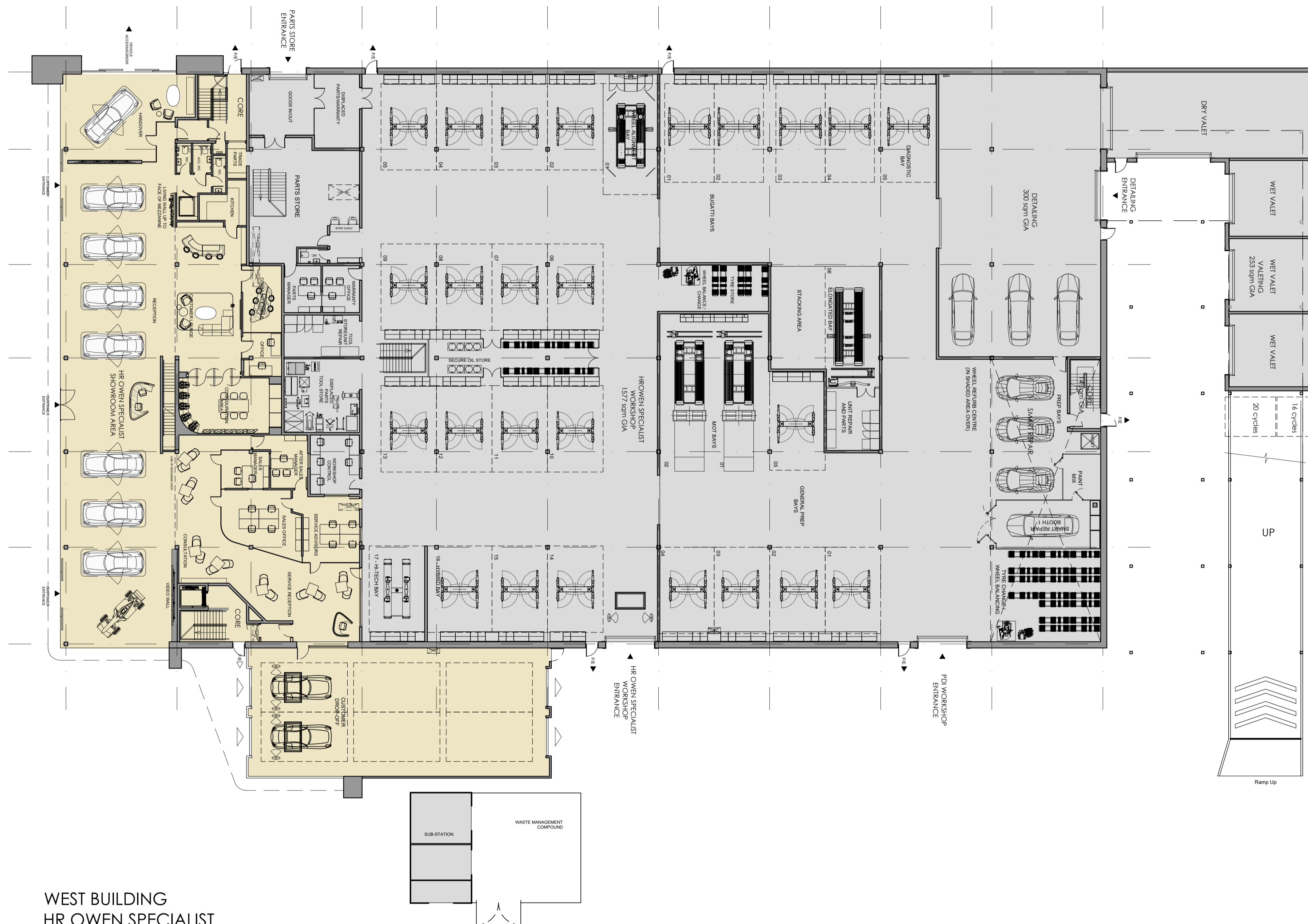

WEST BUILDING
HR OWEN SPECIALIST
SHOWROOM & PDI CENTRE
GROUND LEVEL PLAN

Louis de Soissons

Hertfordshire Office: Shoot Lodge, Lawrence End Road, Wotton Green LU2 8PH.
London Office: Oriol Buildings, 10 Margaret Street, London W1W 8RL.
T. 020 7979 2027 | London Office | T. 01438 833003 | Hertfordshire Office

PLANNING

Client
Arlington Business Parks GP Ltd

Project
HATFIELD BUSINESS PARK PLOT 5100
H.R.Owen Multi-Franchise Motor Dealership

Drawing Title
Workshop C and West Showroom
Ground Floor Plan

Drawn	Date	Checked	Scale @ A1
RGH	JAN 2019	MRW	1:200
Job No	Drawing No	Revision	Note
2018-22	C-160	G	

