

1. THE COPYRIGHT OF THIS DRAWING IS VESTED IN © AC DESIGN SOLUTIONS LTD AND IT MAY NOT BE REPRODUCED IN FULL, PART OR USED FOR THE MANUFACTURE OF ANY ARTICLE WITHOUT THE EXPRESS PERMISSION OF THE COPYRIGHT HOLDER.
2. **DO NOT SCALE FROM THIS DRAWING** ALL DIMENSIONS AND LEVELS TO BE CHECKED ON SITE AND VERIFIED BY THE CONTRACTOR PRIOR TO PURCHASING ANY MATERIALS.
3. ANY SPECIFICATION NOTED ON THESE DRAWINGS SHOULD BE **APPROVED BY BUILDING CONTROL** PRIOR TO PURCHASING ANY MATERIALS.
4. ALL DIMENSION ARE IN MM UNLESS NOTED OTHERWISE.
5. REPORT ALL DRAWING ERRORS, OMISSIONS AND DISCREPANCIES TO AC DESIGN SOLUTIONS LTD.
6. THE TEMPORARY WORKS AND THE STRUCTURAL INTEGRITY OF THE EXISTING AND PROPOSED STRUCTURES WITHIN AND ADJACENT TO THE WORKS ARE THE SOLE RESPONSIBILITY OF THE CONTRACTOR.
7. NO VARIATIONS TO THE DRAWINGS WILL BE PERMITTED WITHOUT THE WRITTEN APPROVAL OF AC DESIGN SOLUTIONS LTD.

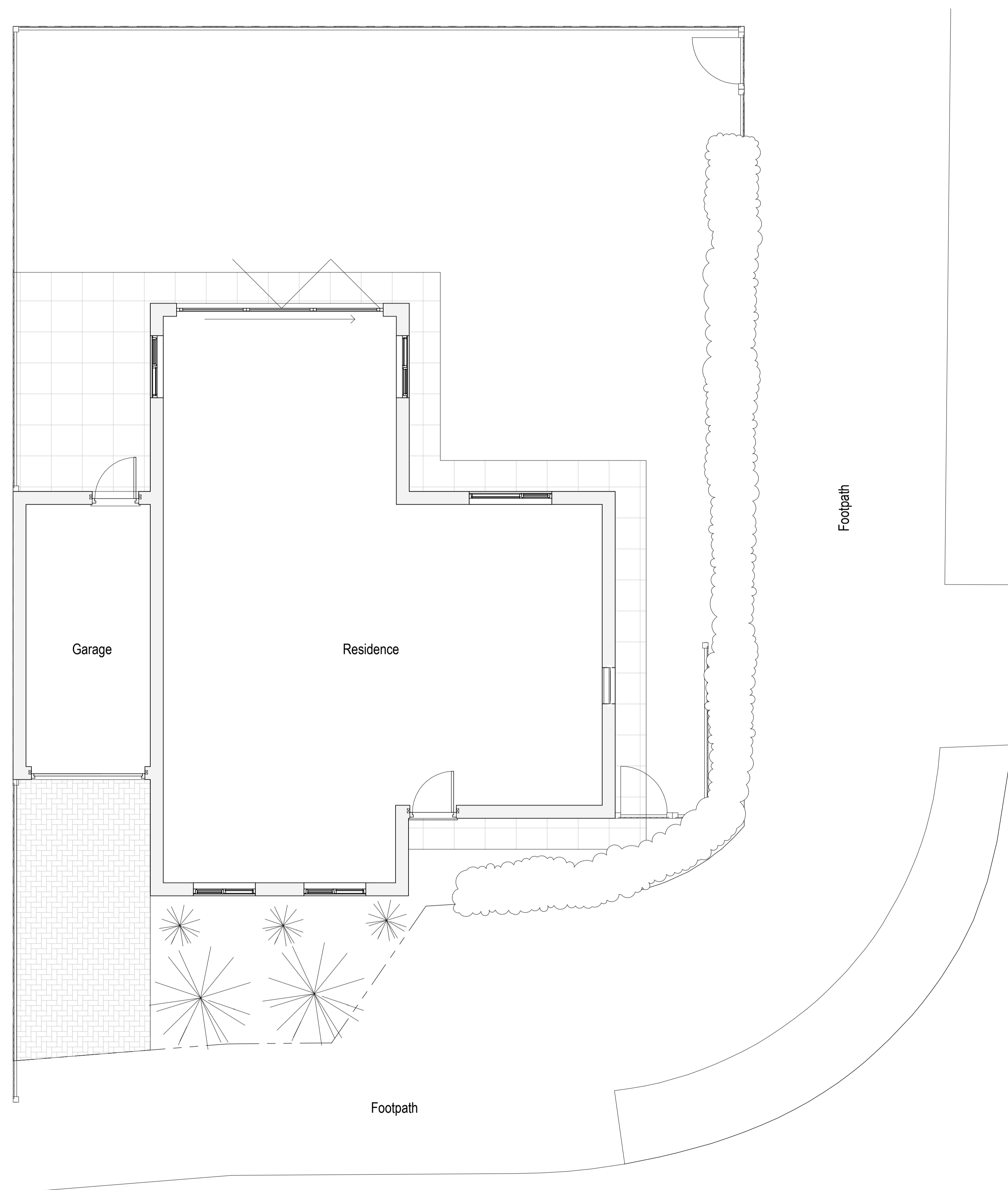

REV	DESCRIPTION	DATE	BY

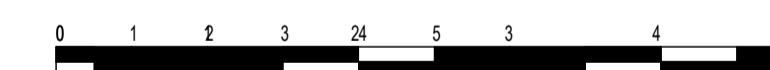

GRAPHIC SCALE: 1:50

PROJECT STATUS	PRELIMINARY		
PROJECT	2 Mulberry Mead, Hatfield, AL10 9EN		
TITLE	EXISTING PLANS		
CLIENT	Lina Chirandura		
DRAWN BY G.V.	CHECKED BY Z.C.	DATE 28.07.2023	SCALE (@A1) 1:50
DRAWING NUMBER	UK2201-TD-A-101		
PROJECT NUMBER	BUILDING CLASS	PHASE	REVISION
UK23054			

**1** 1. EXISTING GROUND FLOOR  
1:50