

© EIRENG CONSULTING ENGINEERS  
 This drawing and any design hereon is the copyright of the Consultants and must not be reproduced without their written consent. All drawings remain the property of the Consultants.  
 Figures dimension only to be taken from this drawing. All dimensions to be checked on site. Consultants to be informed immediately of any discrepancies before work proceeds.

**NOTE :-**  
 ALL MECHANICAL AND ELECTRICAL DETAILS TO SPECIALIST DESIGN

**LEGEND**  
 1114mm HIGH BOLLARD BEDDED IN CONCRETE

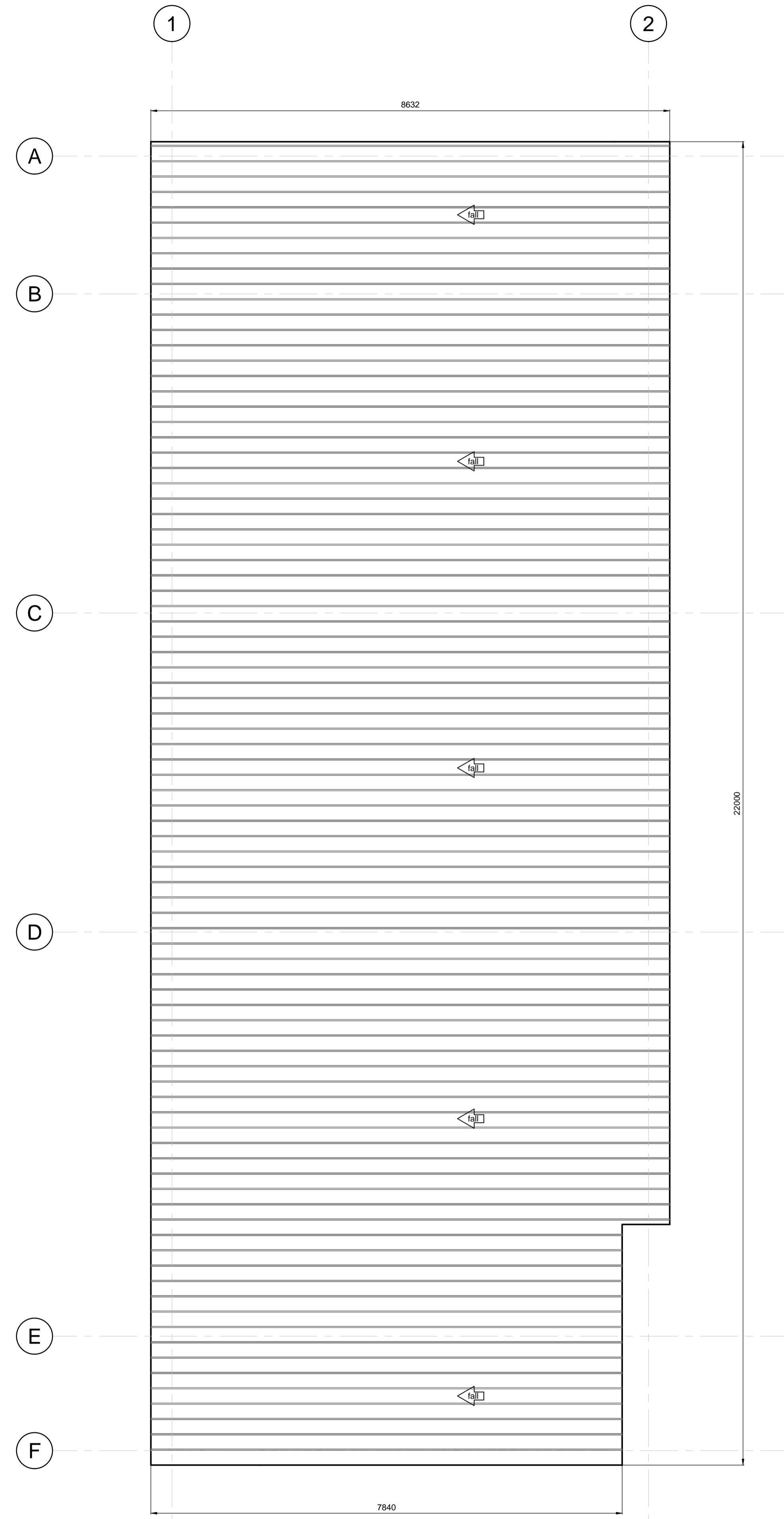
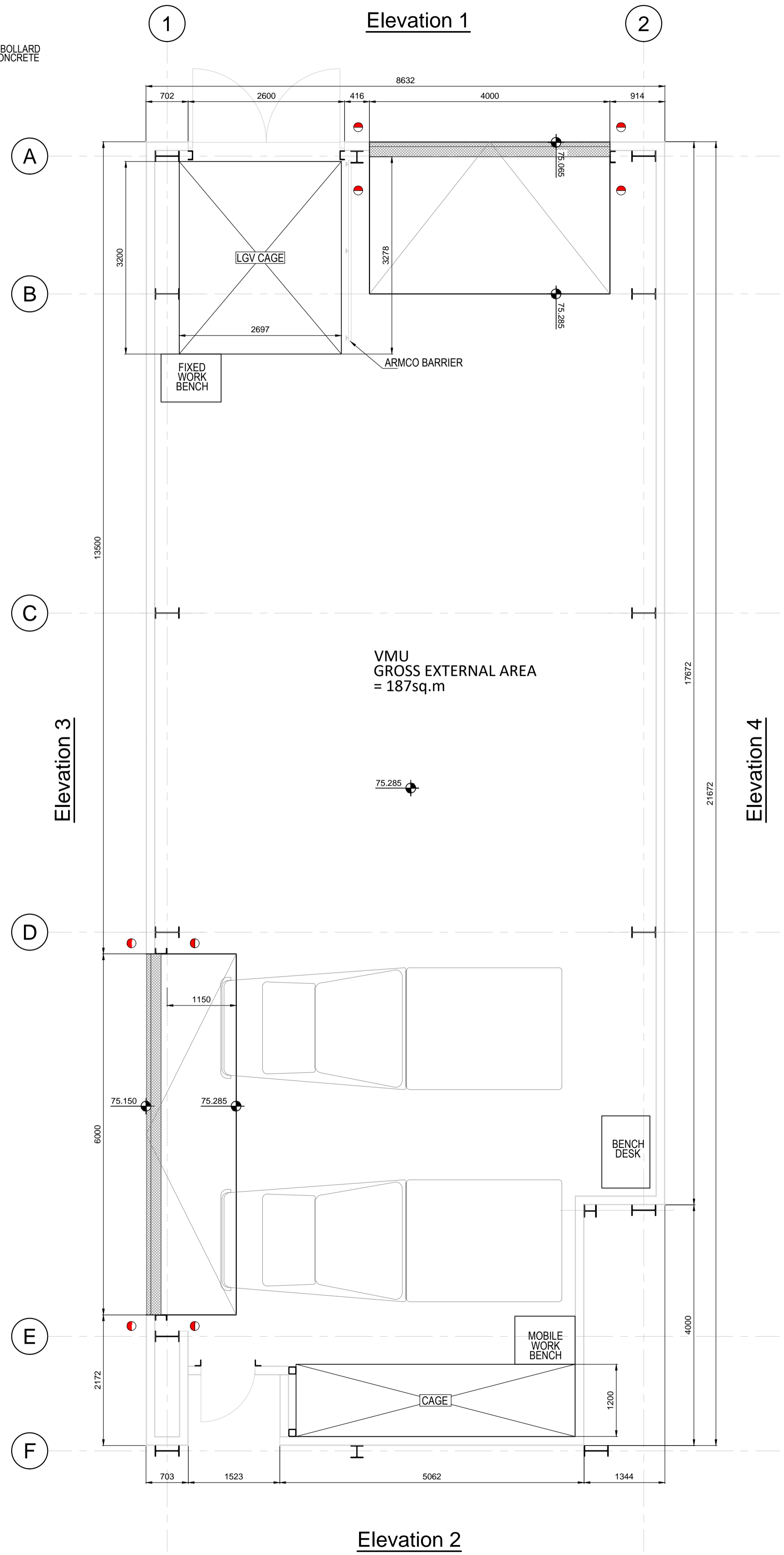

- NOTES**
- DRAWINGS ARE TO BE READ IN CONJUNCTION WITH ALL RELEVANT DESIGN DRAWINGS/ SPECIFICATIONS INCLUDING BUT NOT LIMITED TO OCADO'S SPECIFICATION USER REQUIREMENT FOR VEHICLE MAINTENANCE UNIT - CFC 1 HATFIELD
  - THE CONTRACTOR IS TO INSTALL APPROPRIATE LIGHTING THROUGHOUT THE BUILDING. THE LIGHTS ARE TO BE OF WHITE LED NATURE AND HAVE A MANUAL SWITCH CONTROL. THE LIGHT LEVEL SHOULD BE 250 LUX, AND COLOUR SHOULD BE 3500K.
  - THE CONTRACTOR IS TO INSTALL A SMOKE DETECTION SYSTEM THROUGHOUT THE BUILDING.
  - THE CONTRACTOR IS TO INSTALL APPROPRIATE PEST CONTROL MEASURES AROUND THE BUILDING.
  - THE CONTRACTOR IS TO INSTALL EXTERNAL LIGHTING AROUND THE WORKSHOP.
  - THE CONTRACTOR IS TO INSTALL AN EXTERNAL SIGN "VEHICLE MAINTENANCE UNIT" AT AN APPROPRIATE LOCATION AGREED WITH THE OCADO PROJECT MANAGER.
  - THE CONTRACTOR IS TO INSTALL A APPROPRIATE EMERGENCY LIGHTING AT ONE LUX AND PROCURE AND INSTALL RELEVANT FIRE CONTROLS E.G. FIRE EXTINGUISHER.
  - THE OCADO FURNITURE CONTRACTOR IS REQUIRED TO INSTALL ONE BENCH DESK THAT WILL BE PROCURED FROM THE RESERVES FROM OUR REMUS MAJOR SITE THAT MEASURES 1200 x 800mm BENCH DESK.
  - THE CONTRACTOR IS TO RELOCATE ANY EXISTING RACKING FROM THE CURRENT VMU AND REINSTALL WITHIN THE NEW UNIT BY THE VMU STORAGE CAGE.

REV	DATE	BY	DESCRIPTION
PL3	29.08.18	LL	ISSUED FOR PLANNING
PL2	16.08.18	JC	ISSUED FOR PLANNING
PL1	25.06.18	LL	ISSUED FOR PLANNING



**CLIENT**  
 HATFIELD NEW VEHICLE MAINTENANCE UNIT (VMU)

**DRAWING TITLE**  
 PROPOSED VMU FLOOR AND ROOF PLANS



DRAWN BY	L. Loneragan	DATE	10/08/18
ENG CHECK	E. Deasy	DATE	06.06.2018
APPROVED	J. Lamb	DATE	06.06.2018
SCALE	1:50	SHEET	A1
<b>STATUS</b> PLANNING			
JOB NO.	DRAWING NUMBER	REVISION	
182037	C004	PL3	

**VMU GROUND FLOOR PLAN**  
 SCALE 1:50

**VMU ROOF PLAN**  
 SCALE 1:50

