

**17.046 JLR Aston Martin, Maclaren External Lighting_JLR building Roof
Deck Car Park**

Partner for Contact:
Order No.:
Company:
Customer No.:

Date: 08.11.2017
Operator: Arkadiusz Gliszczynski

D&d Building Services Consulting Engineers Ltd
Kegworth House
28 Market Place, Kegworth, Derby, DE74 2EE

Operator Arkadiusz Gliszczynski
Telephone 01509670100
Fax 01509670110
e-Mail arkadiusz.gliszczynski@ddconsultingenieurs.co.uk

Table of contents

17.046 JLR Aston Martin, Maclaren External Lighting_JLR building Ro...	
Project Cover	1
Table of contents	2
Luminaire parts list	3
THORLUX SB16131 Starbeam SMART - Area Distribution - 62W	
Luminaire Data Sheet	4
THORLUX MER16702 Mercian LED SMART - 28W	
Luminaire Data Sheet	5
Exterior Scene 2	
Planning data	6
Luminaires (layout plan)	7
Calculation surfaces (results overview)	8
3D Rendering	9
False Colour Rendering	10
Exterior Surfaces	
Roof Deck Car Park	
Value Chart (E, Perpendicular)	11

D&d Building Services Consulting Engineers Ltd
Kegworth House
28 Market Place, Kegworth, Derby, DE74 2EE

Operator Arkadiusz Gliszczynski
Telephone 01509670100
Fax 01509670110
e-Mail arkadiusz.gliszczynski@ddconsultingenieurs.co.uk

17.046 JLR Aston Martin, Maclaren External Lighting_JLR building Roof Deck Car Park / Luminaire parts list

2 Pieces THORLUX MER16702 Mercian LED SMART - 28W
Article No.: MER16702
Luminous flux (Luminaire): 2632 lm
Luminous flux (Lamps): 2632 lm
Luminaire Wattage: 34.0 W
Luminaire classification according to CIE: 74
CIE flux code: 21 46 74 74 100
Fitting: 1 x Mercian LED - 28W (Correction Factor 1.000).

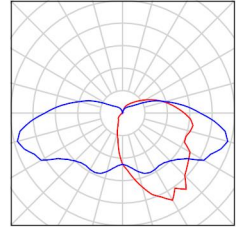

25 Pieces THORLUX SB16131 Starbeam SMART - Area Distribution - 62W
Article No.: SB16131
Luminous flux (Luminaire): 6708 lm
Luminous flux (Lamps): 6700 lm
Luminaire Wattage: 69.0 W
Luminaire classification according to CIE: 98
CIE flux code: 25 59 90 98 100
Fitting: 1 x Starbeam - Area - 62W (Correction Factor 1.000).

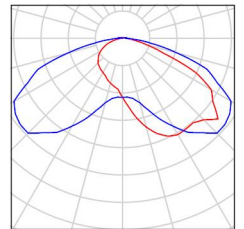

D&d Building Services Consulting Engineers Ltd
 Kegworth House
 28 Market Place, Kegworth, Derby, DE74 2EE

Operator Arkadiusz Gliszczynski
 Telephone 01509670100
 Fax 01509670110
 e-Mail arkadiusz.gliszczynski@ddconsultingenieurs.co.uk

THORLUX SB16131 Starbeam SMART - Area Distribution - 62W / Luminaire Data Sheet



Luminaire classification according to CIE: 98
 CIE flux code: 25 59 90 98 100

Supremely efficient long life IP66 pole top and wall mounted LED luminaires with aluminium cast body and wiring box and polycarbonate cover.

Luminous emittance 1:

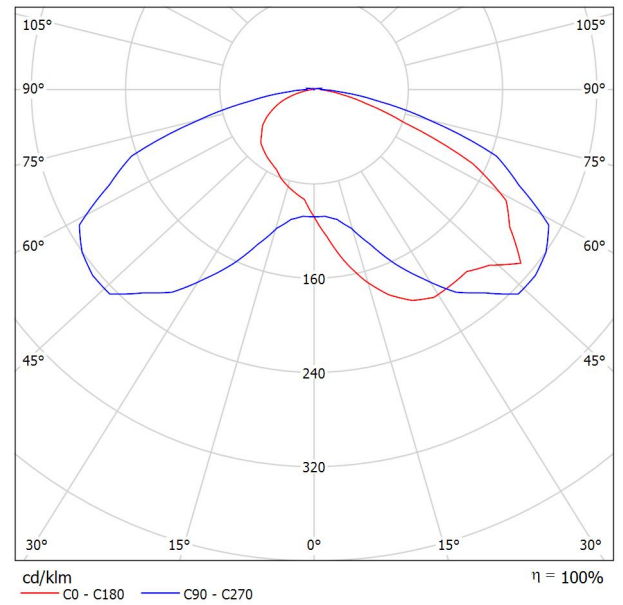

Due to missing symmetry properties, no UGR table can be displayed for this luminaire.

D&d Building Services Consulting Engineers Ltd
 Kegworth House
 28 Market Place, Kegworth, Derby, DE74 2EE

Operator Arkadiusz Gliszczynski
 Telephone 01509670100
 Fax 01509670110
 e-Mail arkadiusz.gliszczynski@ddconsultinengineers.co.uk

THORLUX MER16702 Mercian LED SMART - 28W / Luminaire Data Sheet



Luminous emittance 1:

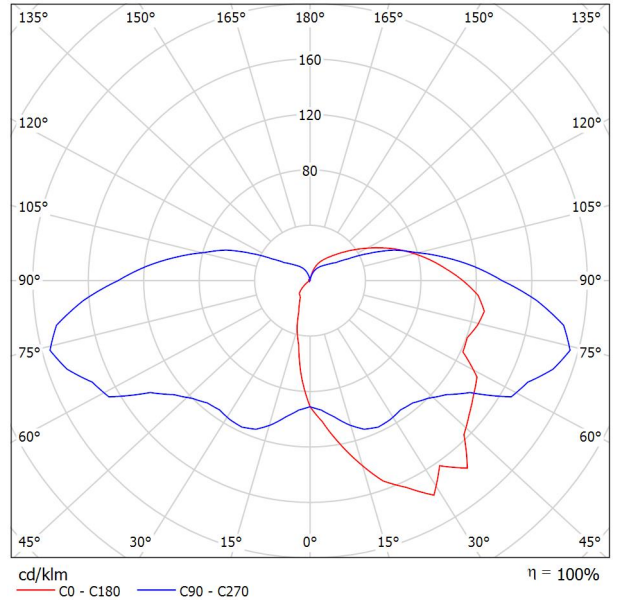

Luminaire classification according to CIE: 74
 CIE flux code: 21 46 74 74 100

Due to missing symmetry properties, no UGR table can be displayed for this luminaire.

Vandal resistant luminaires photometrically designed to achieve wide luminaire spacing. Die cast aluminium body and impact resistant, flame-retardant prismatic polycarbonate cover. New - LED version.

Applications: walkways and entrance areas, commercial premises, educational institutes and hospital/healthcare buildings.

D&d Building Services Consulting Engineers Ltd
 Kegworth House
 28 Market Place, Kegworth, Derby, DE74 2EE

Operator Arkadiusz Gliszczynski
 Telephone 01509670100
 Fax 01509670110
 e-Mail arkadiusz.gliszczynski@ddconsultingenieurs.co.uk

Exterior Scene 2 / Planning data

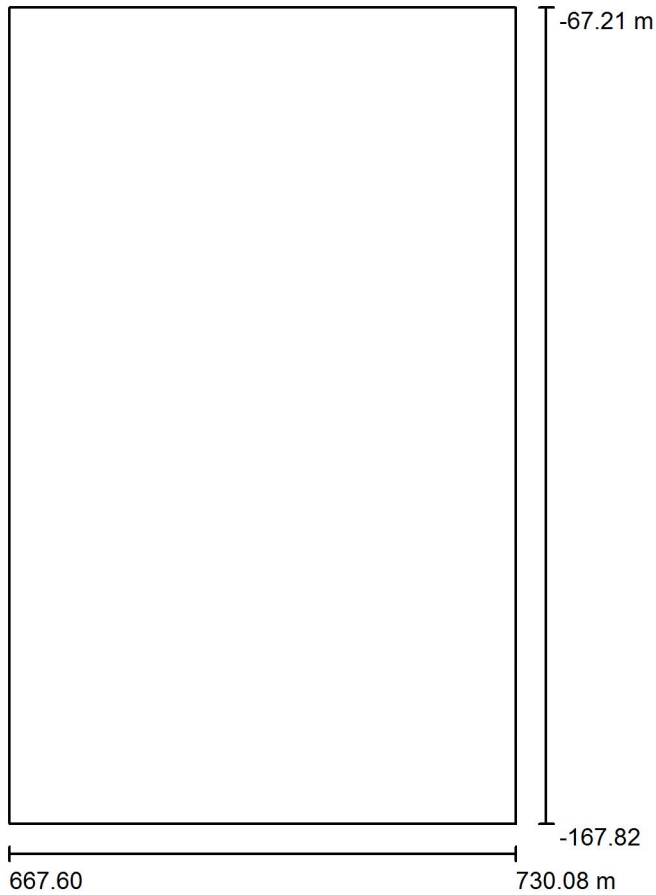

Maintenance factor: 0.80, ULR (Upward Light Ratio): 2.5%

Scale 1:933

Luminaire Parts List

No.	Pieces	Designation (Correction Factor)	Φ (Luminaire) [lm]	Φ (Lamps) [lm]	P [W]
1	2	THORLUX MER16702 Mercian LED SMART - 28W (1.000)	2632	2632	34.0
2	25	THORLUX SB16131 Starbeam SMART - Area Distribution - 62W (1.000)	6708	6700	69.0
			Total: 172966	Total: 172764	1793.0

D&d Building Services Consulting Engineers Ltd
 Kegworth House
 28 Market Place, Kegworth, Derby, DE74 2EE

Operator Arkadiusz Gliszczynski
 Telephone 01509670100
 Fax 01509670110
 e-Mail arkadiusz.gliszczynski@ddconsultinengineers.co.uk

Exterior Scene 2 / Luminaires (layout plan)

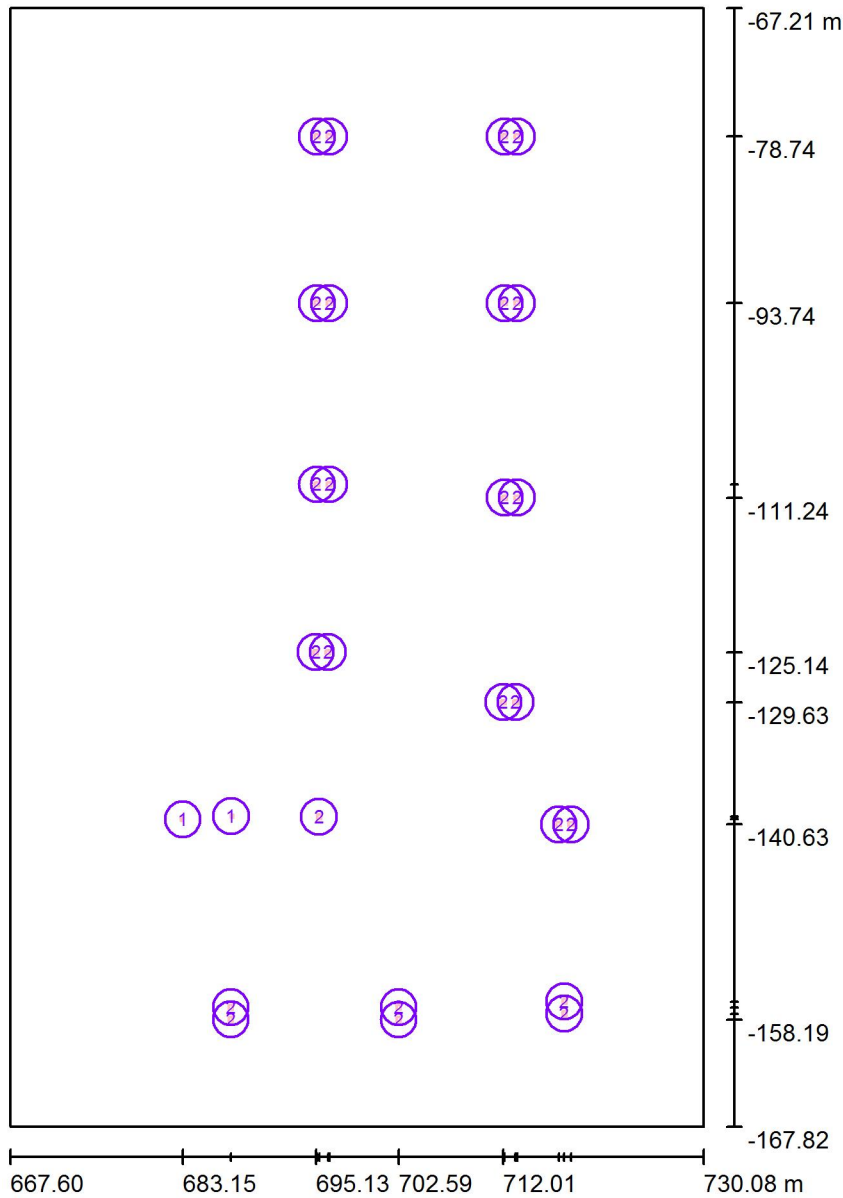

Scale 1 : 681

Luminaire Parts List

No.	Pieces	Designation
1	2	THORLUX MER16702 Mercian LED SMART - 28W
2	25	THORLUX SB16131 Starbeam SMART - Area Distribution - 62W

D&d Building Services Consulting Engineers Ltd
 Kegworth House
 28 Market Place, Kegworth, Derby, DE74 2EE

Operator Arkadiusz Gliszczynski
 Telephone 01509670100
 Fax 01509670110
 e-Mail arkadiusz.gliszczynski@ddconsultinengineers.co.uk

Exterior Scene 2 / Calculation surfaces (results overview)

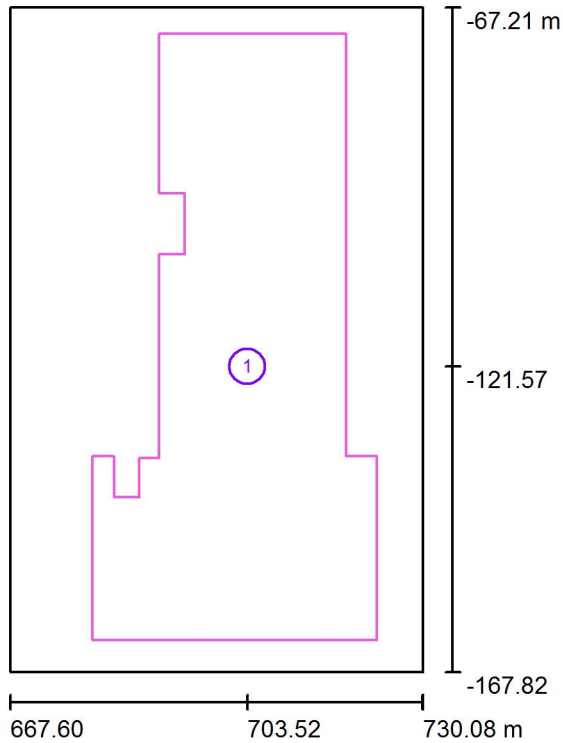

Scale 1 : 1145

Calculation Surface List

No.	Designation	Type	Grid	E_{av} [lx]	E_{min} [lx]	E_{max} [lx]	u0	E_{min} / E_{max}
1	Roof Deck Car Park	perpendicular	128 x 128	32	8.52	83	0.264	0.103

D&d Building Services Consulting Engineers Ltd
Kegworth House
28 Market Place, Kegworth, Derby, DE74 2EE

Operator Arkadiusz Gliszczynski
Telephone 01509670100
Fax 01509670110
e-Mail arkadiusz.gliszczynski@ddconsultinengineers.co.uk

Exterior Scene 2 / 3D Rendering

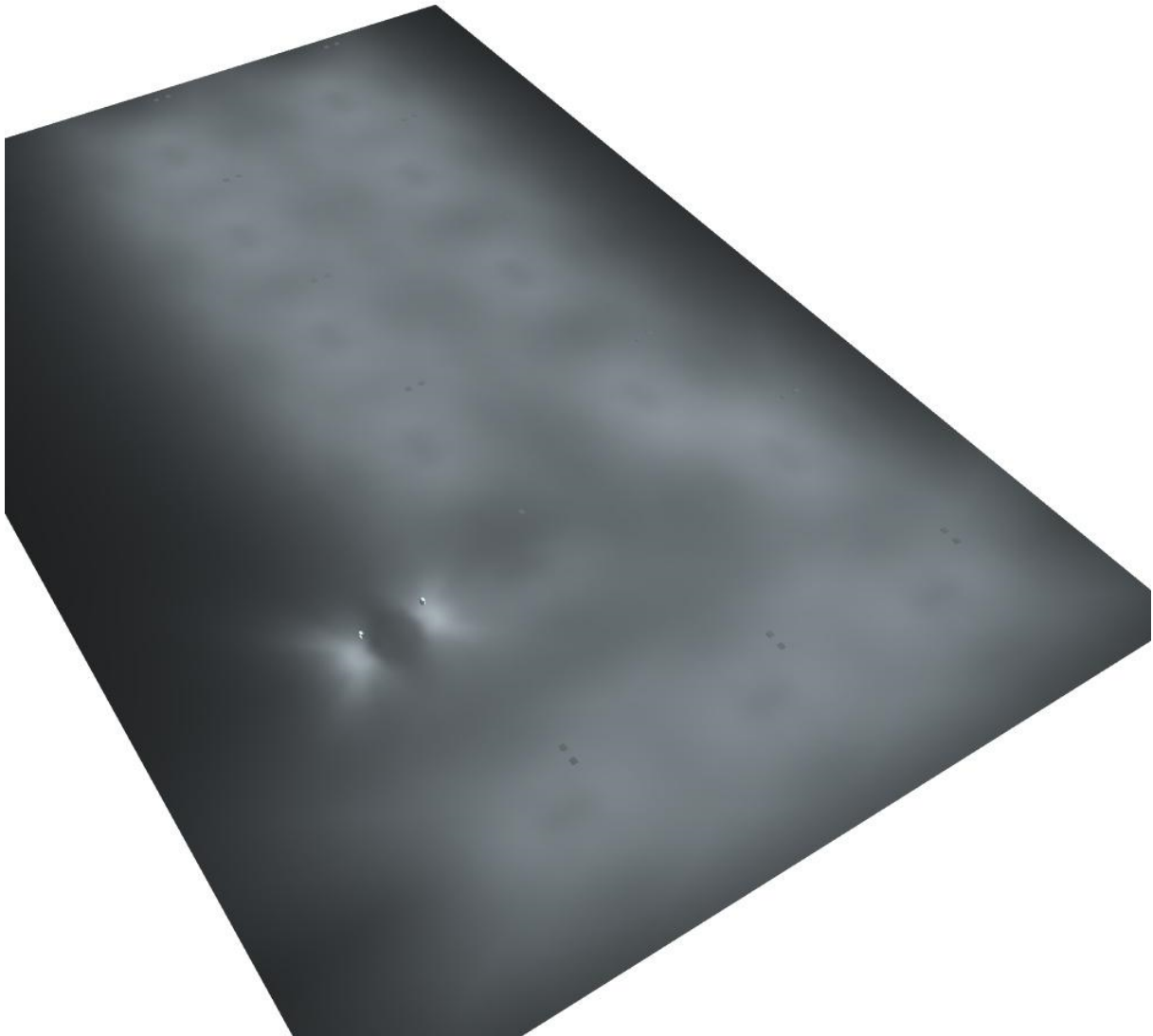

D&d Building Services Consulting Engineers Ltd
Kegworth House
28 Market Place, Kegworth, Derby, DE74 2EE

Operator Arkadiusz Gliszczynski
Telephone 01509670100
Fax 01509670110
e-Mail arkadiusz.gliszczynski@ddconsultinengineers.co.uk

Exterior Scene 2 / False Colour Rendering

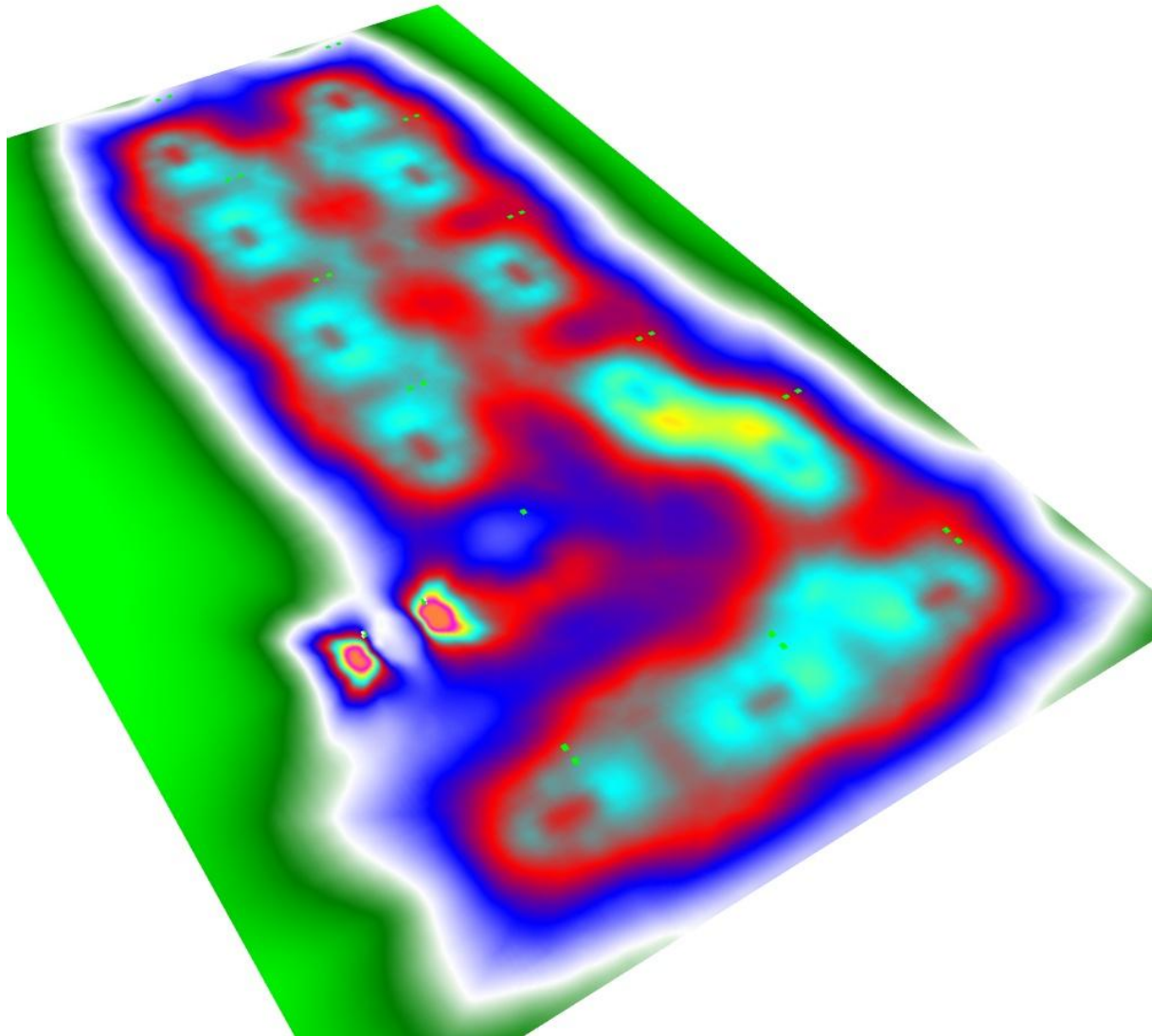

1 5 10 20 30 40 50 60 70 lx

D&d Building Services Consulting Engineers Ltd
 Kegworth House
 28 Market Place, Kegworth, Derby, DE74 2EE

Operator Arkadiusz Gliszczynski
 Telephone 01509670100
 Fax 01509670110
 e-Mail arkadiusz.gliszczynski@ddconsultingenieurs.co.uk

Exterior Scene 2 / Roof Deck Car Park / Value Chart (E, Perpendicular)

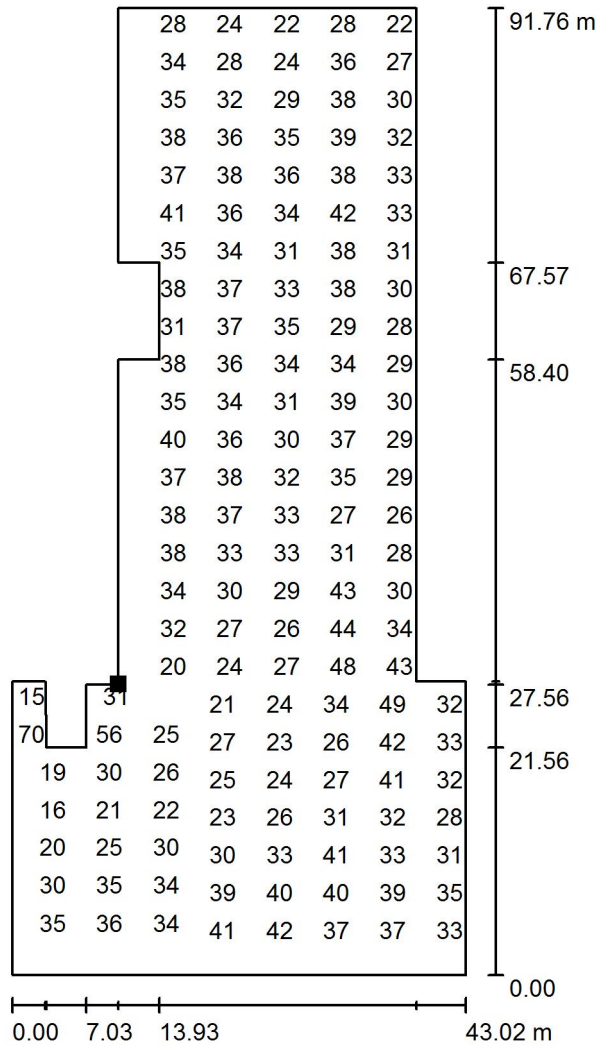

Values in Lux, Scale 1 : 718

Not all calculated values could be displayed.

Position of surface in external scene:
 Marked point:
 (690.186 m, -135.400 m, 0.000 m)

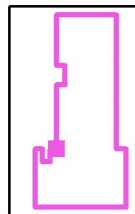

Grid: 128 x 128 Points

E_{av} [lx]	E_{min} [lx]	E_{max} [lx]	u_0	E_{min} / E_{max}
32	8.52	83	0.264	0.103