

NEW CONCRETE GROUND FLOOR TO ACHIEVE A U-VALUE OF 0.18W/m²K AS PER CELOTEX U-VALUE CALCULATION

ALL PRODUCTS ARE TO BE INSTALLED IN ACCORDANCE WITH MANUFACTURERS DETAILS/ INSTRUCTIONS/ SPECIFICATIONS

25mm Celotex insulation upstand to be installed to entire floor perimeter.

Floor finish to be installed over min 75mm cement:sand screed with UFH on polythene membrane (min 500 gauge) over 75mm Celotex FR5000 insulation laid on polythene DPM placed directly on floor structure.

Polythene DPM - minimum 2000 gauge, lapped and sealed to DPC below threshold

New reinforced concrete floor slab to structural engineers specification

min 50mm concrete blinding to S/eng design

Foundations to Structural Engineer's design and specification

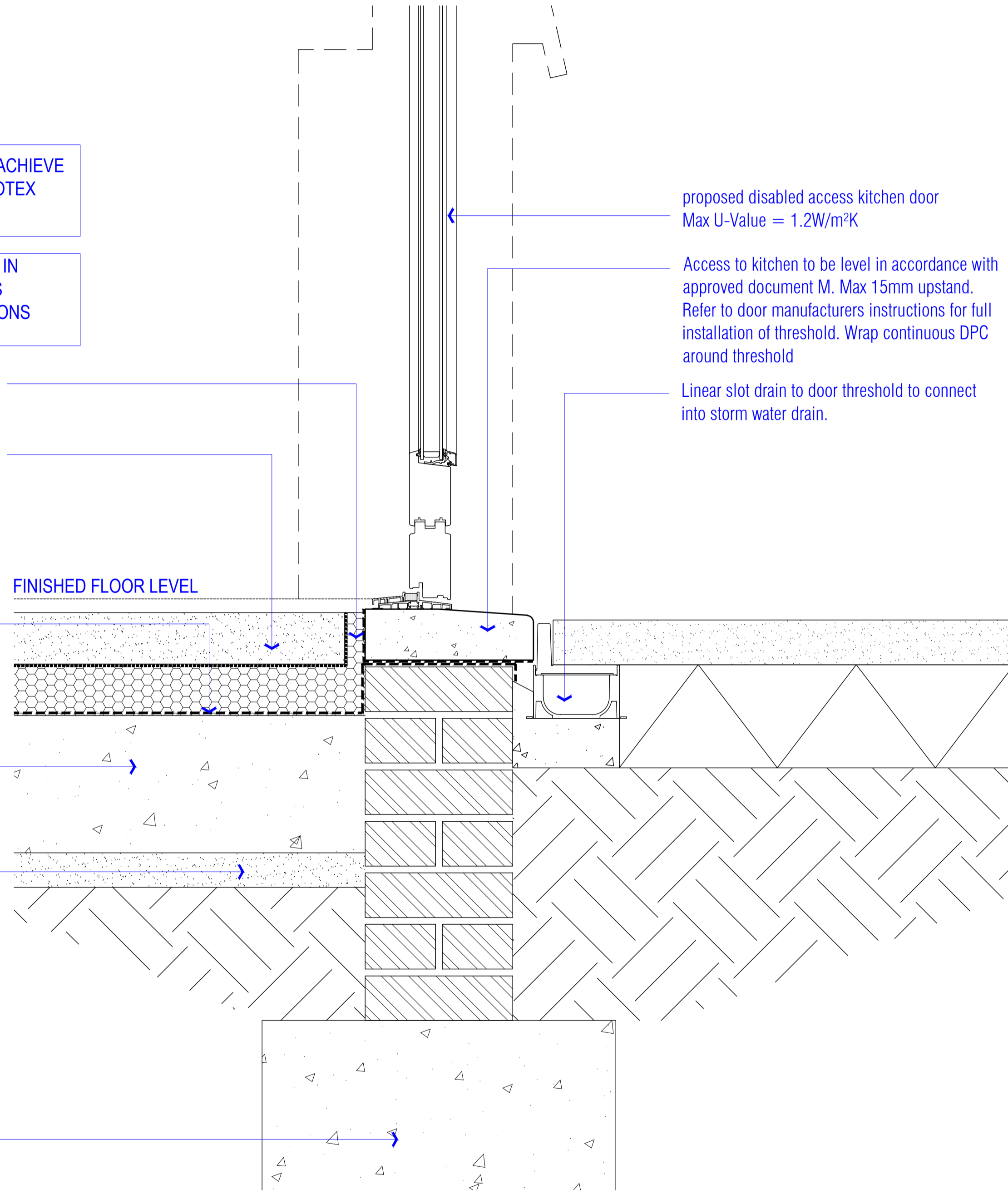

proposed disabled access kitchen door
Max U-Value = 1.2W/m²K

Access to kitchen to be level in accordance with approved document M. Max 15mm upstand. Refer to door manufacturers instructions for full installation of threshold. Wrap continuous DPC around threshold

Linear slot drain to door threshold to connect into storm water drain.

FINISHED FLOOR LEVEL

[01] LEVEL THRESHOLD DETAIL

Concrete Ground Floor U-Value 0.18W/m²K
Refer to U-Value calculation

All products are to be installed in accordance with manufacturers details/instructions and specifications

Contractor to confirm compatibility of floor screed/ under floor heating and insulation prior to installation

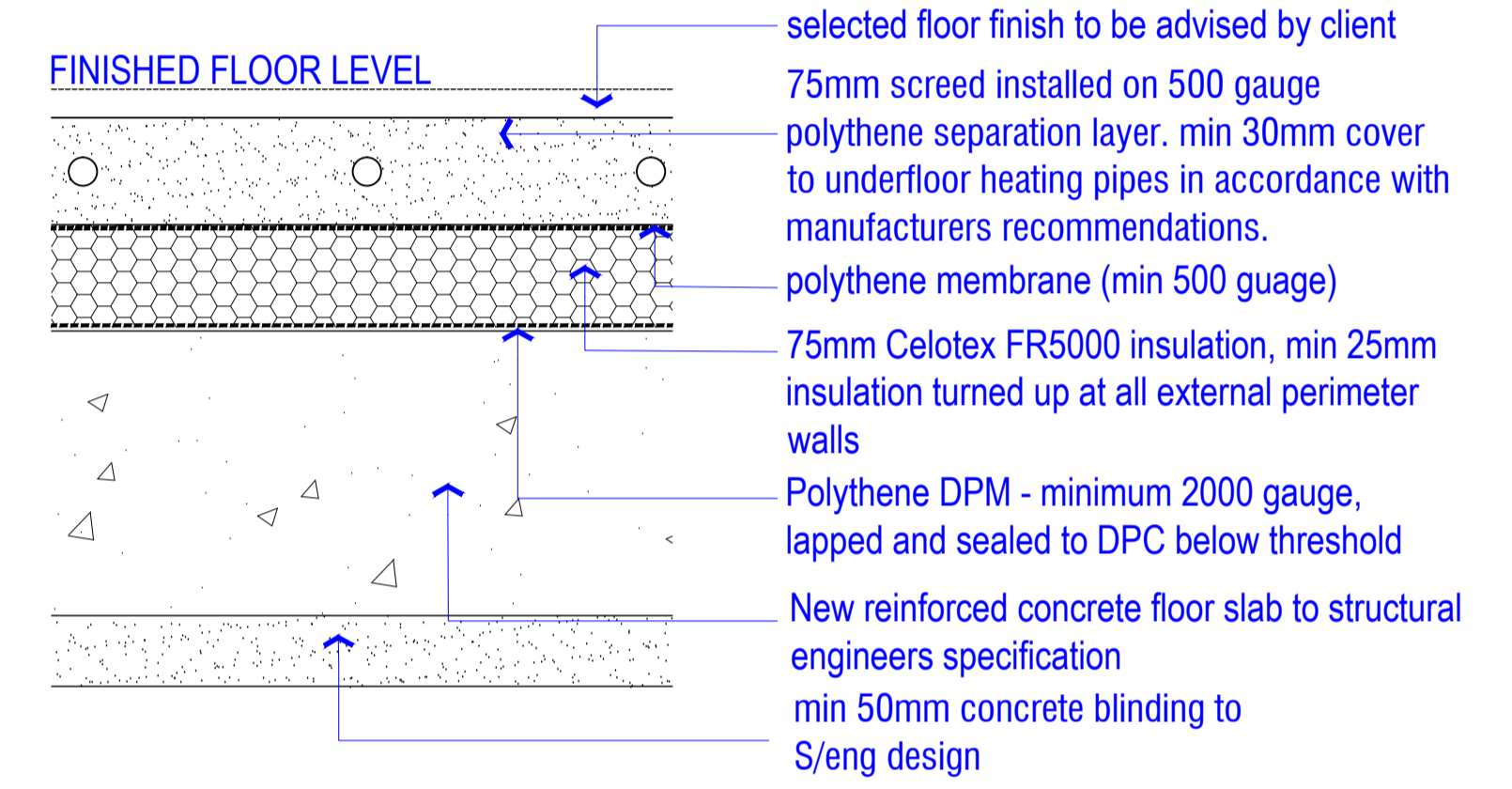

FINISHED FLOOR LEVEL

selected floor finish to be advised by client

75mm screed installed on 500 gauge polythene separation layer. min 30mm cover to underfloor heating pipes in accordance with manufacturers recommendations.

polythene membrane (min 500 gauge)

75mm Celotex FR5000 insulation, min 25mm insulation turned up at all external perimeter walls

Polythene DPM - minimum 2000 gauge, lapped and sealed to DPC below threshold

New reinforced concrete floor slab to structural engineers specification
min 50mm concrete blinding to S/eng design

[02] BARN FLOOR DETAIL

Concrete Ground Floor U-Value 0.18W/m²K
Refer to U-Value calculation

All products are to be installed in accordance with manufacturers details/instructions and specifications

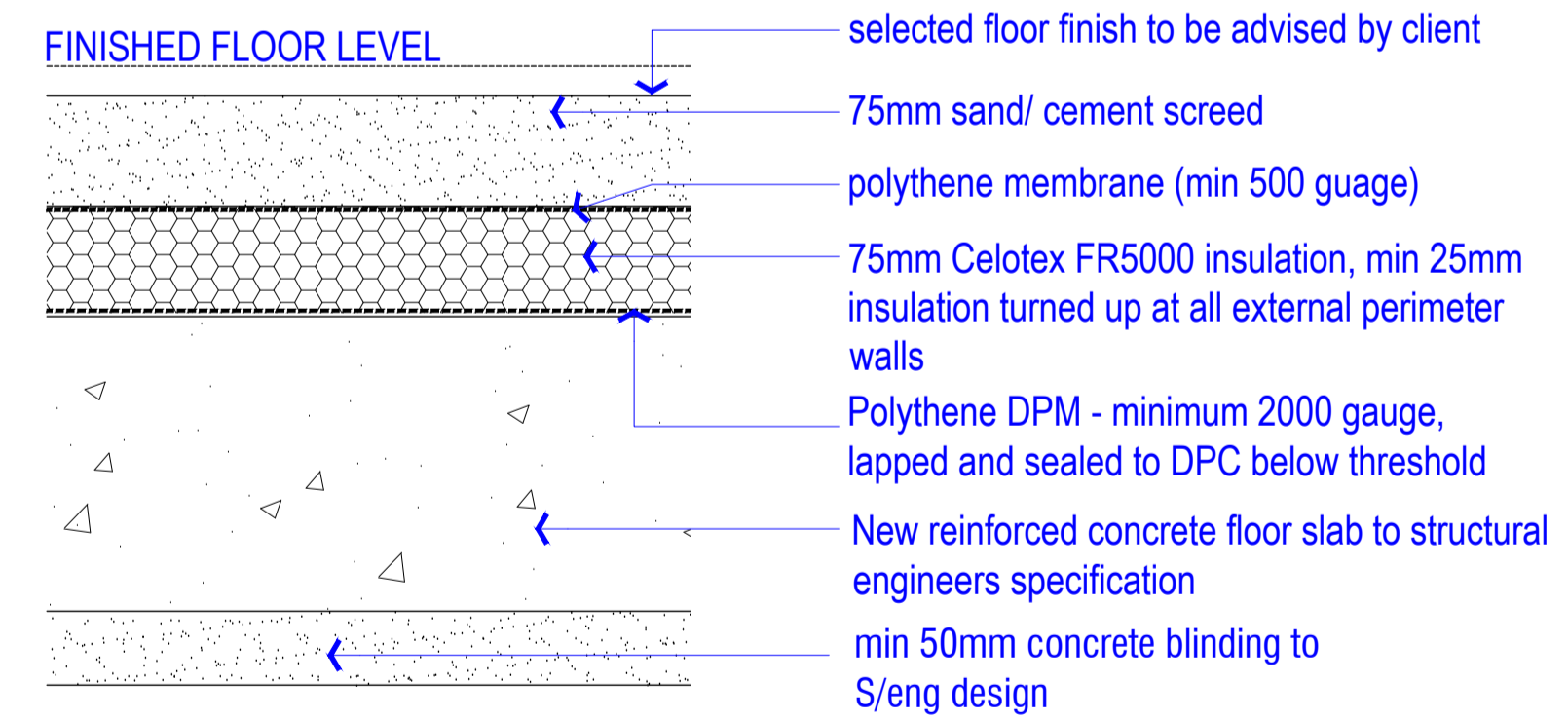

FINISHED FLOOR LEVEL

selected floor finish to be advised by client

75mm sand/ cement screed

polythene membrane (min 500 gauge)

75mm Celotex FR5000 insulation, min 25mm insulation turned up at all external perimeter walls

Polythene DPM - minimum 2000 gauge, lapped and sealed to DPC below threshold

New reinforced concrete floor slab to structural engineers specification
min 50mm concrete blinding to S/eng design

[03] KITCHEN FLOOR DETAIL

Scale 1:10

NOTE:
DO NOT SCALE FROM DRAWINGS - EXCEPT FOR PLANNING PURPOSES.
ALL DISCREPANCIES TO BE REPORTED TO ARCHITECT IMMEDIATELY.
ALL DIMENSIONS TO BE VERIFIED BY CONTRACTOR ON SITE PRIOR TO THE COMMENCEMENT OF ANY WORKS.

DOC 08/06/17 Issue for discharge of conditions application

ISO-A1	VIVENDI ARCHITECTS LTD		CLIENT	STATUS
	Unit E3U, Bounds Green Industrial Estate, Ringway, London N11 2UD		PRIVATE CLIENT	DOC
	Tel/Fax +44 (0)20 3232 4000		email: info@vivendarchitects.com	SCALE AT: 1:10
	© Vivendi Architects Ltd 2016		All rights reserved. Nothing is to be published in the Copyright, Design and Patents Act 1988	REVISION: BR1
PROJECT TITLE				JOB AND DRAWING NO:
GREAT NAST HYDE HOUSE, WILKIN'S GREEN LANE, HATFIELD AL10 9RB				1630-BRDT-05
DRAWING TITLE				
Proposed Floor Details				