

North Access Visibility Splay 1:500

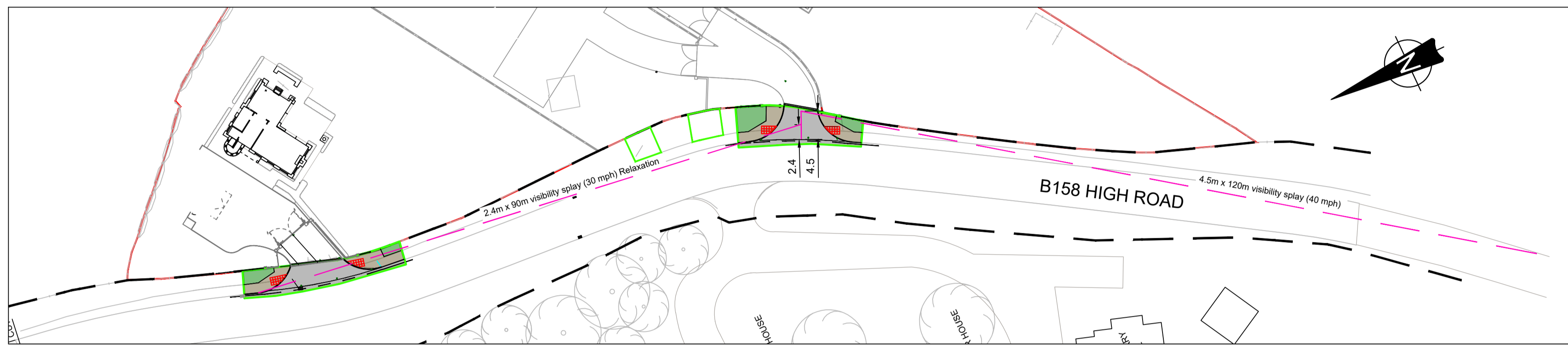

South Access Visibility Splay 1:500

**Key**

- Site boundary
- Extent of Section 278 works
- Adoptable carriageway
- Adoptable footway
- Adoptable verge

**Key Cont:**

- Existing kerbline
- Proposed kerbline
- [1009] TSRGD road markings diagram reference
- Proposed new road sign
- Proposed Granite Setts for Highway demarcation (Private)
- Existing Highway drain inspection chamber
- Proposed Highway drain inspection chamber
- Highway Boundary
- Vehicular visibility splays
- Uncontrolled Tactile paving in accordance with DfT 'Guidance on the Use of Tactile Paving Surfaces'
- Proposed gully & connection
- Existing gully & connection
- Existing highway drain
- Replacement highway drain concrete pipe. Fall and diameter to match existing



Section 278 Works (New Southern Vehicle Access) Scale 1:200

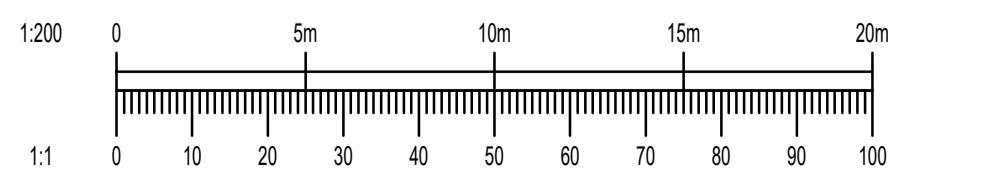

Section 278 Works (Existing Northern Vehicle Access Widened) Scale 1:200

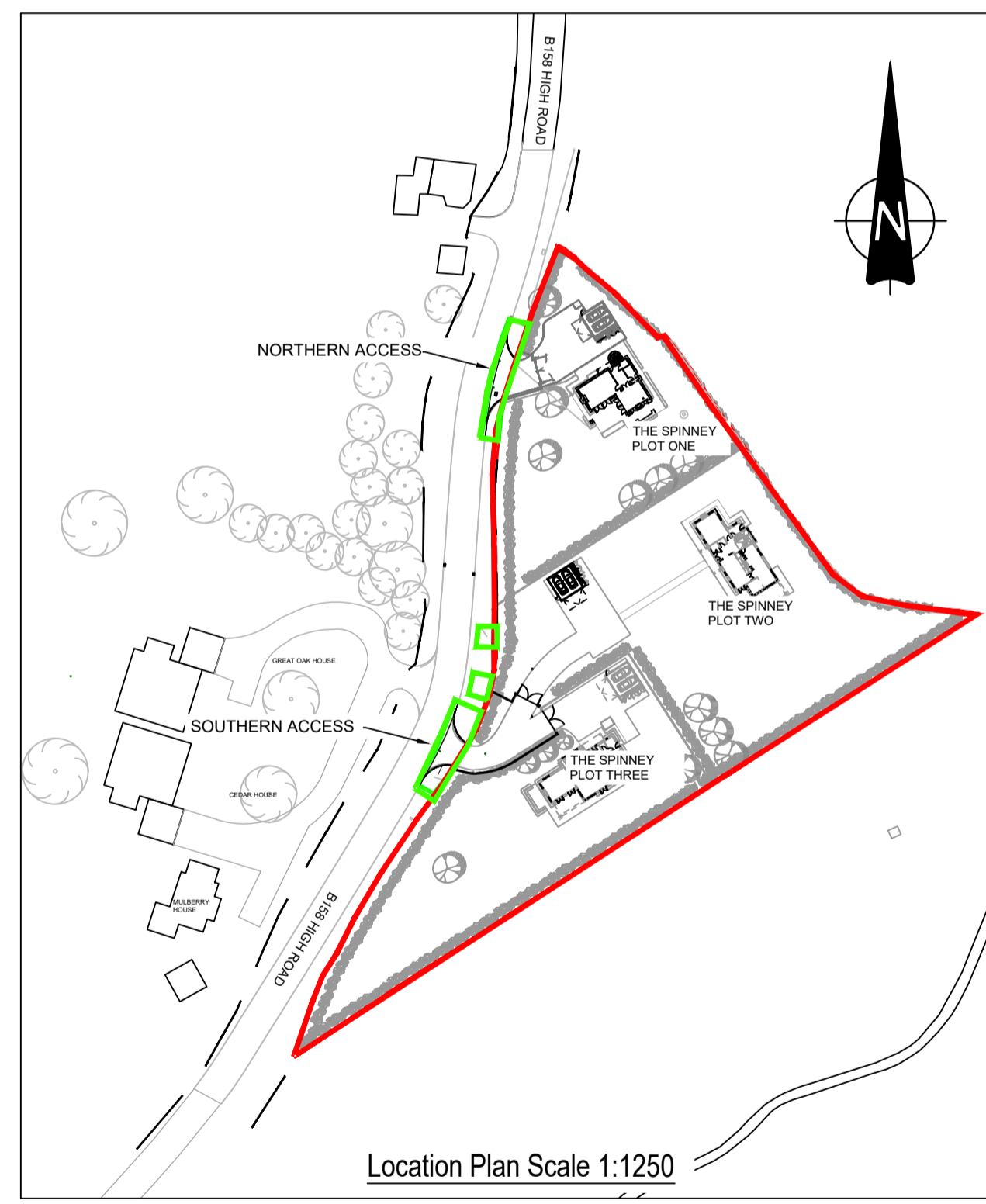
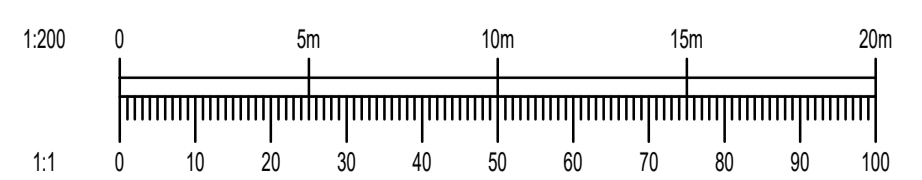

Location Plan Scale 1:1250

**SAFETY, HEALTH AND ENVIRONMENTAL INFORMATION**  
**UNUSUAL SIGNIFICANT HAZARDS**

It is assumed that all works will be carried out by a competent contractor working, where appropriate, to an approved method statement.

In addition to the hazards/risks normally associated with the types of work detailed on this drawing, note the following:

**CONSTRUCTION**  
 1. Care to be taken when installing the accesses and sign post foundations. Checks to be undertaken prior to excavation to confirm the presence of buried services.  
 2. Traffic Management to take into account of reduced visibility to northern access to/from the south.

**MAINTENANCE / CLEANING**  
 1. None

**DECOMMISSIONING / DEMOLITION**  
 1. None

This drawing should not be scaled. Dimensions to be verified on site. Any discrepancies should be referred to the Engineer prior to work being put in hand.

This drawing is the property of Waterman Infrastructure & Environment Limited, and the drawing is issued on the condition that it is not copied, reproduced, related or disclosed to any unauthorised person, either wholly or in part without the consent in writing of Waterman Infrastructure & Environment Limited  
 Pickfords Wharf, Click Street, London SE1 9DG 1 020 7928 7888 1 03333 444 501

**GENERAL NOTES**

- Notes:
- This drawing is to be read in conjunction with Waterman set of drawings, namely Drawings 15999-WIE-ZZ-XX-DR-C-95002 to 95006.
  - The works shall be in accordance with Roads in Hertfordshire: Highway Design Guide <http://www.hertsdirect.org/services/transstreet/devmanagement/roadsinherths/> and Highways England MCHW/ SHW specification.
  - Visibility distance in line with DMRB standard TD42/95 Table 7/1 for speed limit 40mph where X=4.5m and Y=120m or where relaxation was permitted to 30mph (X=2.4m and Y=90m). Relaxation was agreed with HCC during the planning application and transport statement - refer to the "Transport Statement Cl 2.2.11 and Table 2.1" dated 16th March 2018 for further details.
  - The site boundary shown is in accordance with Land Registry documents
  - Public Utility apparatus in area of works affected (Vehicle Accesses) are shown based on:
    - Details provided on sketch drawing 1610-SK-03052019 provided to Waterman by Chassay Studio Limited in May 2019.
    - Utility information taken from "Landmark Information Group Ltd" (dated 22/03/2019)
 The position of apparatus given on the drawing are shown on the drawings provided by the statutory undertakers and are intended as a guide only, without guarantee their position or extent of which should be ascertained by the contractor.
  - Drawing shows the accesses with fall gradient towards the carriageway surface.
  - At back of each access, 2 rows of granite setts are provided along the highway boundary for demarcation. Surface water runoff high point at the highway boundary.
  - Existing and proposed levels at vehicle access locations are shown on drawing no 1599-WIE-ZZ-XX-DR-C-95004
  - Vehicle access construction designed in accordance with HCC highway design guide section 4 - Design standards Clause 1.15.1 for occasional heavy vehicle loading.
  - Existing and proposed Kerbs at vehicle access locations are shown on drawing no 1599-WIE-ZZ-XX-DR-C-95004

Rev	Date	Description	By
P08	09.06.20	AMENDMENTS AS TO HCC'S OFFICERS EMAIL COMMENTS RECEIVED ON 29.05.2020	MG
P07	18.05.20	AMENDMENTS AS TO HCC'S OFFICERS COMMENTS RECEIVED ON 21.04.2020	MG
P06	11.03.20	MINOR AMENDMENT TO DRAWING TEXT	MG
P05	03.03.20	REMOVAL OF LINEAR DRAIN AND REPLACED WITH GRANITE SETTS TO SHOW HIGHWAY DEMARCATION AND SITE LEVEL ADJUSTMENT	MG
P04	11.02.20	RELOCATION OF INSPECTION CHAMBER AND GULLY ON THE NORTHERN ACCESS	MG
P03	10.02.20	AMENDMENTS TO DESIGN BASED ON TRIAL HOLE INFORMATION	MG
P02	26.11.19	AMENDMENTS TO DESIGN BASED ON HCC COMMENTS	CTI
P01	30.08.19	FIRST ISSUE	CTI

Project: **THE SPINNEY**

Title: **B158 HIGH ROAD, ESSENDON S278 WORKS GENERAL ARRANGEMENT**

Client: **ESSENDON PROPERTY VENTURES LTD**

**Waterman**

Pickford Wharf, Click Street, London, SE1 9DG  
 020 7928 7888  
 mail@watermangroup.com www.watermangroup.com

Status: **FOR APPROVAL**

Designed By: CTI Checked By: JH/MP Waterman Ref: WIE15999  
 Drawn By: CTI Date: AUGUST 2019 Scales @ A1: As shown

Project - Originator - Volume - Level - Type - Role - Number - Revision  
 15999-WIE-ZZ-XX-DR-C-95001 P08