

Salisbury Square

36

35

32

31

Batterdale

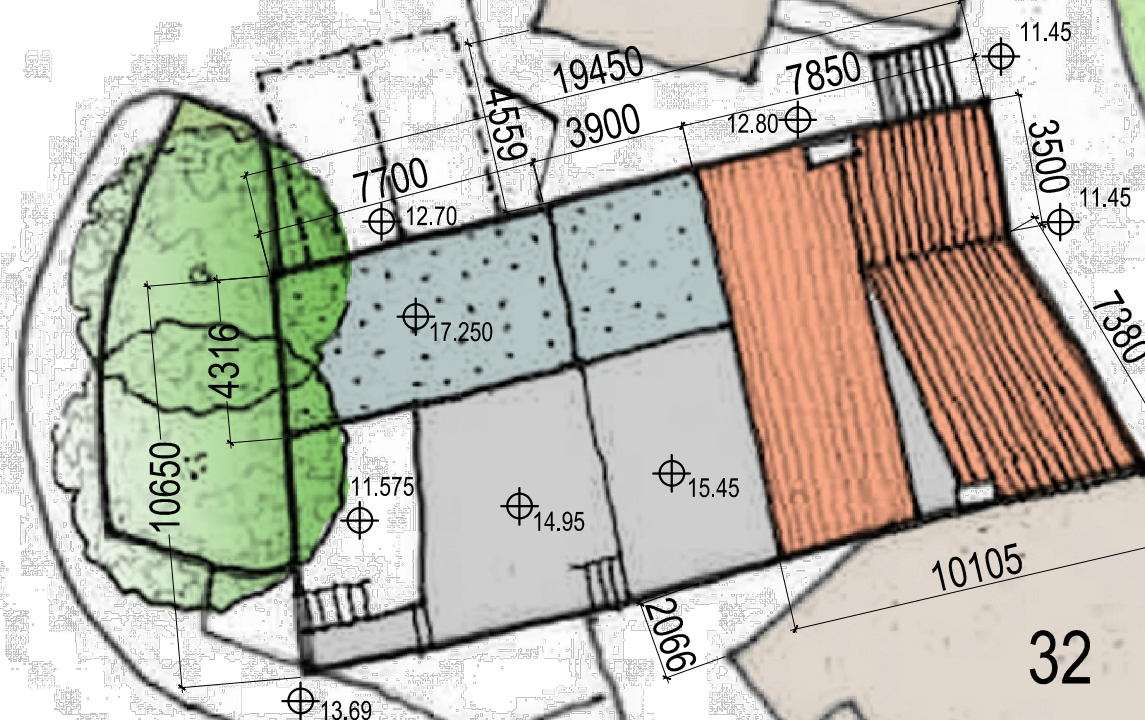

Rev	Date	Description	Drawn	Checked

Do not scale from this drawing  
 All dimensions are to be checked on site  
 Any discrepancies are to be reported immediately to the Architect or Main Contractor

**COPYRIGHT © 2014**  
 ALL RIGHTS DESCRIBED IN THE CHAPTER IV OF THE COPYRIGHT DESIGN AND PATENTS ACT 1988, HAVE BEEN GENERALLY ASSERTED

**Richard Morton Architects Ltd**  
 70 Cowcross Street, London, EC1M 6EJ  
 Tel: 0203 179 9030  
 Email: richard@rm-architects.com  
 Web: www.rm-architects.com

**Client**  
**M.A. Hussain-Hiam**

**Project**  
**33-34 Salisbury Square**  
**Hatfield AL9 5AF**

**Drawing**  
**Site Plan**

**Scale**  
 1:200@A3

Project No.	Drawing No.	Revision
154	120	A

Status	Date	Drawn by	Checked by
P	Oct17	HD	RM