

Refer to drawings:
 - COMET-STL-00-00-DR-L-ZZZZ-09001 Proposed Site Plan
 - COMET-STL-00-00-DR-L-ZZZZ-91010 Tree retention and removal plan
 - COMET-STL-00-00-DR-L-ZZZZ-91040 and 91041 Soft landscape plans
 - COMET-STL-00-00-DR-L-ZZZZ-91060 and 91061 Hard landscape plans
 - COMET-STL-00-00-DR-L-ZZZZ-94001 Tree pit in soft landscape
 - COMET-STL-00-00-DR-L-ZZZZ-94003 Bin store details
 - COMET-STL-00-00-DR-L-ZZZZ-94004 Cycle shelter details
 - COMET-STL-00-00-DR-L-ZZZZ-94005 Paving details
 - COMET-STL-00-00-DR-L-ZZZZ-99001 to 91005 Setout plans

ALL DRAINAGE, LEVELS, LIGHTING AND CCTV LOCATIONS TO ENGINEERS SPECIFICATION.

Note:
 Main contractor to determine exact location of services/drainage, this should be confirmed on site prior to commencement of works to avoid tree pit / services conflicts.

All foundations and base formations to Engineers design and specifications.
 All drainage details to Civil Engineers specification and details.

All manhole covers within concrete paving areas to be recessed. Manhole covers are to withstand the appropriate loading class within any given area, manufacture and product details are to be confirmed with the Engineer and Landscape Architect.

Levels to be determined following issue of full topo survey

This drawing assumes that the existing site subsoil could be re-used. However this is subject to detailed testing and analysis of the subsoil. If the subsoil is not suitable, imported subsoil will be required in accordance with the soft and base landscape specification.

All treatment of softwork areas to comply to BS4428 Code of Practice for general landscape operations.

All native shrub & hedge species plant type supplied for designated areas are to be determined by the proposed planting season. (ie bareroot or container grown stock).

DRAWING TO BE PRINTED IN COLOUR

| PL | REV | DATE | DESCRIPTION |
|-----|-----|------------|---|
| P07 | | 23.11.2017 | Reissued for Planning |
| P06 | | 09.11.2017 | Updates to landscape following issue of building survey |
| P05 | | 06.10.2017 | TENDER ISSUE |
| P04 | | 18.09.2017 | Tender Draft |
| P03 | | 15.09.2017 | Planning conditions |
| P02 | | 13.09.2017 | Issue For Comments |
| P01 | | 12.09.2017 | First Issue |

| STATUS | REV | DATE | DESCRIPTION | REVISED BY |
|--------|-----|------|-------------------------------------|---------------|
| CLIENT | | | Comet Hatfield Construction Limited | GAM |
| | | | | CHECKED BY |
| | | | | DK |
| | | | | ORIGINATOR NO |
| | | | | 150888 |

CONSULTANT
STRIDE TREGLOWN
 www.stridetreglown.com © Stride Treglown Limited 2016

PROJECT
 Hotel and Student Residential
 Comet Hotel Site

DRAWING TITLE
Hard Landscape and Furniture Plan Front of Site (Main Entrance)

SUITABILITY STATUS
 PL : PLANNING 1 : 250 @ A1

PROJECT | ORIGINATOR | ZONE | LEVEL | TYPE | ROLE | CLASSIFICATION | NUMBER | REVISION
 COMET-STL-00-00-DR-L-ZZZZ-91061 P07

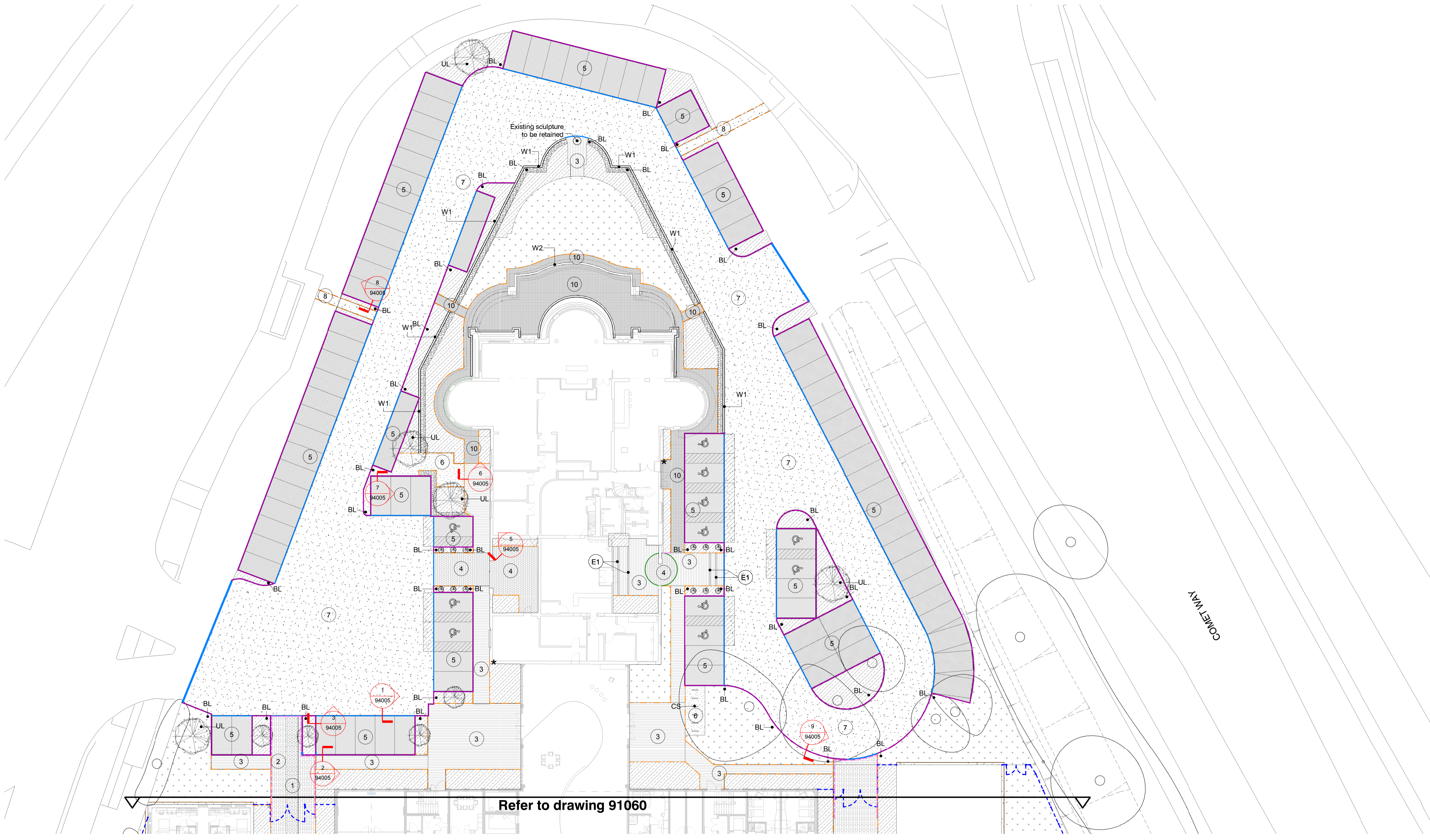

Refer to drawing 91060

PAVING AND EDGING

- 1 **Block paving**
Acheson+Glover, 'Plaza' range, Salt colour, 400x200x80mm, laid in stretcher bond, or similar approved
- 2 **Block paving mix**
Acheson+Glover, 'Plaza' range, in stretcher bond (random length) mixture of colours: 30% Kardemom, 30% Lakrids, 30% Pepper; sizes: 600x200x80mm/400x200x80mm/200x200x80mm, or similar approved
- 3 **Natural stone paving**
Yorkstone, riven surface finish up to 75mm depth, 450mm width x 300/450/600/750/900mm lengths to match existing flags and to Landscape Architect's approval. Build-up for pedestrian traffic to engineers specification and detail.
- 4 **Natural Yorkstone setts**
100x100x75mm, tumbled finish or similar approved. Build up for vehicular traffic to engineers specification and detail
- 5 **Permeable block paving**
Acheson+Glover, 'Plaza' range, pepper colour, 200x100x80mm, or similar approved. Gravel jointing to engineers specifications. Build ups for vehicular traffic to engineers detail and specification
- 6 **Permeable resin bound gravel**
Ayton Products, Clearmac in Brittany Danish colour. Build up for pedestrian traffic to engineers detail and specification
- 7 **Asphalt surfacing to vehicular areas**
Build ups for vehicular traffic to engineers detail and specification
- 8 **Asphalt surfacing to pedestrian areas**
Build ups for pedestrian traffic to engineers detail and specification
- 9 **Gravel soakaway strip**
Gravel soakaway strip in between new buildings and lawns. 75mm depth, 20mm nom. dia. Golden Gravel surface course on top of geotextile membrane. Underlying 325mm build-up to Engineer's specification
- 10 **Existing stone paving**
To be carefully removed, cleaned and relaid. Build ups to engineers details. Any damaged stone, similar stone to be used.
- 11 **Grass paving grid**
Bodpave 85, supplied by Terram. Grass seeding. 500x500x50mm interlocking grids. Castellated 67mm plaque & 46mm round-shaped, flexible cell combination.
- 12 **Concrete base pad**
To bin store zone. To Engineers specifications. Drainage to be incorporated.
- E1 **Banding**
300mm wide Yorkstone banding detail, 3 rows of 100x100x75mm depth tumbled. Stacker Bond. Build ups to Engineers detail and specification
- Timber edge**
Jacksons Fencing 150x25x2400mm, treated gravel board; fixed to pointed timber stakes 50x50x450mm.
- Pin Kerb laid flush**
Acheson+Glover, Terrakerb, 150x50x915mm (bespoke to order), silver grey colour or similar approved
- Wide kerb laid flush**
Acheson+Glover, Terrakerb, 255x203x900mm, silver grey colour or similar approved
- Wide kerb upstand**
Acheson+Glover, Terrakerb, 255x203x900mm, 125mm up stand, silver grey colour or similar approved
- Metal edging**
Kinley Systems, AluExcel, Aluminium metal edging system set flush with hard surfacing, depth to engineers details.
- Vehicle Access**
Zone of paving where build ups require heavy duty vehicular construction to Engineers details.

FURNITURE

- LB **Litter Bin**
Land-Mark Landscaping Systems, Recto hooded steel letter bin. 550x300x1000mm, 100Lts capacity. Model LMLC01/07/011 in orange brown colour (RAL 8023). Surface mounted via fixing holes in base.
- B **Steel Bollard**
Land-Mark Landscaping Systems, Stainless steel model: LMSS05/89/120. 89mm diameter, 1200mm length, 900mm above ground. Brush stain finish, fixed below ground in to foundations.
- B1 **Timber slatted bench**
Land-Mark Landscaping Systems, Madrid bench 1740x450x450mm Model: LMSE106/47/001
Timber: Softwood slats
Framework: Mild steel plate in orange brown colour (RAL 8023)
- B2 **Picnic tables and benches**
Land-Mark Landscaping Systems, Madrid picnic set Model: LMSE106/38/1015
Table: 1740x750x740mm
Timber: Untreated hardwood timber
Benches as per B1 in orange brown colour (RAL 8023)
- B3 **Sun Lounger**
Land-Mark Landscaping Systems, Madrid lounge seat 1510x1350x875mm, Seat height: 350mm Model: LMSE106/47/050
Timber: Softwood slats
Steel plate framework in orange brown colour (RAL 8023)
- TT **Table tennis table**
Home leisure direct, Cornilleau Proline 510M Outdoor Static Table Tennis Table
- 4m width x 8m length Canopy**
Supplied and designed by Land-mark Wales in accordance with Landscape Architect drawings.
- CS **Cycle shelter**
Broxap, Sherwood cycle shelter with 2 sides. 2no cycle shelters with 13 stands each Sheffield Cycle Stands (32no. stands in total) Galvanised. Refer to drawing 94004 for details
- CS **Cycle Stand**
Sheffield cycle stands, stainless steel, roof fixed. Adult sized. Supplied by Broxap.
New brick wall 400mm height x 215mm wide. Brick work and mortar joints to match facade of listed building.
- W1 **Existing wall to be rebuilt as per Building Surveyor's specification, 400mm height x 215mm wide. Brick work and mortar joints to match facade of listed building.**
- W2 **Existing wall to be rebuilt as per Building Surveyor's specification, 400mm height x 215mm wide. Brick work and mortar joints to match facade of listed building.**
- F1 **2.4m high secure decorative metal fence with matching access gates. Modena range by Lang+Fulton. Double leaf gates at 3.8m wide, single leaf gates at 1.2m wide. RAL 7024 Graphite Grey Colour. 'Modena' range by Long+Folton.**
- F2 **1.5m high secure decorative metal fence fixed to building plinth to Structural Engineer's specification. Double-leaf gates at 3.8m wide, single leaf gates at 1.2m wide. RAL 7024 Graphite Grey Colour. 'Modena' range by Long+Folton.**
- * **External Tap**

LIGHTING FEATURES

- LP **Lamp Post**
- BL **Bollard Light**
- UL **Uplight**
- DL **Down Light**
- SL **Security Light**

Note:
 Light features by HOLOPHANE or similar approved. For details refer to CCTV locations and specification. Also refer to M&E drawings.

SOFT LANDSCAPE

- UL **Trees proposed**
- UL **Existing trees retained**
- UL **Proposed grass lawn**
- UL **Shrub and perennial planting**
- UL **Grasscrete**
Grassgrid supplied by Charcon. Grass seeding. 366x274x100mm interlocking sizes.

