

Welwyn Garden City

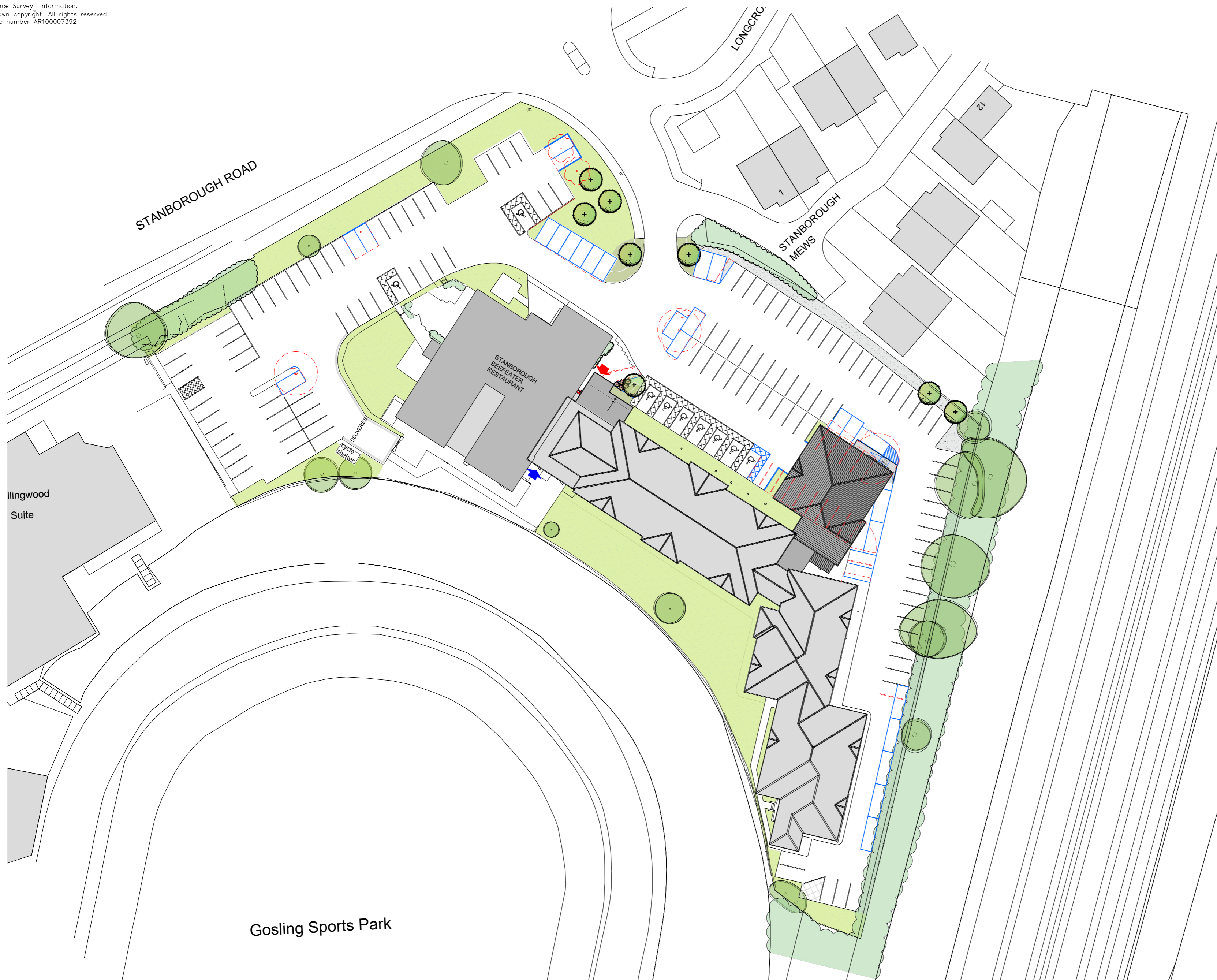

SITE AREA			0.95 Ha
HOTEL	EXISTING	PROPOSED	INCREASE / DECREASE
No. of Storeys	3	3	-
Bedrooms	120	144	+24

CAR PARKING	EXISTING	PROPOSED	INCREASE / DECREASE
Regular	143	153	10
Disabled	8	9	1
TOTAL	151	162	11
Cycle Parking	8	8	-

NOTE: The extension drainage is to connect to the existing Premier Inn hotel foul drainage system.

The new landscaping is to be the same as the current landscape planting strategy.

- KEY:**
- Proposed Car parking/kerbs
 - Existing Car parking kerbs removed
 - Existing tree to be removed
 - Existing shrub planting to be removed
 - Existing tree to be retained
 - Existing other vegetation to be retained
 - Proposed tree planting
 - Existing and proposed grass
 - Proposed shrub / groundcover planting
 - Proposed specimen shrub
 - Existing gravel

For Detail Landscaping proposal refer to :
 Indigo Landscape Architects Ltd.
 Drawing No: 780-SW-01 B

CLIENT

GENERAL NOTES
 All drawings are subject to full site survey. All dimensions are to be checked on site.

SCALE

NORTH

REV.	DESCRIPTION	DATE	INITIALS

ISSUE

PLANNING

CHQ Architects Ltd
 The Millings, 44 Whitehorse Street,
 Baldock, Hertfordshire SG7 6GQ
 Telephone: (01462) 895110
 Email: design@chq-architects.co.uk
 www.chq-architects.co.uk

PROJECT
 Premier Inn
 Stanborough Road
 Welwyn Garden City
 Hertfordshire
 AL8 6DQ

DRAWING

Proposed Site Plan

DATE	Jan 2018	DRAWN	FA
SCALE	1:500@A2	CHECKED	MRA

CHQ.15.11456-PL05