

**NOTES**

This drawing is copyright. All rights reserved.  
 This drawing is not to be scaled: work from figured dimensions only.  
 Adam Burgess Architect is not responsible for Boundary information - All boundaries are to be confirmed with Land Registry prior to start on site.  
 This is not a construction drawing.  
 This drawing is for a Planning Application only.

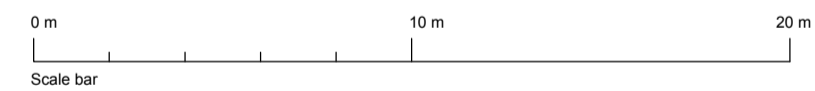
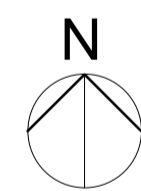
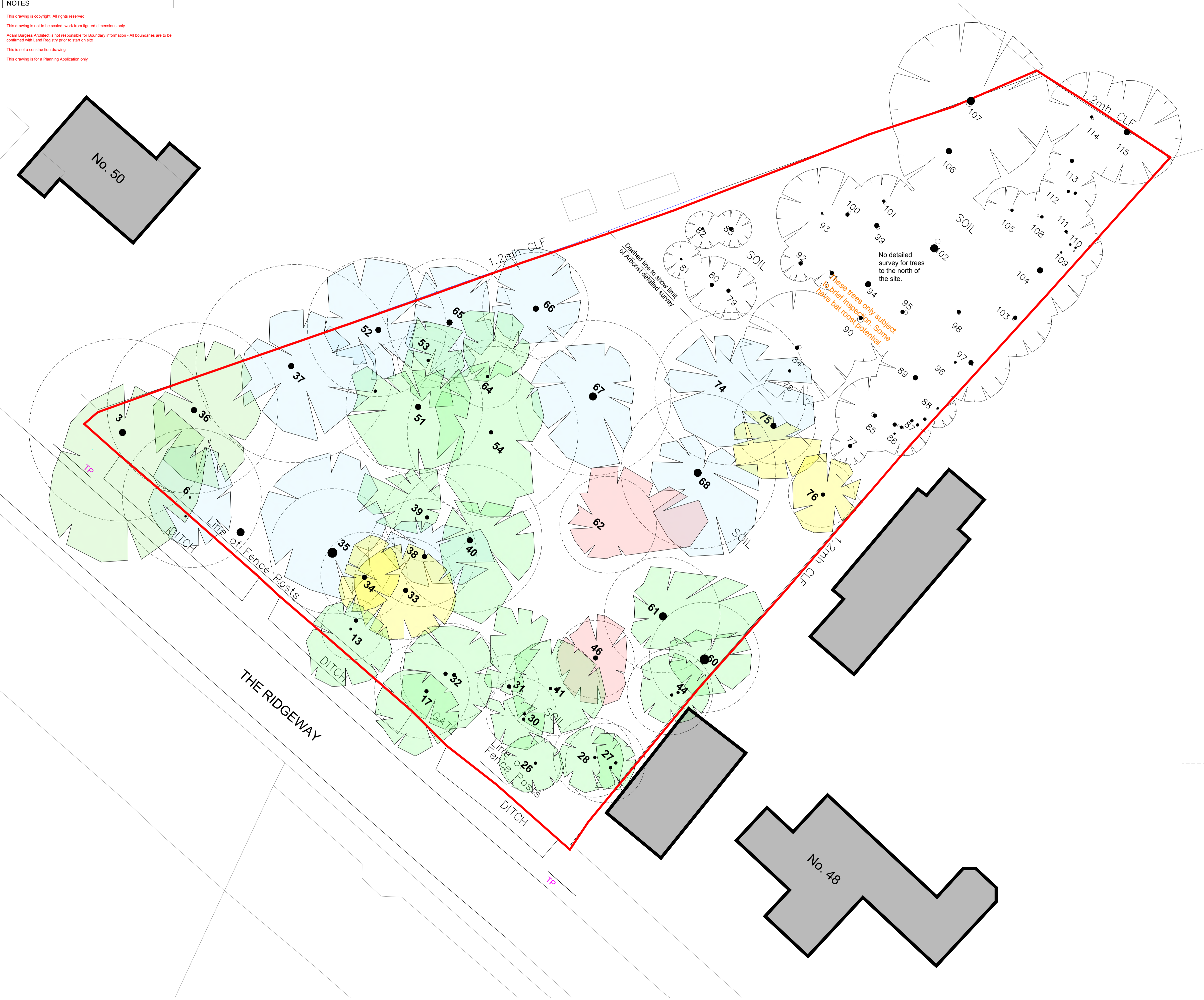
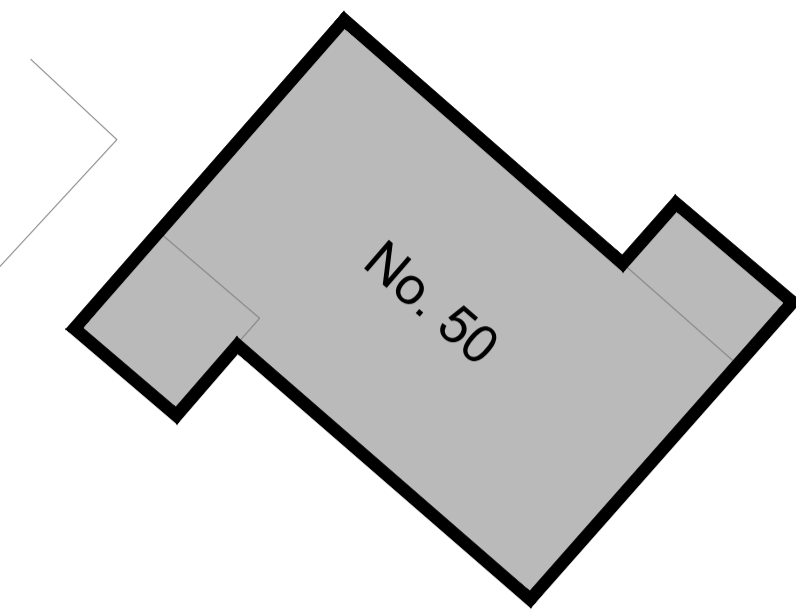

- KEY:**
- Root Protection Area (RPA)
  - Proposed removals
  - Tree canopy - A
  - Tree canopy - B
  - Tree canopy - C
  - Tree canopy - Hornbeams

**Note:**  
 This plan shows a hypothetical situation whereby all proposed removals have been undertaken as per drawing 086PL-12. Additional proposals for removals of trees over and above those initially outlined and / or recommended by the Arborist are shown here accommodate the proposed development - only where absolutely necessary and as advised by the Arborist and Ecological consultants as part of a wider design to enhance biodiversity of the site.

Revisions

--	--	--

**Adam Burgess Architect**  
 3F1, 4 Wellington Street, Edinburgh, EH7 5ED  
 +44 (0) 7881 942 066 mail@adamburgessarchitect.co.uk

Project Site at Cuffley

Title Tree Canopies

Client Mr P Bowler

Drawing Number **086 PL 14**

Scale 1:200 @ A1	Date February 2022	Revision
Drawn	Checked	-